

ROUTE NO.	SECTION	COUNTY	TOTAL SHEETS	SHEET NO.
FAI 74	*	CHAMPAIGN	122	56
FED. ROAD DIST. NO. 7		ILLINOIS	FED. AID PROJECT	

★ (10-92-8HB-1)BR

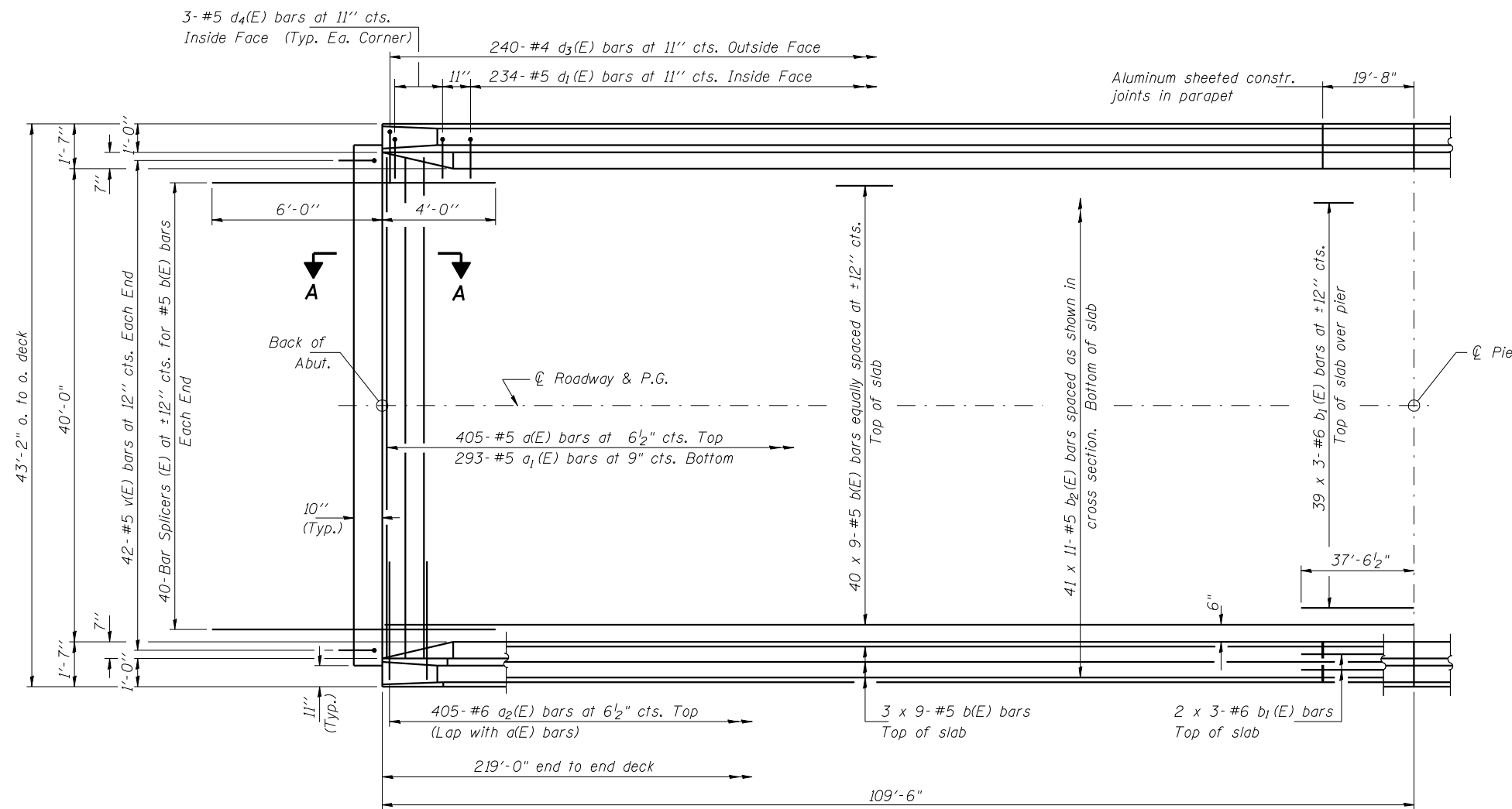

HALF PLAN

MIN. BAR LAP
#5 bar = 1'-8"
#6 bar = 2'-0"

- Notes: See Sheet 6 of 17 for superstructure details and Bill of Material.
Reinforcement bars designated (E) shall be epoxy coated.
Bars indicated thus 20 x 3-#5 etc. indicates 20 lines of bars with 3 lengths per line.
See Sheet 6 of 17 for parapet reinforcement.
See Sheet 9 of 17 for Section A-A.
See Sheet 13 of 17 for Bar Splicer Details.

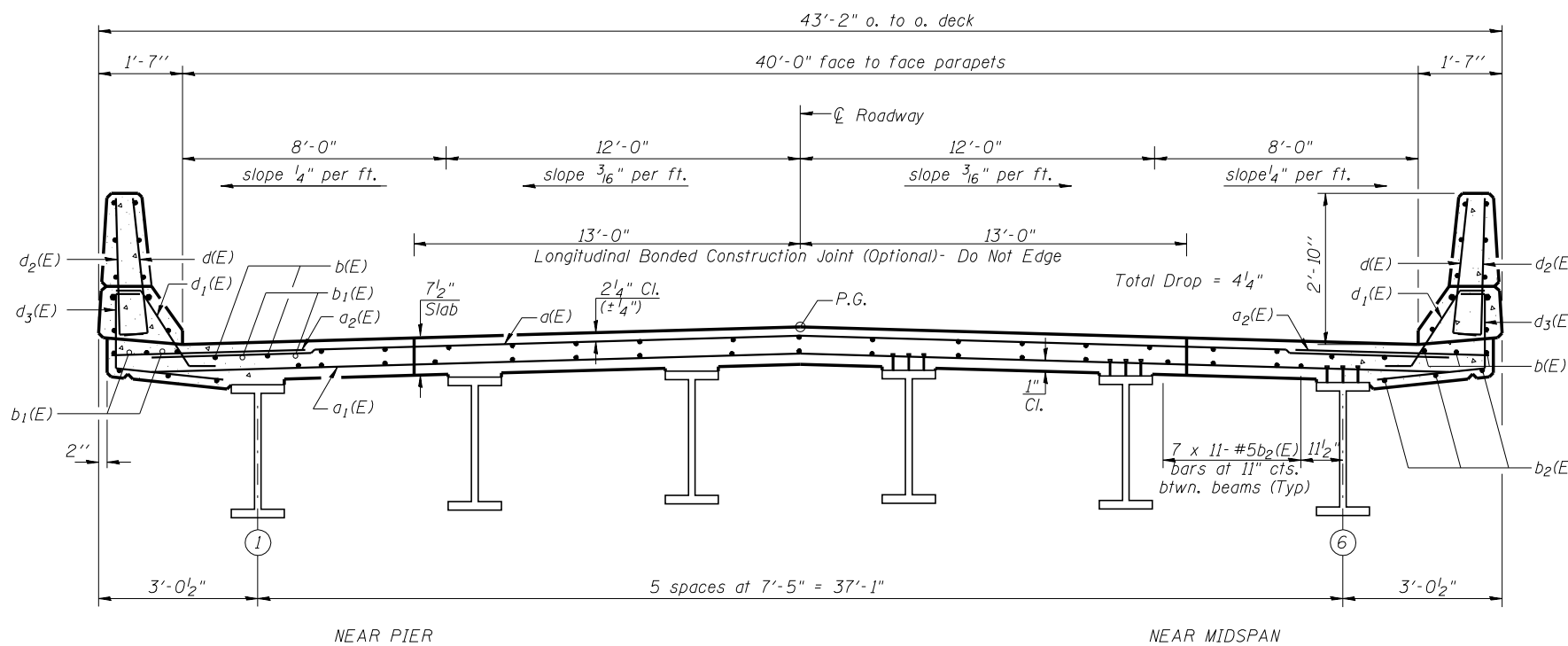

CROSS SECTION
(Looking South)

LIN ENGINEERING, LTD.
20 N. Chestnut
Chatham, Illinois 62629
(217) 483-4668
Fax (217) 483-4706
Designed By: MTH
Checked By: STD
Date: 11/02
Files: 0100277.DGN

REVISIONS	
NAME	DATE

ILLINOIS DEPARTMENT OF TRANSPORTATION
SUPERSTRUCTURE
FAS RTE 518 (IL 49S) & FAP RTE 836 (C.H.22)
OVER FAI RTE 74 (I-74)
SECTION (10-92-8HB-1) BR
CHAMPAIGN COUNTY
STA. 1000+88.67 (I-74)
STA. 50+00.00 (IL 49S & C.H. 22)
STRUCTURE NO. 010-0277