

ROUTE NO.	SECTION	COUNTY	TOTAL SHEETS	SHEET NO.	SHEET NO. 5 17 SHEETS
FAI 74	★	VERMILION	122	73	
FED. ROAD DIST. NO. 7	ILLINOIS	FED. AID PROJECT	★ (10-92-8HB-4)BR		

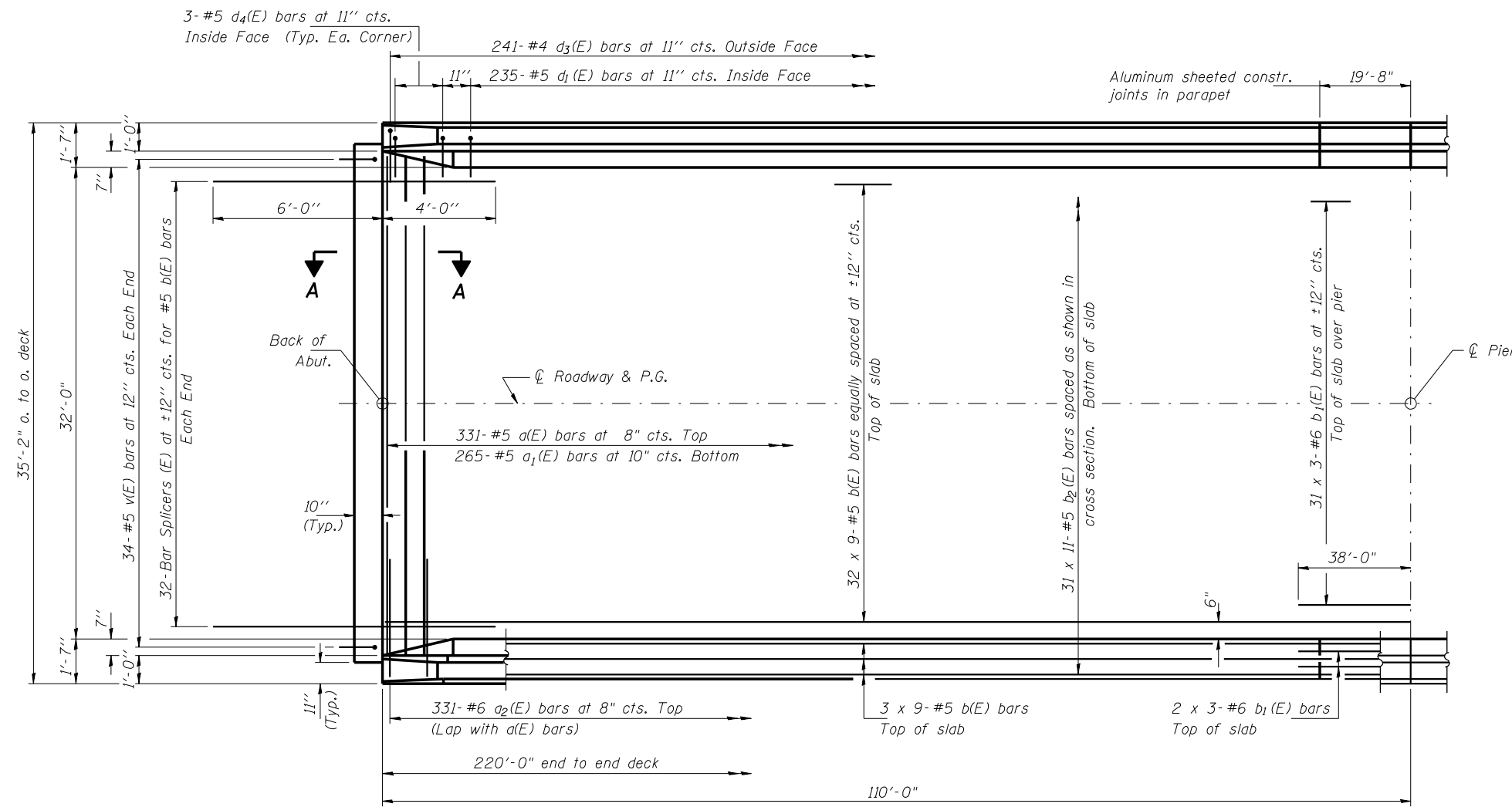

HALF PLAN

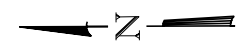

MIN. BAR LAP
 #5 bar = 1'-8"
 #6 bar = 2'-0"

- Notes: See Sheet 6 of 17 for superstructure details and Bill of Material.
 Reinforcement bars designated (E) shall be epoxy coated.
 Bars indicated thus 20 x 3-#5 etc. indicates 20 lines of bars with 3 lengths per line.
 See Sheet 6 of 17 for parapet reinforcement.
 See Sheet 9 of 17 for Section A-A.
 See Sheet 13 of 17 for Bar Splicer Details.

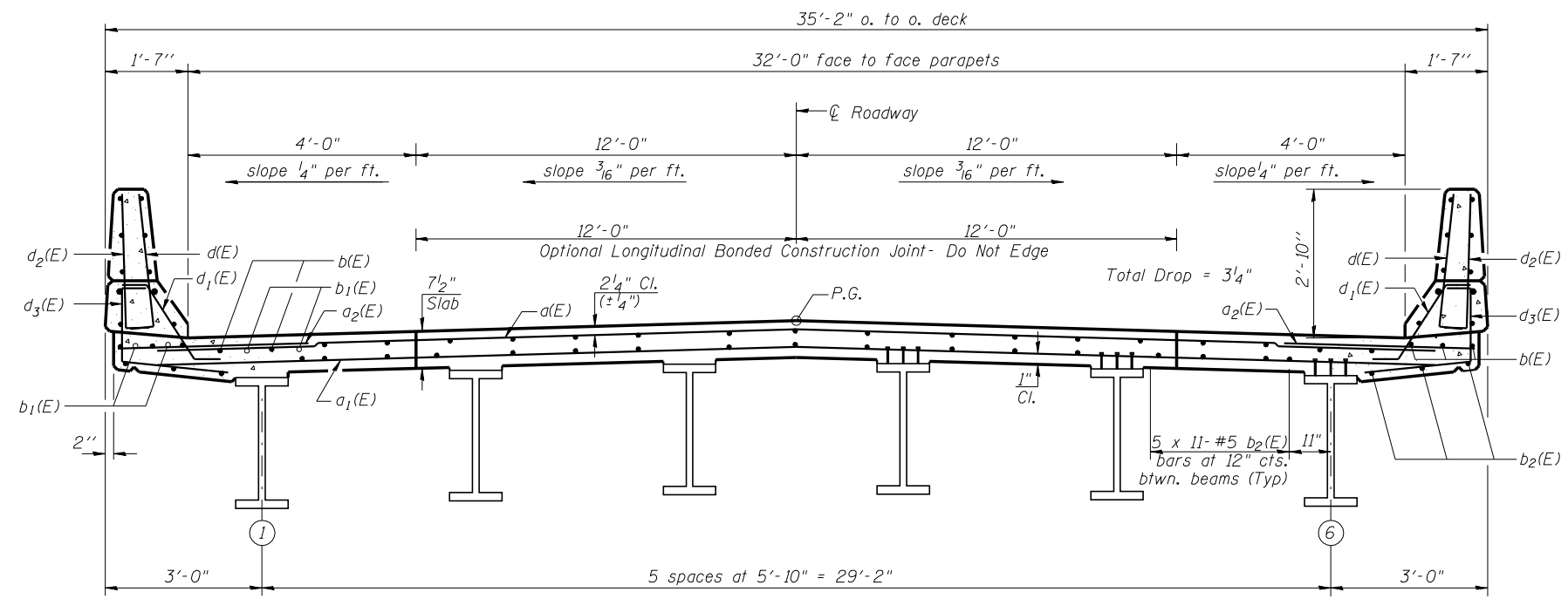

CROSS SECTION
 (Looking South)

LIN ENGINEERING, LTD.
 210 W. Chestnut
 Chatham, Illinois 62629
 (207) 483-4669
 Fax: (207) 483-4706
 Designed By: MTH
 Checked By: STD
 Drawn By: JMD
 Date: 11/02
 File: 0920203.DGN

REVISIONS	
NAME	DATE

ILLINOIS DEPARTMENT OF TRANSPORTATION
SUPERSTRUCTURE
 FAP ROUTE 840 (IL 49N)
 OVER FAI RTE 74 (I-74)
 SECTION (10-92-8HB-4) BR
 VERMILION COUNTY
 STA. 1160+20.53 (I-74)
 STA. 50+00.00 (IL 49N)
 STRUCTURE NO. 092-0203