

ORIGINAL SURVEY PLOTTED AREAS CHECKED
 SURVEY PLOTTED AREAS CHECKED
 DATE BY

FINAL SURVEY PLOTTED AREAS CHECKED
 SURVEY PLOTTED AREAS CHECKED
 DATE BY

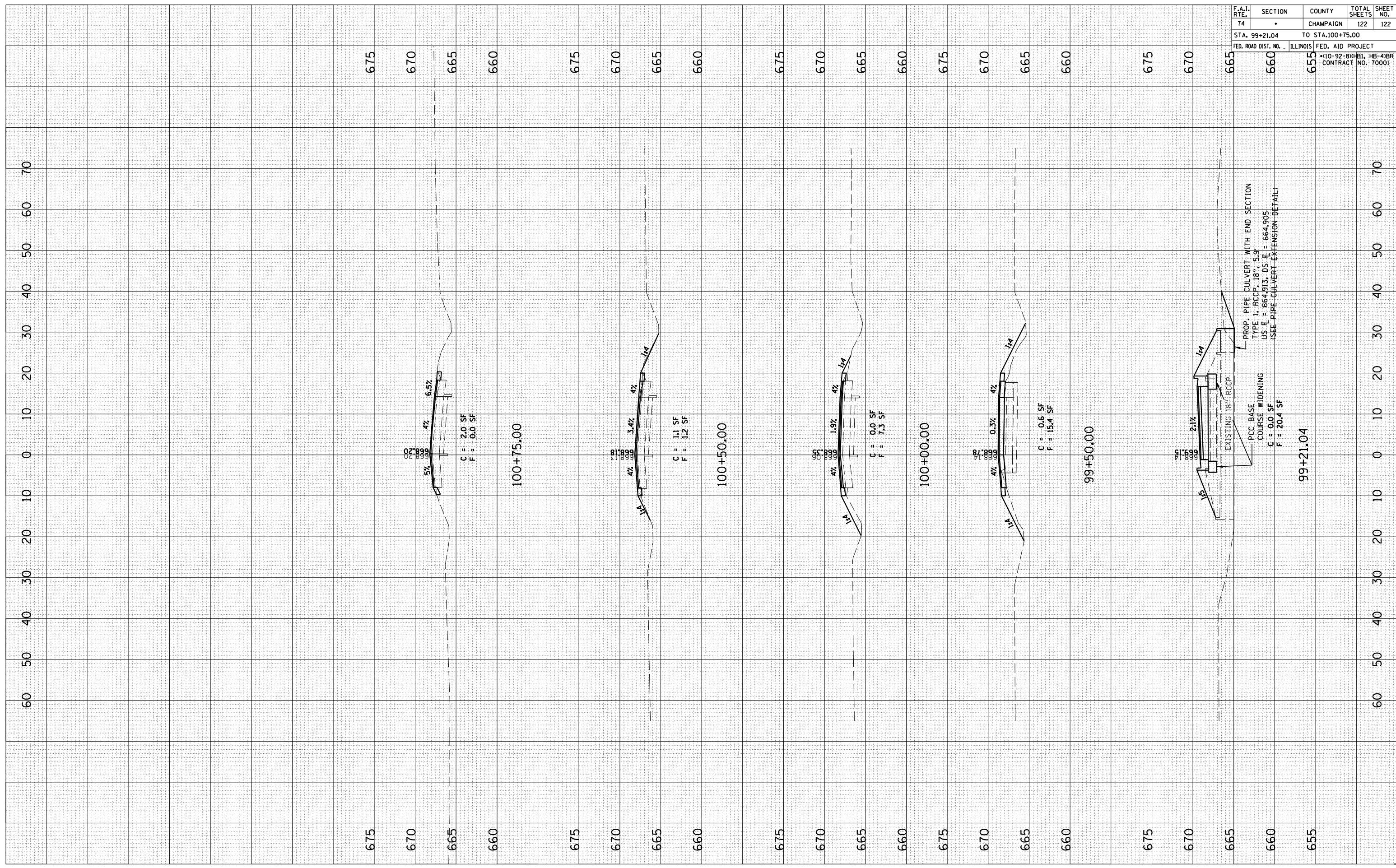

F.A.I. RTE.	SECTION	COUNTY	TOTAL SHEETS	SHEET NO.
74		CHAMPAIGN	122	122
STA. 99+21.04		TO STA. 100+75.00		
FED. ROAD DIST. NO. 1		ILLINOIS FED. AID PROJECT		
		+110-92-8X(HB1, HB-4)BR CONTRACT NO. 70001		

PROP. PIPE CULVERT WITH END SECTION
 TYPE 1, RCCP, 18", 5.9'
 US # = 664.913, DS # = 664.905
 (SEE PIPE CULVERT EXTENSION DETAIL)

PCC BASE COURSE WIDENING
 C = 0.0 SF
 F = 20.4 SF

EXISTING 18" RCCP

99+21.04

665

660

655