

CONTRACT NO. 83862

F.A.P. RTE.	SECTION	COUNTY	TOTAL SHEETS	SHEET NO.
361	06-00214-03-BR	KANE	52	09
STA.		TO STA.		
FED. ROAD DIST. NO. 1		ILLINOIS FED. AID PROJECT		

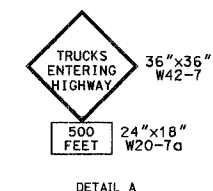
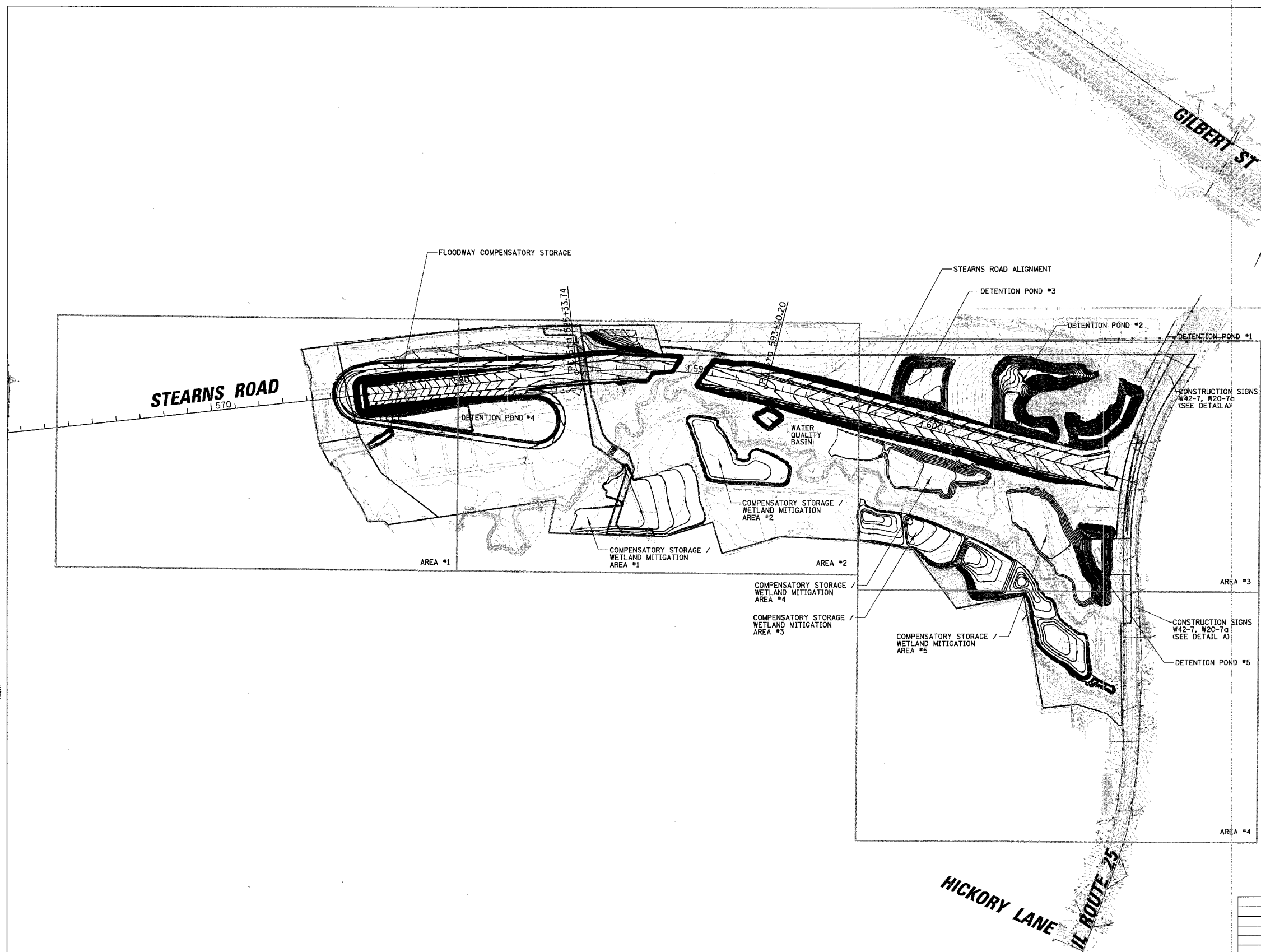
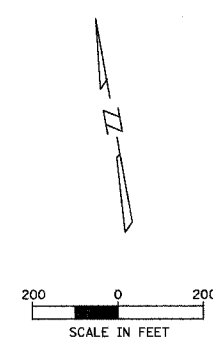

NOTE:
PLACE SIGNS PRIOR TO CONSTRUCTION.
SIGNS WILL BE SPACED 500' OR AS
DIRECTED BY THE ENGINEER.

REVISIONS	
NAME	DATE

ILLINOIS DEPARTMENT OF TRANSPORTATION

OVERALL SITE PLAN

SCALE: VERT. 1" = 200'
HORIZ. 1" = 200'

DATE: 9/13/2006

DRAWN BY: RCB
CHECKED BY: MEK

CHRISTOPHER B. BURKE ENGINEERING, LTD.
9575 W. Higgins Road, Suite 600
Rosemont, Illinois 60018
(847) 823-0500



PLOT DATE = 9/13/2006
FILE NAME = N:\kennecott\14710101\14710101\OVERALL.DWG
PLOT SCALE = 200' = 1" (VERT.)
USER NAME = RCB