

CONTRACT NO. 83862

F.A.P. RTE.	SECTION	COUNTY	TOTAL SHEETS	SHEET NO.
361	06-00214-03-BR	KANE	52	10
STA.		TO STA.		
FED. ROAD DIST. NO. 1   ILLINOIS FED. AID PROJECT				

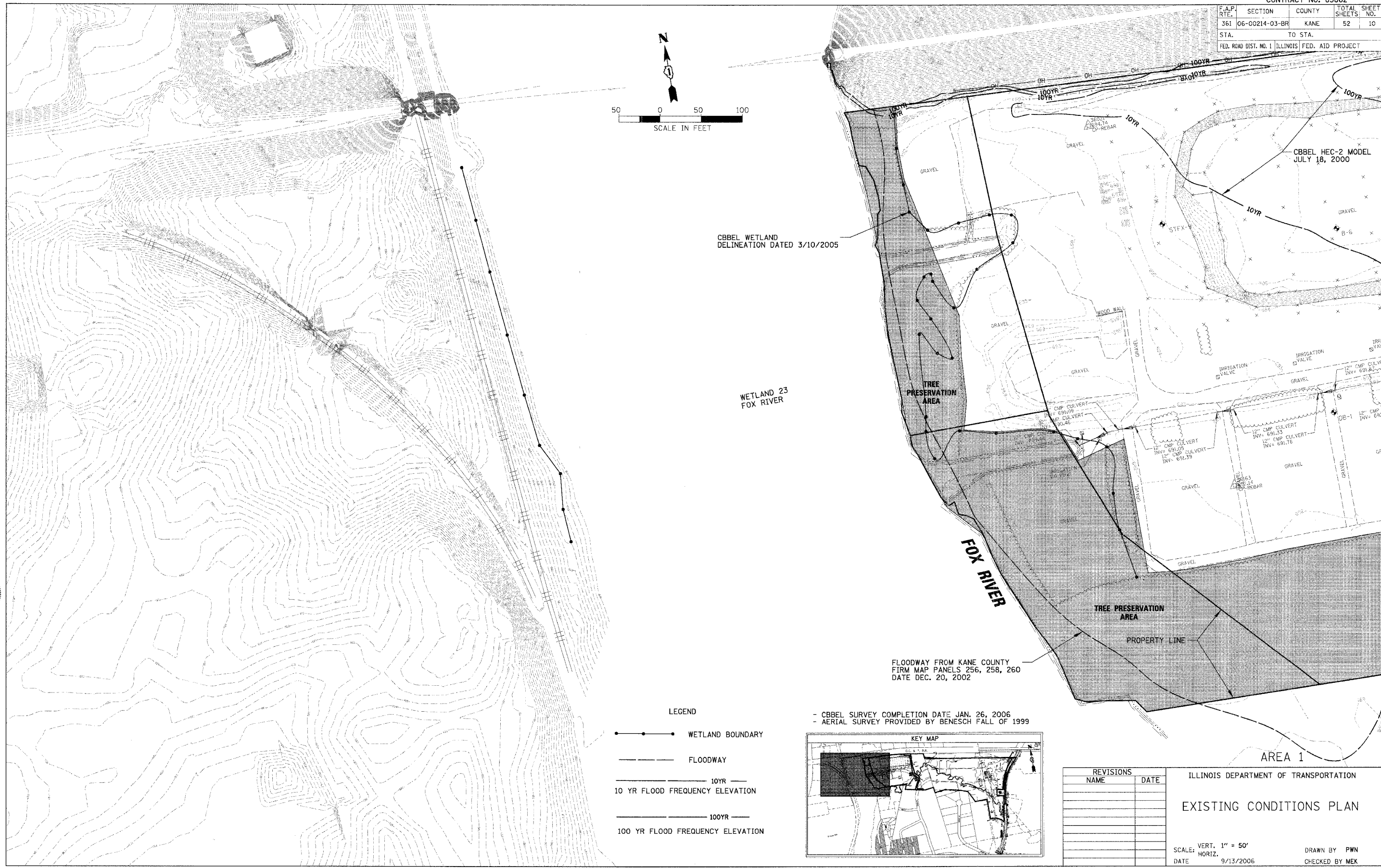
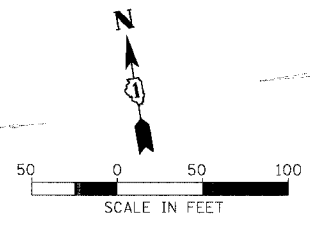

CBBEL WETLAND DELINEATION DATED 3/10/2005

WETLAND 23 FOX RIVER

FLOODWAY FROM KANE COUNTY FIRM MAP PANELS 256, 258, 260 DATE DEC. 20, 2002

LEGEND

- WETLAND BOUNDARY
- FLOODWAY
- 10YR 10 YR FLOOD FREQUENCY ELEVATION
- 100YR 100 YR FLOOD FREQUENCY ELEVATION

- CBBEL SURVEY COMPLETION DATE JAN. 26, 2006
- AERIAL SURVEY PROVIDED BY BENESCH FALL OF 1999

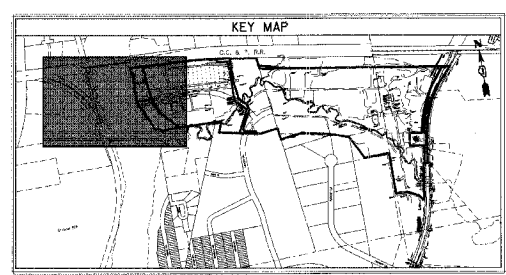

REVISIONS	
NAME	DATE

ILLINOIS DEPARTMENT OF TRANSPORTATION  
**EXISTING CONDITIONS PLAN**  
 SCALE: VERT. 1" = 50'  
 HORIZ. DATE 9/13/2006  
 DRAWN BY PWN  
 CHECKED BY MEK

CHRISTOPHER B. BURKE ENGINEERING, LTD.  
 9575 W. Higgins Road, Suite 600  
 Rosemont, Illinois 60018  
 (847) 823-0500



PLOT DATE = 9/13/2006  
 FILE NAME = N:\kane\county\8147\ORD\cvi\EA\8147\_LB.LIN  
 PLOT SCALE = 50' = 1" (VERT.)  
 USER NAME = BURKE