

CONTRACT NO. 83862

F.A.P. RTE.	SECTION	COUNTY	TOTAL SHEETS	SHEET NO.
361	06-00214-03-BR	KANE	52	13
STA.		TO STA.		
FED. ROAD DIST. NO. 1 ILLINOIS FED. AID PROJECT				

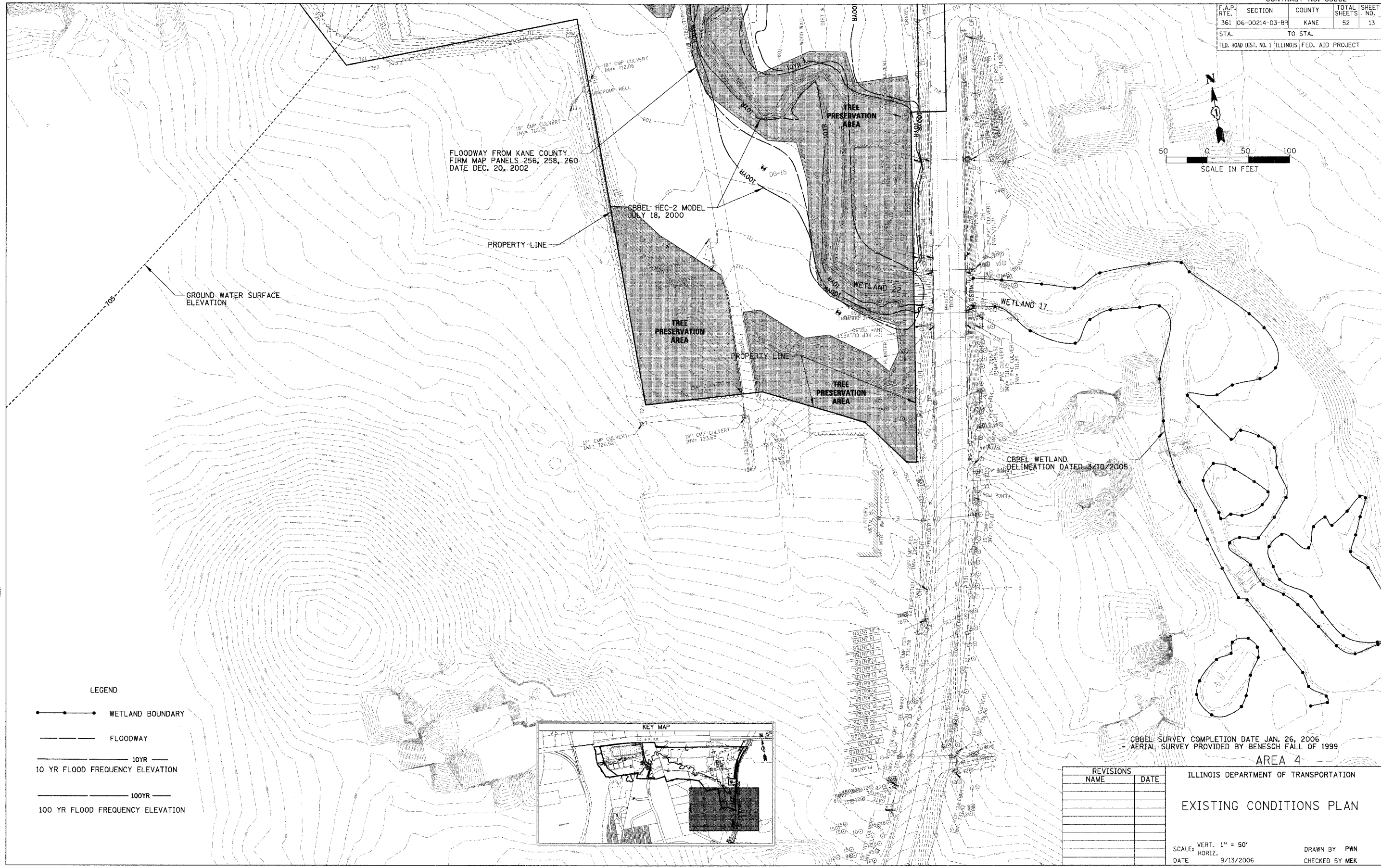
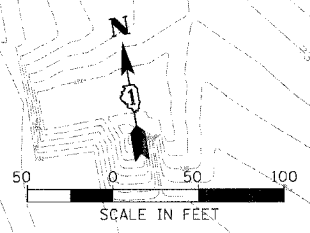

FLOODWAY FROM KANE COUNTY
FIRM MAP PANELS 256, 258, 260
DATE DEC. 20, 2002

CBBEL HEC-2 MODEL
JULY 18, 2000

GROUND WATER SURFACE
ELEVATION

PROPERTY LINE

TREE PRESERVATION AREA

TREE PRESERVATION AREA

TREE PRESERVATION AREA

CBBEL WETLAND
DELINEATION DATED 3/10/2005

CBBEL SURVEY COMPLETION DATE JAN. 26, 2006
AERIAL SURVEY PROVIDED BY BENESCH FALL OF 1999

AREA 4

ILLINOIS DEPARTMENT OF TRANSPORTATION

EXISTING CONDITIONS PLAN

SCALE: VERT. 1" = 50'
HORIZ. DATE 9/13/2006

DRAWN BY PWN
CHECKED BY MEK

REVISIONS	
NAME	DATE

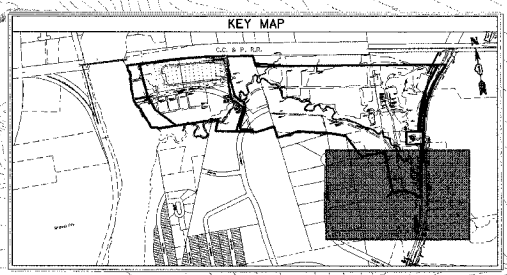

- LEGEND
- WETLAND BOUNDARY
 - FLOODWAY
 - 10YR —
10 YR FLOOD FREQUENCY ELEVATION
 - 100YR —
100 YR FLOOD FREQUENCY ELEVATION

CHRISTOPHER B. BURKE ENGINEERING, LTD.
9575 W. Higgins Road, Suite 600
Rosemont, Illinois 60018
(847) 823-0500



PLOT DATE = 9/13/2006
FILE NAME = N:\wv\mccurry\04716RD\CV\EX\B47184.PLN
PLOT SCALE = 1" = 50'
USER NAME = BUSEM