

CONTRACT NO. 83862

F.A.P. NO.	SECTION	COUNTY	TOTAL SHEETS	SHEET NO.
361	06-00214-03-BR	KANE	52	35
STA. TO STA.		FED. ROAD DIST. NO. 1 ILLINOIS FED. AID PROJECT		

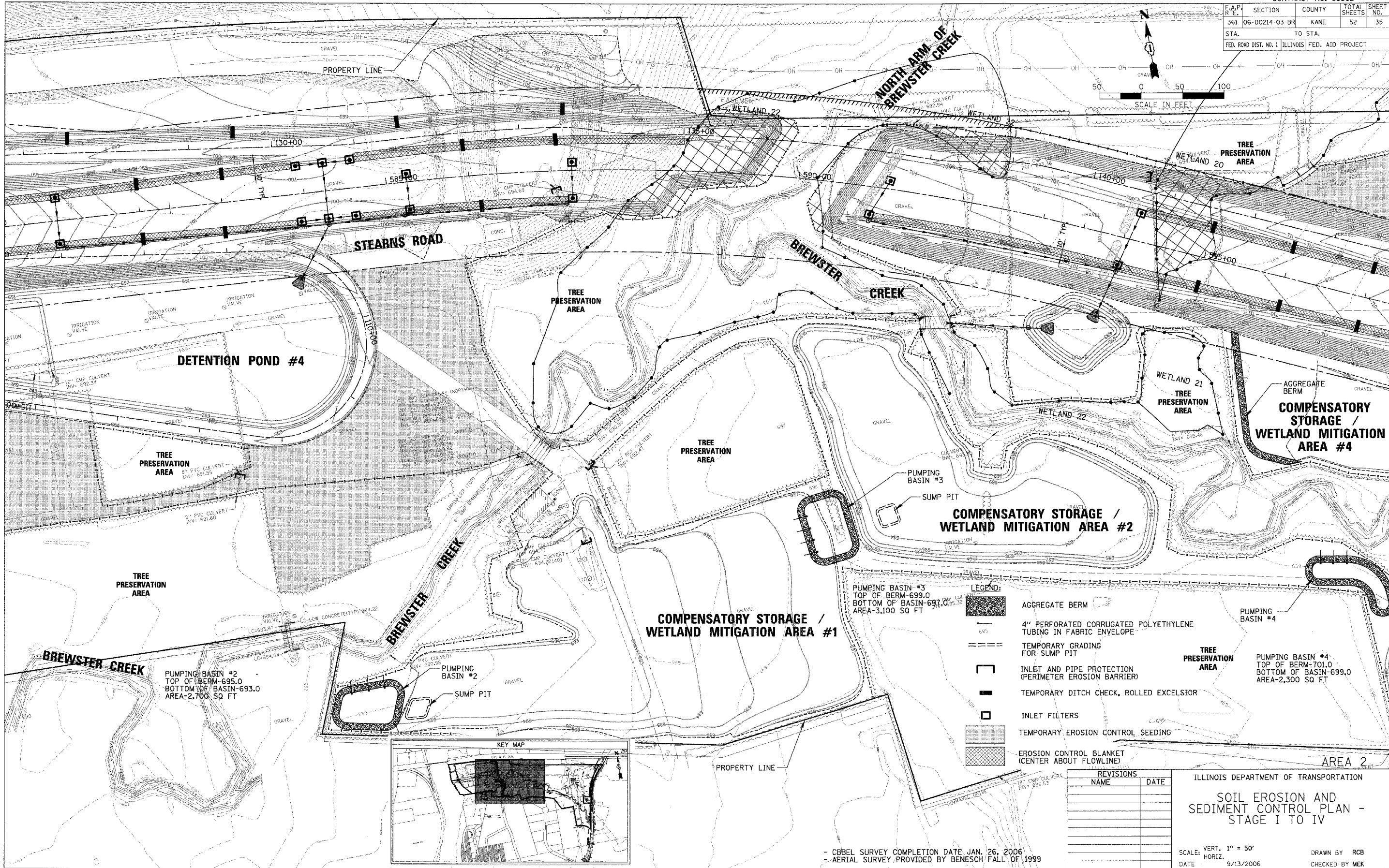

CHRISTOPHER B. BURKE ENGINEERING, LTD.
 9575 W. Higgins Road, Suite 600
 Rosemont, Illinois 60018
 (847) 823-0500

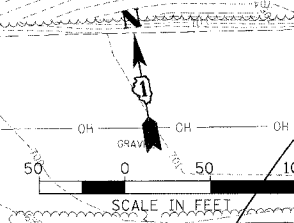

PLOT DATE = 9/13/2006
 PLOT NAME = C:\Users\cburke\My Documents\Projects\83862\83862.DWG
 USER NAME = CBURKE

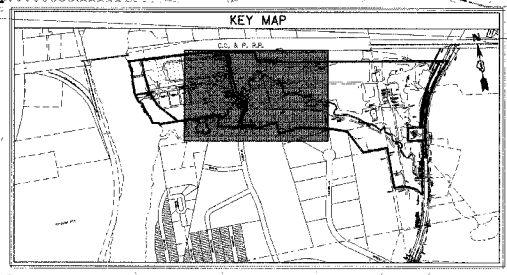

LEGEND:

- AGGREGATE BERM
- 4" PERFORATED CORRUGATED POLYETHYLENE TUBING IN FABRIC ENVELOPE
- TEMPORARY GRADING FOR SUMP PIT
- INLET AND PIPE PROTECTION (PERIMETER EROSION BARRIER)
- TEMPORARY DITCH CHECK, ROLLED EXCELSIOR
- INLET FILTERS
- TEMPORARY EROSION CONTROL SEEDING
- EROSION CONTROL BLANKET (CENTER ABOUT FLOWLINE)

PUMPING BASIN #2
 TOP OF BERM-695.0
 BOTTOM OF BASIN-693.0
 AREA-2,700 SQ FT

PUMPING BASIN #2
 TOP OF BERM-690.98
 BOTTOM OF BASIN-689.11

PUMPING BASIN #3
 TOP OF BERM-699.0
 BOTTOM OF BASIN-697.0
 AREA-3,100 SQ FT

PUMPING BASIN #3
 TOP OF BERM-699.0
 BOTTOM OF BASIN-697.0
 AREA-3,100 SQ FT

PUMPING BASIN #4
 TOP OF BERM-701.0
 BOTTOM OF BASIN-699.0
 AREA-2,300 SQ FT

REVISIONS	NAME	DATE

ILLINOIS DEPARTMENT OF TRANSPORTATION
 SOIL EROSION AND SEDIMENT CONTROL PLAN - STAGE I TO IV

- CBBEL SURVEY COMPLETION DATE, JAN. 26, 2006
 - AERIAL SURVEY PROVIDED BY BENESCH FALL OF 1999

SCALE: VERT. 1" = 50'
 HORIZ. DATE 9/13/2006
 DRAWN BY RCB
 CHECKED BY MEK