



DATE	
BY	
REVISION	
DATE	
BY	
REVISION	
DATE	
BY	
REVISION	

CHRISTOPHER B. BURKE ENGINEERING, LTD.  
 9575 W. Higgins Road, Suite 800  
 Rosemont, Illinois 60018  
 (847) 829-0500



DATE	
BY	
REVISION	
DATE	
BY	
REVISION	
DATE	
BY	
REVISION	

PLOT DATE = 9/13/2006  
 FILE NAME = #FILEL#  
 PLOT SCALE = #BY#  
 USER NAME = #USER#

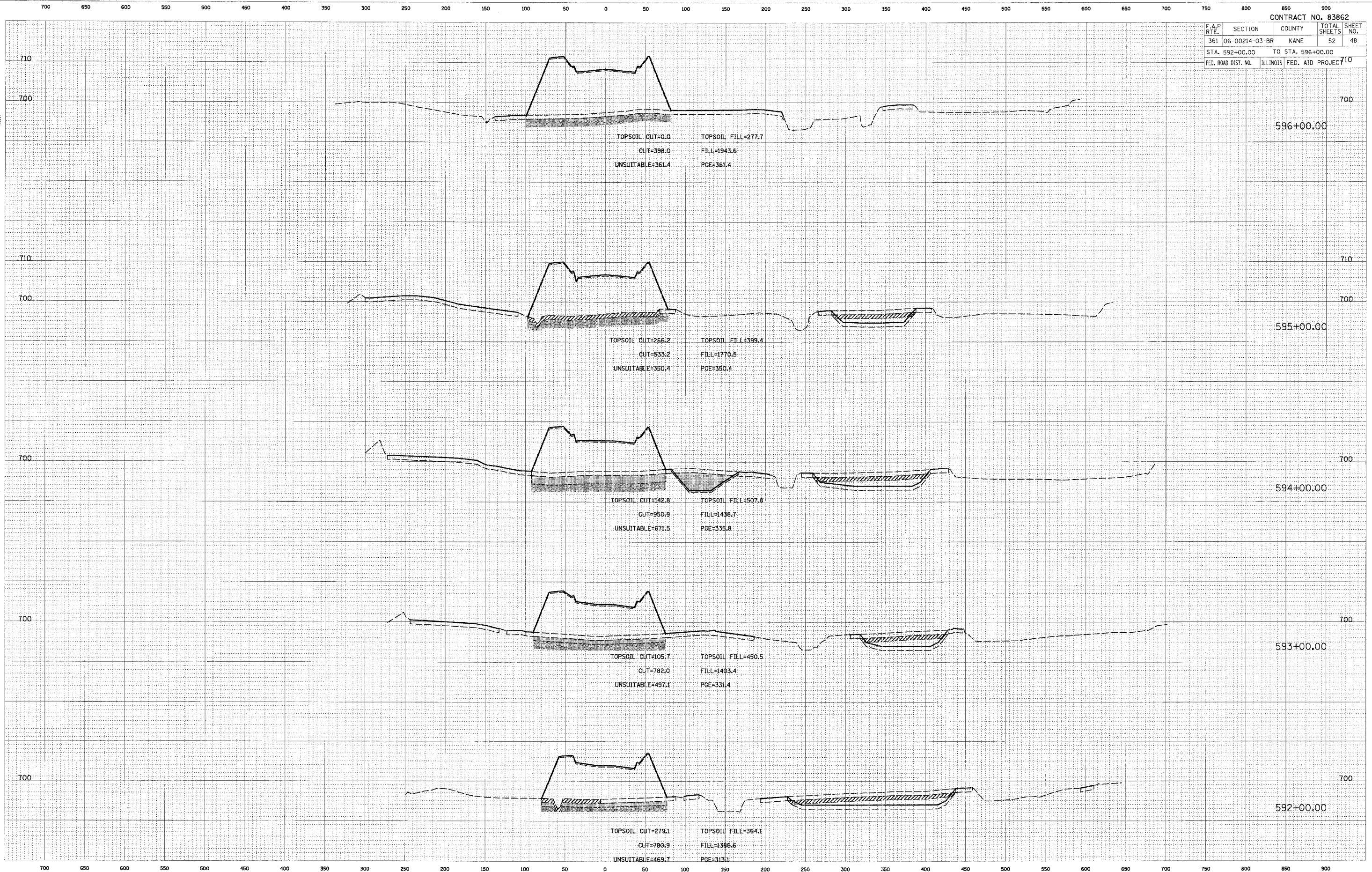

CONTRACT NO. 83862			
F.A.P. RTE.	SECTION	COUNTY	TOTAL SHEET NO.
361	06-00214-03-BR	KANE	52 48
STA. 592+00.00		TO STA. 596+00.00	
FED. ROAD DIST. NO.	ILLINOIS	FED. AID PROJECT	710