

PLANS FOR PROPOSED FEDERAL AID HIGHWAY

FOR INDEX OF SHEETS, SEE SHEET NO. 2

FOR A LIST OF APPLICABLE HIGHWAY
STANDARDS, SEE SHEET NO. 2

**FAU ROUTE 4120 (EDGEWATER DRIVE)
BLOOMINGDALE ROAD TO GLEN ELLYN ROAD
AND LAKEVIEW LANE
RESURFACING
SECTION NO.: 22-00078-00-RS
PROJECT NO.: 3X4G(999)
VILLAGE OF BLOOMINGDALE
DUPAGE COUNTY
JOB NO.: C-91-194-23**

F.A.U. RTE.	SECTION	COUNTY	TOTAL SHEETS	SHEET NO.
4120	22-00078-00-RS	DUPAGE	22	1
ILLINOIS			CONTRACT NO. 61J77	



FUNCTIONAL CLASSIFICATION

EDGEWATER DRIVE
MAJOR COLLECTOR
2020 ADT = 1700
POSTED SPEED LIMIT: 25 MPH

LAKEVIEW DRIVE
LOCAL ROAD
2020 ADT = NA
POSTED SPEED LIMIT: 25 MPH

LAKEVIEW LANE
RESURFACING BY
LOCAL AGENCY
STA. 10+00 TO
STA 18+80

BEGIN IMPROVEMENTS
STA. 100+00

END IMPROVEMENTS
STA. 153+27

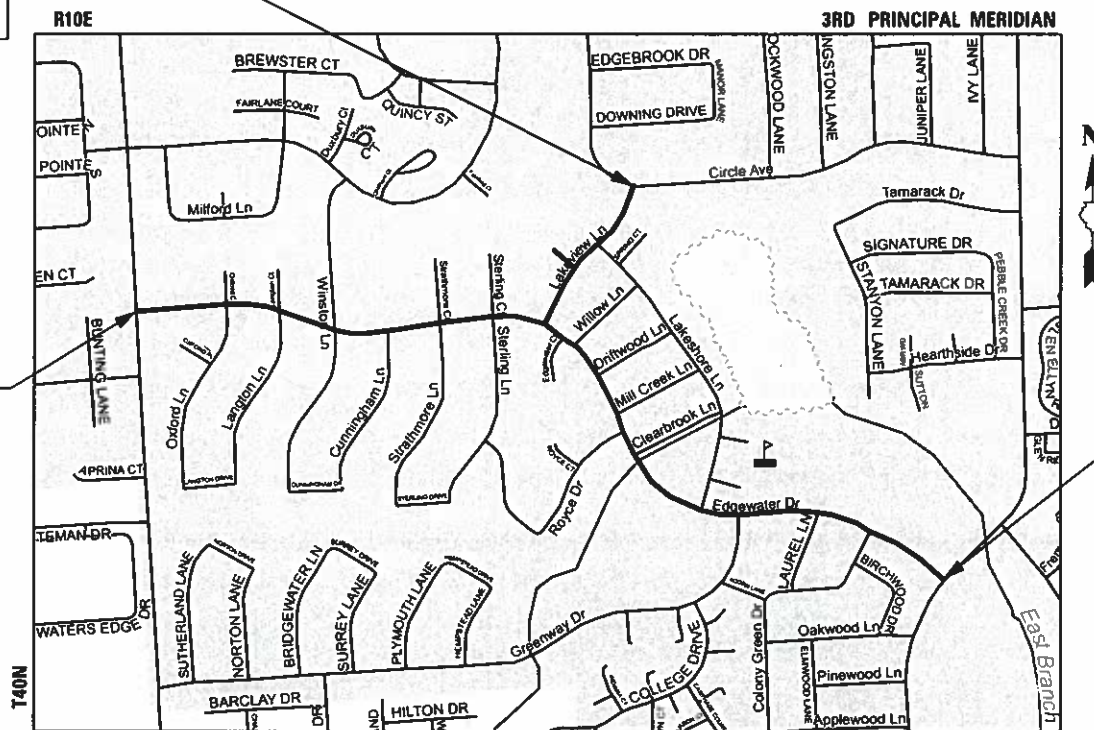

LOCATION MAP
N.T.S.
GROSS LENGTH = 6,207 FT. = 1.18 MILE
NET LENGTH = 6,207 FT. = 1.18 MILE

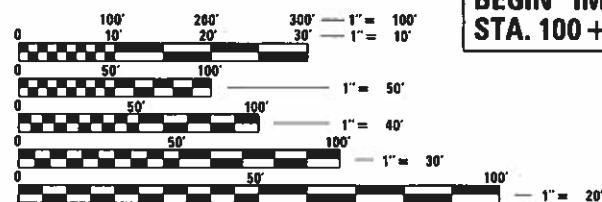

FULL SIZE PLANS HAVE BEEN PREPARED USING STANDARD
ENGINEERING SCALES. REDUCED SIZED PLANS WILL NOT
CONFORM TO STANDARD SCALES. IN MAKING MEASUREMENTS
ON REDUCED PLANS, THE ABOVE SCALES MAY BE USED.

J.U.L.I.E.
JOINT UTILITY LOCATION INFORMATION FOR EXCAVATION
1-800-892-0123
OR 811

FEDERAL AID PROGRAM ENGINEER: CARMEN E. RAMOS, P.E., SCHAMBURG, IL

CONTRACT NO. 61J77

STATE OF ILLINOIS DEPARTMENT OF TRANSPORTATION	
APPROVED	DATE 8-7-23
VILLAGE OF BLOOMINGDALE PUBLIC WORKS DIRECTOR	
PASSED	SEPTEMBER 7, 2023
DISTRICT 1 ENGINEER OF LOCAL ROADS AND STREETS	
RELEASING FOR BID BASED ON LIMITED REVIEW	SEPTEMBER 7, 2023
REGIONAL ENGINEER	

ORION C. GALEY
ILLINOIS REGISTRATION No. 062-050822
EXPIRATION DATE: 11/2023

CHRISTOPHER B. BURKE ENGINEERING, LTD.
18221 W. 159th Street, Suite 201
Lockport, Illinois 60441
(815) 770-2850
PROFESSIONAL DESIGN FIRM NO. 184-001175
EXPIRATION DATE: 04/30/23

**PRINTED BY THE AUTHORITY
OF THE STATE OF ILLINOIS**

INDEX OF SHEETS

1	COVER
2	GENERAL NOTES
3 – 6	SUMMARY OF QUANTITIES
7	TYPICAL SECTIONS
8 – 14	PROPOSED PLANS
14A	BLOOMINGDALE ROAD ADA DETAILS
15	CONSTRUCTION DETAILS
16-22	IDOT DISTRICT 1 DETAILS

HIGHWAY STANDARDS

000001-08	STANDARD SYMBOLS ABBREVIATIONS AND PATTERNS
280001-07	TEMPORARY EROSION CONTROL SYSTEMS
424001-11	PERPENDICULAR CURB RAMPS FOR SIDEWALKS
424006-05	DIAGONAL CURB RAMPS FOR SIDEWALKS
424011-04	CORNER PARALLEL CURB RAMPS FOR SIDEWALKS
424016-05	MID-BLOCK CURB RAMPS FOR SIDEWALKS
424021-06	DEPRESSED CORNER FOR SIDEWALKS
424026-03	ENTRANCE/ALLEY PEDESTRIAN CROSSINGS
424031-02	MEDIAN PEDESTRIAN CROSSINGS
442201-03	CLASS C AND D PATCHES
602001-02	CATCH BASIN TYPE A
602301-04	INLET TYPE A
602601-06	PRECAST REINFORCED CONCRETE FLAT SLAB TOP
602701-02	MANHOLE STEPS
604001-05	FRAME AND LIDS TYPE 1
604051-04	FRAME AND GRATE TYPE 11
606001-08	CONCRETE CURB TYPE B AND COMBINATION CONCRETE CURB AND GUTTER
701006-05	OFF-ROAD PERATIONS, 2L, 2W, 15' TO 24" FROM PAVEMENT EDGE
701101-05	OFF-ROAD OPERATIONS, MULTILANE, 15" TO 24" FROM PAVEMENT EDGE
701106-02	OFF ROAD OPERATIONS, MULTILANE, MORE THAN 15' AWAY
701301-04	LANE CLOSURE, 2L, 2W, SHORT TIME OPERATIONS
701311-03	LANE CLOSURE 2L, 2W MOVING OPERATION – DAY ONLY
701501-06	URBAN LANE CLOSURE, 2L, 2W UNDIVIDED
701701-10	URBAN LANE CLOSURE, MULTILANE INTERSECTION
701801-06	SIDEWALK, CORNER OR CROSSWALK CLOSURE
701901-08	TRAFFIC CONTROL DEVICES
780001-05	TYPICAL PAVEMENT MARKINGS
886001-01	DETECTOR LOOP INSTALLATIONS
886006-01	TYPICAL LAYOUT FOR DETECTION LOOPS

GENERAL NOTES

- ALL CONSTRUCTION SHALL BE DONE IN ACCORDANCE WITH THE DETAILS IN THE PLANS, THE SPECIAL PROVISIONS INCLUDED IN THE CONTRACT DOCUMENTS, THE "STANDARD SPECIFICATIONS FOR ROAD AND BRIDGE CONSTRUCTION IN ILLINOIS" (ADOPTED JANUARY 1, 2022), "SUPPLEMENTAL SPECIFICATIONS AND RECURRING SPECIAL PROVISIONS" (ADOPTED JANUARY 1, 2023), AND THE CURRENT EDITION OF THE FOLLOWING STATE OF ILLINOIS SPECIFICATIONS: THE "STANDARD SPECIFICATIONS FOR TRAFFIC CONTROL ITEMS", THE "MANUAL ON UNIFORM TRAFFIC CONTROL DEVICES FOR STREETS AND HIGHWAYS", THE "MANUAL OF TEST PROCEDURES FOR MATERIALS" AND THE "STANDARD SPECIFICATIONS FOR WATER AND SEWER MAIN CONSTRUCTION IN ILLINOIS."
- UTILITY LOCATIONS HAVE NOT ALL BEEN SHOWN ON THESE PLANS. THE CONTRACTOR SHALL HAVE THE RESPECTIVE UTILITY COMPANIES FIELD LOCATE ALL THEIR FACILITIES PRIOR TO BEGINNING CONSTRUCTION. THE CONTRACTOR SHALL ALSO VERIFY THE DEPTHS OF THE EXISTING UTILITIES IF NECESSARY. ANY RELOCATION OR LOWERING OF UTILITIES SHALL BE COORDINATED BY THE CONTRACTOR.
- THE CONTRACTOR SHALL BE RESPONSIBLE FOR THE PROTECTION OF ALL UNDERGROUND OR SURFACE UTILITIES EVEN THOUGH THEY MAY NOT BE SHOWN ON THE PLANS. ANY UTILITY THAT IS DAMAGED DURING CONSTRUCTION SHALL BE REPAIRED OR REPLACED AT THE CONTRACTOR'S EXPENSE TO THE SATISFACTION OF THE ENGINEER OR VILLAGE.
- THE CONTRACTOR SHALL NOTIFY THE VILLAGE PUBLIC WORKS AT LEAST 48 HOURS IN ADVANCE OF BEGINNING WORK TO OBTAIN VILLAGE UTILITY LOCATIONS AND SHALL COORDINATE ALL CONSTRUCTION OPERATIONS WITH THE ENGINEER.
- MATERIALS RESULTING FROM THE REMOVAL OF PAVEMENT, DRIVEWAYS, CURB AND GUTTER, HOT-MIX ASPHALT SURFACES, ETC. SHALL BE REMOVED AT THE END OF EACH DAY TO AN APPROVED SITE. IF IN THE JUDGEMENT OF THE VILLAGE, IT SHOULD BE NECESSARY TO REMOVE SUCH MATERIALS, THE VILLAGE WILL HAVE THE MATERIAL REMOVED AND THE CONTRACTOR WILL BE BILLED (CHARGED) ACCORDINGLY.
- IT WILL BE THE CONTRACTOR'S RESPONSIBILITY TO NOTIFY RESIDENTS OR BUSINESSES AND THE ENGINEER WHEN ACCESS TO DRIVEWAYS WILL BE TEMPORARILY CLOSED DUE TO CURB AND GUTTER AND/OR DRIVEWAY/SIDEWALK REPLACEMENT. THE CONTRACTOR SHALL DISTRIBUTE NOTICES PROVIDED BY THE VILLAGE. EVERY EFFORT SHALL BE MADE TO ACCOMMODATE ACCESS TO THESE PROPERTIES, INCLUDING KNOCKING ON DOORS WHEN DRIVEWAYS ARE ABOUT TO BE CLOSED. AT RESIDENCES WITH TWO DRIVEWAY APRONS, THE CONTRACTOR SHALL ONLY REMOVE AND REPLACE ONE APRON AT A TIME. THE SECOND APRON SHALL NOT BE REMOVED UNTIL THE FIRST APRON HAS BEEN REPLACED AND IS ACCESSIBLE.
- THE CONTRACTOR SHALL PROTECT AND CAREFULLY PRESERVE ALL SECTION OR SUBSECTION MONUMENTS OR PROPERTY OR REFERENCE MARKERS UNTIL THE OWNERS, THEIR AGENT OR AN AUTHORIZED SURVEYOR HAS WITNESSED OR OTHERWISE REFERENCED THEIR LOCATIONS.
- THE FINISHED HOT-MIX ASPHALT SURFACE SHALL BE CONSTRUCTED ¼" ABOVE THE GUTTER FLAG.
- OMITTED. INTENTIONALLY LEFT BLANK
- CONTRACTOR SHALL TAKE PRECAUTION BY PRESERVING EXISTING TREES WITHIN THE RIGHT OF WAY. IF ANY DAMAGE OCCURS, TREES SHALL BE REPLACED IN KIND PER ARTICLE 201.07 REPAIR OR REPLACEMENT OF EXISTING PLANT MATERIAL REQUIREMENTS STATED HEREIN.
- ALL NEW STORM STRUCTURES SHALL BE PROVIDED WITH 4" OF CONCRETE RINGS TO ALLOW ADJUSTMENT IN THE FIELD.
- DURING INSTALLATION OF STORM SEWERS, THE CONTRACT SHALL MAKE EVERY EFFORT TO AVOID RIDING THE TIRE (TRACK OF THE MACHINE) OVER THE CURB AND GUTTER. ANY DAMAGE TO THE CURB AND GUTTER RESULTING FROM THIS ACTION SHALL BE REPLACED BY THE CONTRACTOR AT NO ADDITIONAL COST TO THE VILLAGE.
- ALL STORM SEWER STRUCTURE HOLES FOR SEWERS SHALL BE CUT APPROPRIATELY. EXCESSIVE HOLES SHALL RESULT IN REJECTION OF THE STORM STRUCTURE.
- NO ARTIFICIAL KICK-BACKS IN THE CURB AND GUTTER AROUND STREET INLET GRATES UNLESS INDICATED BY THE VILLAGE.
- ALL REPLACED FRAMES AND GRATES SHALL BE SALVAGED AND DELIVERED TO THE VILLAGE PUBLIC WORKS DEPARTMENT.

16. CONTRACTOR IS EXPECTED TO BEGIN STORM SEWER INSTALLATION PRIOR TO ANY PAVING WORK, INCLUDING MILLING. ANY ALTERNATIVE SEQUENCING MUST BE PRE-APPROVED BY THE VILLAGE.

17. THE CONTRACTOR MUST GET APPROVAL FROM THE VILLAGE PRIOR TO BREAKING AWAY FROM AN UNCOMPLETED AREA TO START ON A NEW PROJECT AREA. GENERALLY, THE CONTRACTOR SHALL BE SUBSTANTIALLY COMPLETE WITH AN AREA BEFORE MOVING TO ANOTHER AREA. NO ADDITIONAL COMPENSATION WILL BE MADE FOR ADDITIONAL MOBILIZATIONS. THIS PERTAINS TO MOBILIZATIONS FOR THE GENERAL CONTRACTOR AS WELL AS ALL SUBCONTRACTORS. A SEQUENCE OF THE AREAS TO BE REHABILITATED IN THE CONTRACT SHALL BE PROVIDED BY THE CONTRACTOR AT THE PRECONSTRUCTION MEETING ALONG WITH AN ANTICIPATED CONSTRUCTION SCHEDULE FOR EACH AREA.

18. CONTRACTOR TO VERIFY MINIMUM PIPE SLOPE OF POSITIVE DRAINAGE IS ACHIEVED ON ALL PROPOSED STORM SEWERS.

COMMITMENTS

NO COMMITMENTS WERE MADE

DUPAGE COUNTY HIGHWAY PERMIT REQUIREMENTS

- THE TRAFFIC SIGNAL DETECTOR LOOPS ON BLOOMINGDALE DR. MUST BE INSTALLED IN THE HMA BINDER COURSE BY AN IDOT PRE-QUALIFIED ELECTRICAL CONTRACTOR.
- THE ELECTRICAL CONTRACTOR MUST SUBMIT A CATALOG CUT OF THE TRAFFIC SIGNAL DETECTOR WIRE TO THE COUNTY FOR REVIEW/APPROVAL PRIOR TO THE INSTALLATIONS.
- PLEASE CONTACT MS. MARYANNE SIOSON, DUPAGE COUNTY'S PROJECT ENGINEER AT (630) 407-6908 (48 HRS. IN ADVANCE) TO INSPECT THE TRAFFIC SIGNAL DETECTOR LOOP LAYOUT PRIOR TO INSTALLATIONS.
- THE GENERAL CONTRACTOR SHALL PROVIDE BONDING IN THE AMOUNT OF 110% OF COST OF THE PROJECT WITHIN DPC RIGHT-OF-WAY. THE ENGINEER SHALL PROVIDE A COST ESTIMATE OR EXECUTED CONTRACT TO SUBSTANTIATE THE AMOUNT FOR THE COUNTY'S APPROVAL PRIOR TO SUBMITTING A BOND. INSTRUCTIONS AND FORMS CAN BE FOUND ON THE DUPAGE COUNTY WEBSITE AT WWW.DUPAGECOUNTY.GOV THE ORIGINAL EXECUTED HIGHWAY PERMIT BOND (HARD COPY) IS REQUIRED PRIOR TO PERMIT ISSUANCE.
- THE GENERAL CONTRACTOR MUST HAVE CURRENT INSURANCE ON FILE WITH THE DIVISION OF TRANSPORTATION INCLUDING ALL LIABILITY ENDORSEMENTS AND CANCELLATION RIDER TO THE POLICY. INSURANCE REQUIREMENTS CAN BE FOUND ON THE DUPAGE COUNTY WEBSITE AT WWW.DUPAGECOUNTY.GOV IF YOU HAVE ANY QUESTIONS REGARDING YOUR INSURANCE, CONTACT MS. CHRISTINE BENTLEY, ADMINISTRATIVE SPECIALIST AT 630/407-6919 OR VIA E-MAIL CHRISTINE.BENTLEY@DUPAGECO.ORG
- THE CONTRACTOR SHALL PROVIDE A SEPARATE LIST OF ANY SUB-CONTRACTORS WITH THEIR ADDRESS AND CONTACT INFORMATION (E-MAIL ADDRESS/ PHONE NO.) FOR THE COUNTY'S FILE.

FUNDING SOURCE					STP	
					80% FED 20% LOCAL	100% LOCAL
CONSTRUCTION TYPE CODE					0005	0005
CODE NO.	ITEM	UNIT	TOTAL QUANTITY	ROADWAY	ROADWAY	
20201200	REMOVAL AND DISPOSAL OF UNSUITABLE MATERIAL	CU YD	179	133	46	
20800150	TRENCH BACKFILL	CU YD	5	5		
21001000	GEOTECHNICAL FABRIC FOR GROUND STABILIZATION	SQ YD	178	124	54	
21101615	TOPSOIL FURNISH AND PLACE, 4"	SQ YD	1958	1804	154	
25000400	NITROGEN FERTILIZER NUTRIENT	POUND	24	22	2	
25000500	PHOSPHORUS FERTILIZER NUTRIENT	POUND	24	22	2	
25000600	POTASSIUM FERTILIZER NUTRIENT	POUND	24	22	2	
25200110	SODDING, SALT TOLLERANT	SQ YD	1958	1804	154	
25200200	SUPPLEMENTAL WATERING	UNIT	14	12	2	
28000250	TEMPORARY EROSION CONTROL SEEDING	POUND	60	50	10	
28000510	INLET FILTERS	EACH	68	60	8	
30300001	AGGREGATE SUBGRADE IMPROVEMENT	CU YD	119	83	36	
40600290	BITUMINOUS MATERIALS (TACK COAT)	POUND	20129	17577	2552	
40600400	MIXTURE FOR CRACKS, JOINTS, AND FLANGEWAYS	TON	5	5		
40600982	HOT-MIX ASPHALT SURFACE REMOVAL - BUTT JOINT	SQ YD	362	350	12	
40602978	HOT-MIX ASPHALT BINDER COURSE, IL-9.5, N50	TON	2457	2146	311	
40604060	HOT-MIX ASPHALT SURFACE COURSE, IL-9.5, MIX "D", N50	TON	2457	2146	311	

~ INDICATES A SPECIALTY ITEM

FUNDING SOURCE					STP	
					80% FED 20% LOCAL	100% LOCAL
CONSTRUCTION TYPE CODE					0005	0005
CODE NO.	ITEM	UNIT	TOTAL QUANTITY	ROADWAY	ROADWAY	
60500060	REMOVING INLETS	EACH	4	4		
67100100	MOBILIZATION	L SUM	1	0.9	0.1	
70102620	TRAFFIC CONTROL AND PROTECTION, STANDARD 701501	L SUM	1	0.9	0.1	
70102635	TRAFFIC CONTROL AND PROTECTION, STANDARD 701701	L SUM	1	0.9	0.1	
70102640	TRAFFIC CONTROL AND PROTECTION, STANDARD 701801	L SUM	1	0.9	0.1	
70107025	CHANGEABLE MESSAGE SIGN	CAL DA	56	56		
70300100	SHORT TERM PAVEMENT MARKING	FOOT	2100	2043	57	
70300150	SHORT TERM PAVEMENT MARKING REMOVAL	SQ FT	700	681	19	
70300211	TEMPORARY PAVEMENT MARKING - LETTERS AND SYMBOLS - PAINT	SQ FT	228	228		
70300221	TEMPORARY PAVEMENT MARKING - LINE 4" - PAINT	FOOT	12000	10860	1140	
70300241	TEMPORARY PAVEMENT MARKING - LINE 6" - PAINT	FOOT	5780	5440	340	
70300261	TEMPORARY PAVEMENT MARKING - LINE 12" - PAINT	FOOT	2180	2180		
70300281	TEMPORARY PAVEMENT MARKING - LINE 24" - PAINT	FOOT	640	640		
~ 78000100	THERMOPLASTIC PAVEMENT MARKING LETTERS AND SYMBOLS - PAINT	SQ FT	114	114		
~ 78000200	THERMOPLASTIC PAVEMENT MARKING - LINE 4"	FOOT	6000	5430	570	
~ 78000400	THERMOPLASTIC PAVEMENT MARKING - LINE 6"	FOOT	2890	2720	170	
~ 78000600	THERMOPLASTIC PAVEMENT MARKING - LINE 12"	FOOT	1090	1090		

~ INDICATES A SPECIALTY ITEM

FILE NAME =	USER NAME = dschroeder	DESIGNED - RML	REVISED -	STATE OF ILLINOIS DEPARTMENT OF TRANSPORTATION	EDGEWATER DRIVE RESURFACING SUMMARY OF QUANTITIES			F.A.U RTE.	SECTION	COUNTY	TOTAL SHEETS	SHEET NO.
N:\BLOOMINGDALE\230261\Civil\500_230051.DWT	DRAWN - RML	REVISED -						4120	22-00078-00-RS	DUPAGE	22	5
Default	PLOT SCALE = 48"	CHECKED - DJS	REVISED -		SCALE: \$SCALE\$	SHEET 3	OF 4	SHEETS	STA. N/A	TO STA. N/A	[ILLINOIS] FED. AID PROJECT	
	PLOT DATE = 10/3/2023	DATE - 10/3/2023	REVISED -									

FUNDING SOURCE					STP	
					80% FED 20% LOCAL	100% LOCAL
CONSTRUCTION TYPE CODE					0005	0005
CODE NO.	ITEM	UNIT	TOTAL QUANTITY	ROADWAY	ROADWAY	
~ 78000650	THERMOPLASTIC PAVEMENT MARKING - LINE 24"	FOOT	320	320		
~ 87900200	DRILL EXISTING HANDHOLE	EACH	2	2		
X0326806	WASHOUT BASIN	L SUM	1	0.9	0.1	
X4230710	PORTLAND CEMENT CONCRETE DRIVEWAY PAVEMENT, 6 INCH (SPECIAL)	SQ YD	400	350	50	
X4240430	PORTLAND CEMENT CONCRETE SIDEWALK 5 INCH (SPECIAL)	SQ FT	11590	10990	600	
X6030310	FRAMES AND LIDS TO BE ADJUSTED (SPECIAL)	EACH	20	20		
~ X8860105	DETECTOR LOOP REPLACEMENT	FOOT	210	210		
XX000406	BRICK PAVER REMOVAL AND REPLACEMENT	SQ FT	3440	3440		
~ XX008910	PAVEMENT MARKING (SPECIAL)	SQ FT	6710	6710		
XX009049	REMOVE AND REPLACE CURB AND GUTTER (SPECIAL)	FOOT	3410	3000	410	
Z0004510	HOT-MIX ASPHALT DRIVEWAY PAVEMENT, 3"	SQ YD	162	137	25	
Z0013798	CONSTRUCTION LAYOUT	L SUM	1	0.9	0.1	
Z0017400	DRAINAGE & UTILITY STRUCTURES TO BE ADJUSTED	EACH	32	29	3	
Z0017700	DRAINAGE & UTILITY STRUCTURES TO BE RECONSTRUCTED	EACH	2	2		
Z0030850	TEMPORARY INFORMATION SIGNING	SQ FT	78	52	26	
* Z0076600	TRAINEES	HOUR	500	500		
* Z0076604	TRAINEES TRAINING PROGRAM GRADUATE	HOUR	500	500		

~ INDICATES A SPECIALTY ITEM

* = 0042

FILE NAME =	USER NAME = dachroeder	DESIGNED - RML	REVISED -	STATE OF ILLINOIS DEPARTMENT OF TRANSPORTATION	EDGEWATER DRIVE RESURFACING SUMMARY OF QUANTITIES	F.A.U RTE.	SECTION	COUNTY	TOTAL SHEETS	SHEET NO.		
N:\BLOOMINGDALE\230261\Civil\500_230261.DWT		DRAWN - RML	REVISED -			4120	22-00078-00-RS	DUPAGE	22	6		
Default	PLOT SCALE = 40'	CHECKED - DJS	REVISED -			SCALE: \$SCALE\$	SHEET 4	OF 4	SHEETS	STA. N/A	TO STA. N/A	CONTRACT NO. 61J77
	PLOT DATE = 10/3/2023	DATE - 10/3/2023	REVISED -			ILLINOIS FED. AID PROJECT						

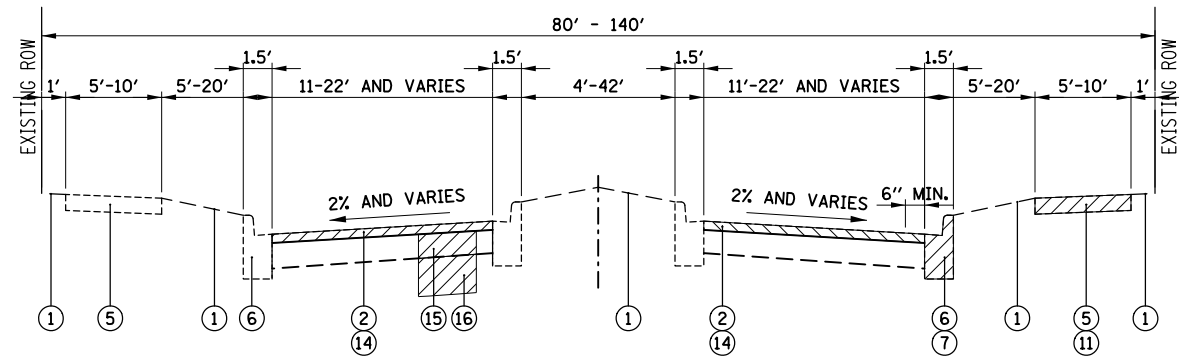

EXISTING TYPICAL SECTION
EGEWATER DRIVE - STA 100+00 TO STA 119+25
EGEWATER DRIVE - STA 138+05 TO STA 153+27

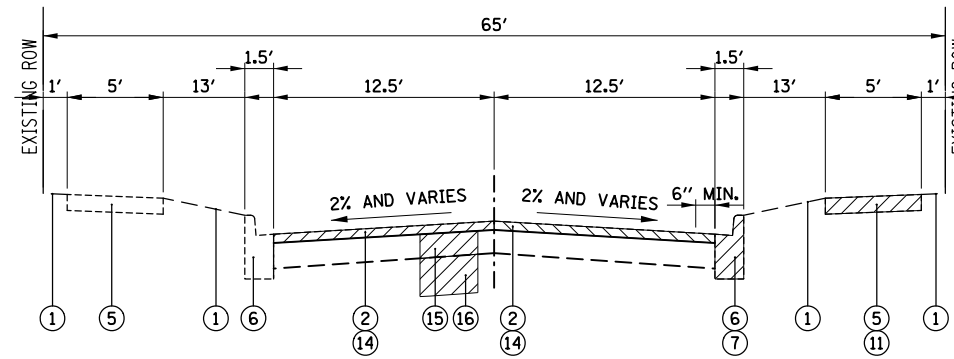

EXISTING TYPICAL SECTION
LAKEVIEW LANE STA. 10+00 TO 18+80

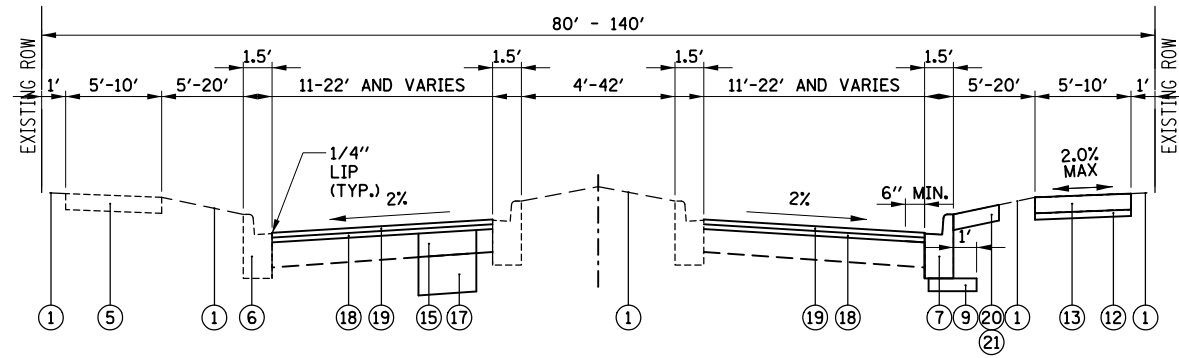

PROPOSED TYPICAL SECTION
EGEWATER DRIVE - STA 100+00 TO STA 119+25
EGEWATER DRIVE - STA 138+05 TO STA 153+27

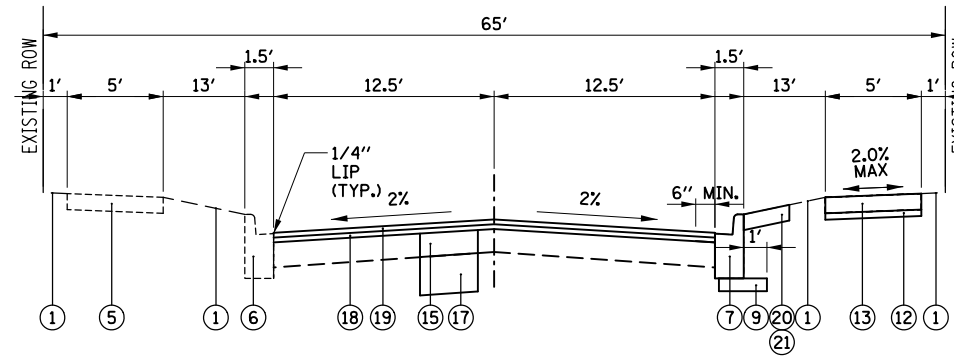

PROPOSED TYPICAL SECTION
LAKEVIEW LANE STA. 10+00 TO 18+80

LEGEND

- ▨ ITEMS TO BE REMOVED
- ① EXISTING SOIL AND GROUND COVER
- ② EXISTING HMA BINDER AND SURFACE COURSE
- ③ EXISTING EXISTING HMA SHOULDER
- ④ EXISTING EXISTING AGGREGATE SHOULDER
- ⑤ EXISTING PORTLAND CEMENT CONCRETE SIDEWALK
- ⑥ EXISTING COMBINATION CONCRETE CURB AND GUTTER
- ⑦* REMOVE AND REPLACE CURB AND GUTTER (SPECIAL)
- ⑧ THIS ITEM HAS BEEN INTENTIONALLY LEFT BLANK
- ⑨ SUBBASE GRANULAR MATERIAL, TYPE B, 4" (INCLUDED IN THE COST OF REMOVE AND REPLACE CURB AND GUTTER (SPECIAL))
- ⑩ THIS ITEM HAS BEEN INTENTIONALLY LEFT BLANK
- ⑪* SIDEWALK REMOVAL
- ⑫ SUBBASE GRANULAR MATERIAL, TYPE B, 2" (INCLUDED IN THE COST OF PORTLAND CEMENT CONCRETE SIDEWALK 5 INCH (SPECIAL))
- ⑬* PORTLAND CEMENT CONCRETE SIDEWALK 5 INCH (SPECIAL)
- ⑭* HOT-MIX ASPHALT SURFACE REMOVAL, 2 3/4"
- ⑮* CLASS D PATCHES, VARIOUS TYPES, 6 INCH
- ⑯* REMOVAL AND DISPOSAL OF UNSUITABLE MATERIALS
- ⑰* AGGREGATE SUBGRADE IMPROVEMENT
- ⑱ HOT-MIX ASPHALT BINDER COURSE, IL-9.5, N50 - 1.5"
- ⑲ HOT-MIX ASPHALT SURFACE COURSE, IL-9.5, MIX "D", N50 - 1.5"
- ⑳* TOPSOIL FURNISH AND PLACE, 4"
- ㉑* SODDING, SPECIAL

NOTES:

- 1. *INDICATES ITEM AS DIRECTED BY THE ENGINEER IN THE FIELD

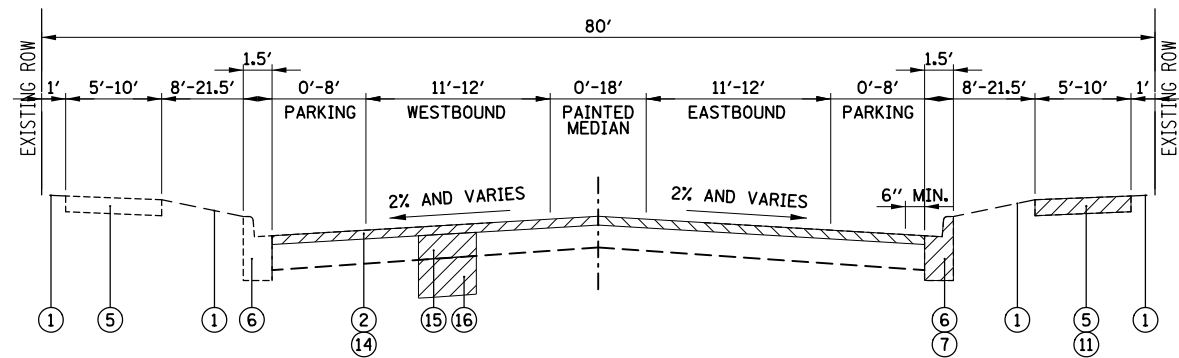

EXISTING TYPICAL SECTION
EGEWATER DRIVE - STA 119+25 TO STA 138+05

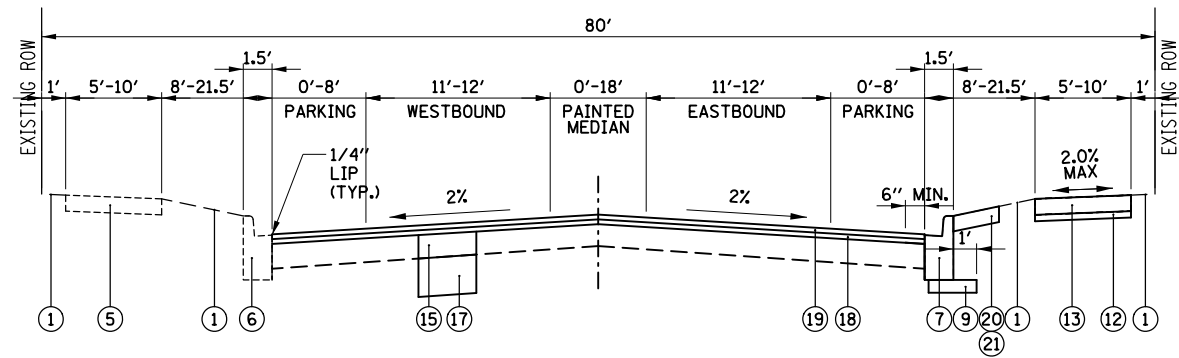

PROPOSED TYPICAL SECTION
EGEWATER DRIVE - STA 119+25 TO STA 138+05

HOT-MIX ASPHALT MIXTURE REQUIREMENTS		
MIXTURE ITEM	AIR VOIDS @ Ndes	QMP TYPE
PAVEMENT RESURFACING		
HOT-MIX ASPHALT SURFACE COURSE, MIX"D", IL-9.5, N50; 1.5"	4% @ 50 GYR	LR 1030-2
HOT-MIX ASPHALT BINDER COURSE, IL-9.5, N50; 1.5"	4% @ 50 GYR	LR 1030-2
HOT-MIX ASPHALT DRIVEWAY PAVEMENT, 3"		
HOT-MIX ASPHALT SURFACE COURSE, MIX"D", IL-9.5, N50; 3" (IN 2 LIFTS)	4% @ 50 GYR	LR 1030-2
PATCHING		
CLASS D PATCHES (HMA BINDER IL-19mm)	4% @ 70 GYR	LR 1030-2
QMP Designations: Quality Control/Quality Assurance (QC/QA) per LR 1030-2		

NOTES:

THE UNIT WEIGHT USED TO CALCULATE ALL HMA SURFACE MIXTURE QUANTITIES IS 112 LBS/SQ YD/IN.
THE "AC TYPE" FOR POLYMERIZED HMA MIXES SHALL BE "SBS/SBR PG 76-22" AND FOR NON-POLYMERIZED HMA THE "AC TYPE" SHALL BE PG 64-22" UNLESS MODIFIED BY RECLAIMED MATERIALS SPECIFICATIONS

FILE NAME = N:\BLOOMINGDALE\230061\Civil\TYP.230061.001.SHT	USER NAME = dschroeder	DESIGNED - RML	REVISED -
Default	PLOT SCALE = 48"	DRAWN - RML	REVISED -
	PLOT DATE = 9/4/2023	CHECKED - DJS	REVISED -
		DATE - 9/4/2023	REVISED -

STATE OF ILLINOIS
DEPARTMENT OF TRANSPORTATION

EGEWATER DRIVE RESURFACING
TYPICAL SECTIONS

SCALE: *SCALE* SHEET 1 OF 1 SHEETS STA. N/A TO STA. N/A

F.A.U. RTE.	SECTION	COUNTY	TOTAL SHEETS	SHEET NO.
4120	22-00078-00-R5	DUPAGE	22	7
CONTRACT NO. 61J77				
ILLINOIS FED. AID PROJECT				

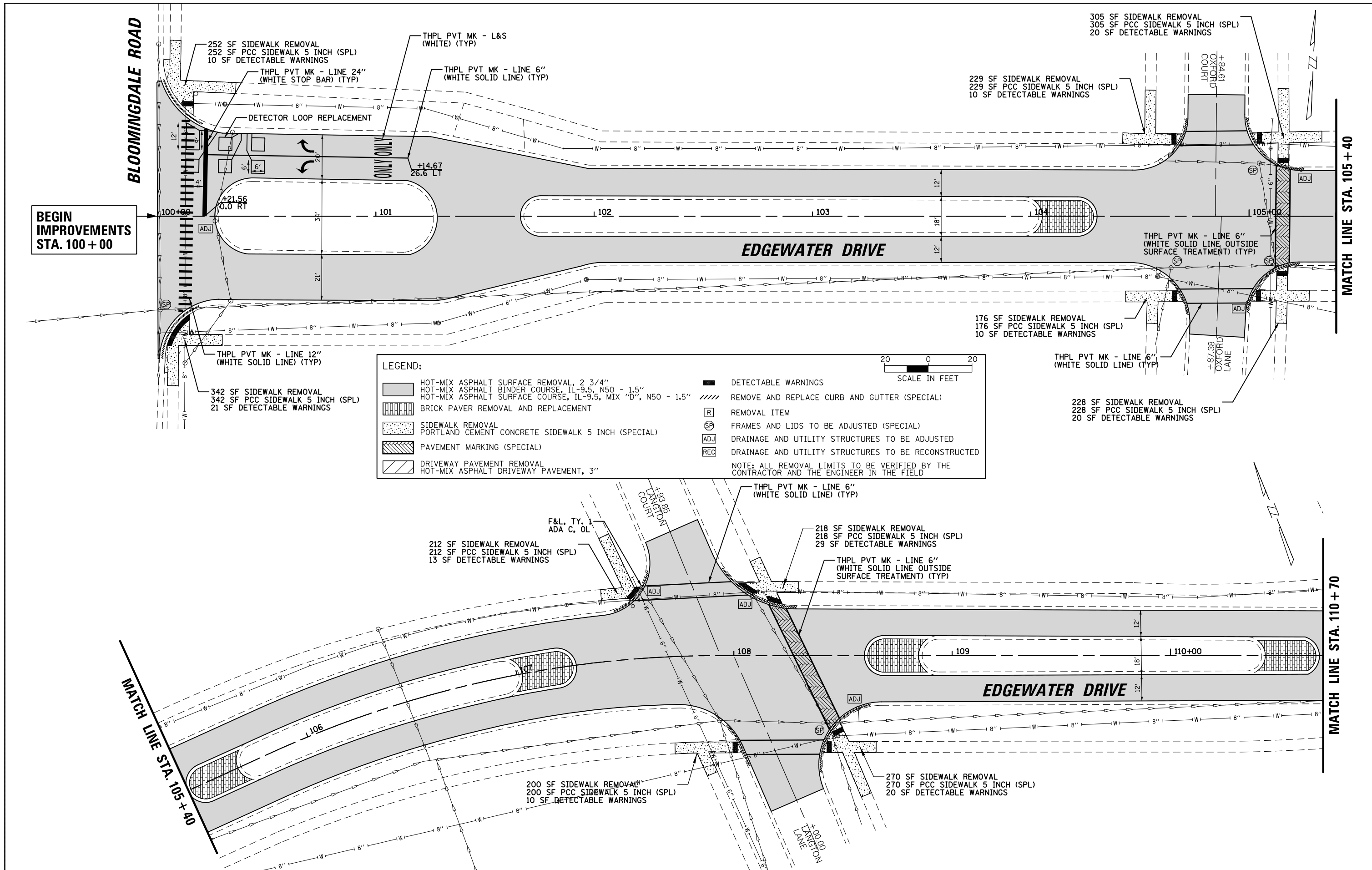

LEGEND:

	HOT-MIX ASPHALT SURFACE REMOVAL, 2 3/4"		DETECTABLE WARNINGS
	HOT-MIX ASPHALT BINDER COURSE, IL-9.5, N50 - 1.5"		REMOVE AND REPLACE CURB AND GUTTER (SPECIAL)
	HOT-MIX ASPHALT SURFACE COURSE, IL-9.5, MIX "D", N50 - 1.5"		REMOVAL ITEM
	BRICK PAVER REMOVAL AND REPLACEMENT		FRAMES AND LIDS TO BE ADJUSTED (SPECIAL)
	SIDEWALK REMOVAL PORTLAND CEMENT SIDEWALK 5 INCH (SPECIAL)		DRAINAGE AND UTILITY STRUCTURES TO BE ADJUSTED
	PAVEMENT MARKING (SPECIAL)		DRAINAGE AND UTILITY STRUCTURES TO BE RECONSTRUCTED
	DRIVEWAY PAVEMENT REMOVAL HOT-MIX ASPHALT DRIVEWAY PAVEMENT, 3"	NOTE: ALL REMOVAL LIMITS TO BE VERIFIED BY THE CONTRACTOR AND THE ENGINEER IN THE FIELD	

20 0 20
SCALE IN FEET

FILE NAME =	USER NAME = dschroeder	DESIGNED - RML	REVISED -	STATE OF ILLINOIS DEPARTMENT OF TRANSPORTATION	EDGEWATER DRIVE RESURFACING PROPOSED ROADWAY PLAN	F.A.U. RTE.	SECTION	COUNTY	TOTAL SHEETS	SHEET NO.	
		DRAWN - RML	REVISED -			4120	22-00078-00-R5	DUPAGE	22	8	
		CHECKED - DJS	REVISED -			CONTRACT NO. 61J77					
		DATE - 10/12/2023	REVISED -			ILLINOIS FED. AID PROJECT					

NOTE: THOMPSON PARK IS USED DAILY BY THE BLOOMINGDALE BASEBALL AND SOFTBALL ASSOCIATION. PEDESTRIAN AND VEHICLE ACCESS MUST BE MAINTAINED THROUGHOUT THE DURATION OF CONSTRUCTION AND CLOSURES LIMITED TO A MINIMUM

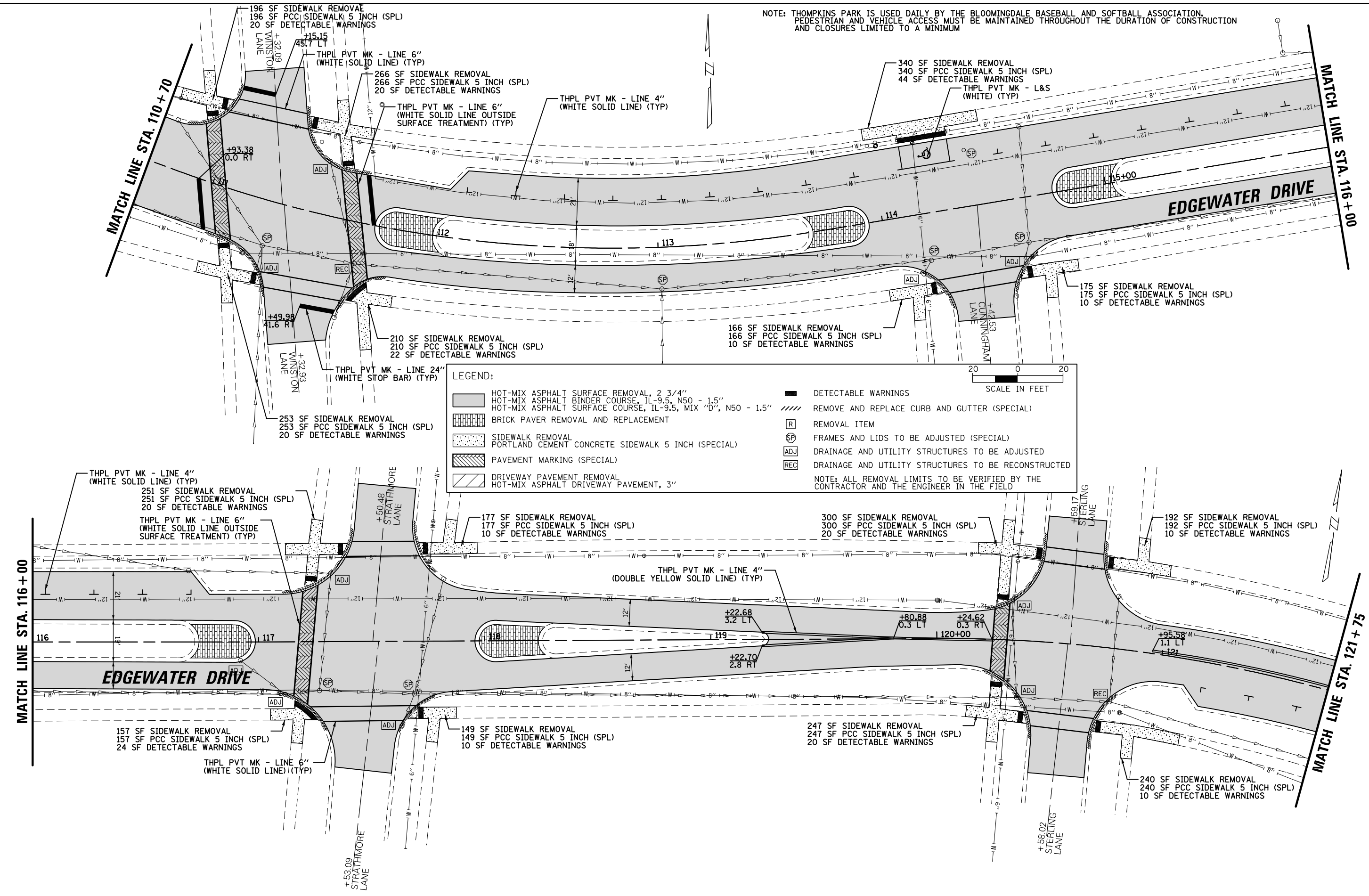

LEGEND:

	HOT-MIX ASPHALT SURFACE REMOVAL, 2 3/4"		DETECTABLE WARNINGS
	HOT-MIX ASPHALT BINDER COURSE, IL-9.5, N50 - 1.5"		REMOVE AND REPLACE CURB AND GUTTER (SPECIAL)
	HOT-MIX ASPHALT SURFACE COURSE, IL-9.5, MIX "D", N50 - 1.5"		REMOVAL ITEM
	BRICK PAVER REMOVAL AND REPLACEMENT		FRAMES AND LIDS TO BE ADJUSTED (SPECIAL)
	SIDEWALK REMOVAL PORTLAND CEMENT CONCRETE SIDEWALK 5 INCH (SPECIAL)		DRAINAGE AND UTILITY STRUCTURES TO BE ADJUSTED
	PAVEMENT MARKING (SPECIAL)		DRAINAGE AND UTILITY STRUCTURES TO BE RECONSTRUCTED
	DRIVEWAY PAVEMENT REMOVAL HOT-MIX ASPHALT DRIVEWAY PAVEMENT, 3"		NOTE: ALL REMOVAL LIMITS TO BE VERIFIED BY THE CONTRACTOR AND THE ENGINEER IN THE FIELD

SCALE IN FEET: 0 20 20

FILE NAME = N:\BLOOMINGDALE\230061\Civil\PROJ.230061	USER NAME = dschroeder	DESIGNED - RML	REVISED -
2022.SHT		DRAWN - RML	REVISED -
PLOT SCALE = 48"		CHECKED - DJS	REVISED -
PLOT DATE = 9/4/2023		DATE - 9/4/2023	REVISED -

**STATE OF ILLINOIS
DEPARTMENT OF TRANSPORTATION**

EDGEWATER DRIVE RESURFACING PROPOSED ROADWAY PLAN	
SCALE: \$SCALE\$	SHEET 2 OF 7 SHEETS STA. 110+70 TO STA. 121+75

F.A.U. RTE.	SECTION	COUNTY	TOTAL SHEETS	SHEET NO.
4120	22-00078-00-R5	DUPAGE	22	9
CONTRACT NO. 61J77			ILLINOIS FED. AID PROJECT	

NOTE: WEST SUBURBAN NURSING REHABILITATION IS LOCATED ON THE NORTH SIDE OF THE ROAD BETWEEN LAUREL LANE AND COLONY GREEN DRIVE. HIGH AMBULANCE TRAFFIC IS ANTICIPATED AND CONSTRUCTION ACTIVITIES SHALL BE SCHEDULED TO LIMIT CLOSURES

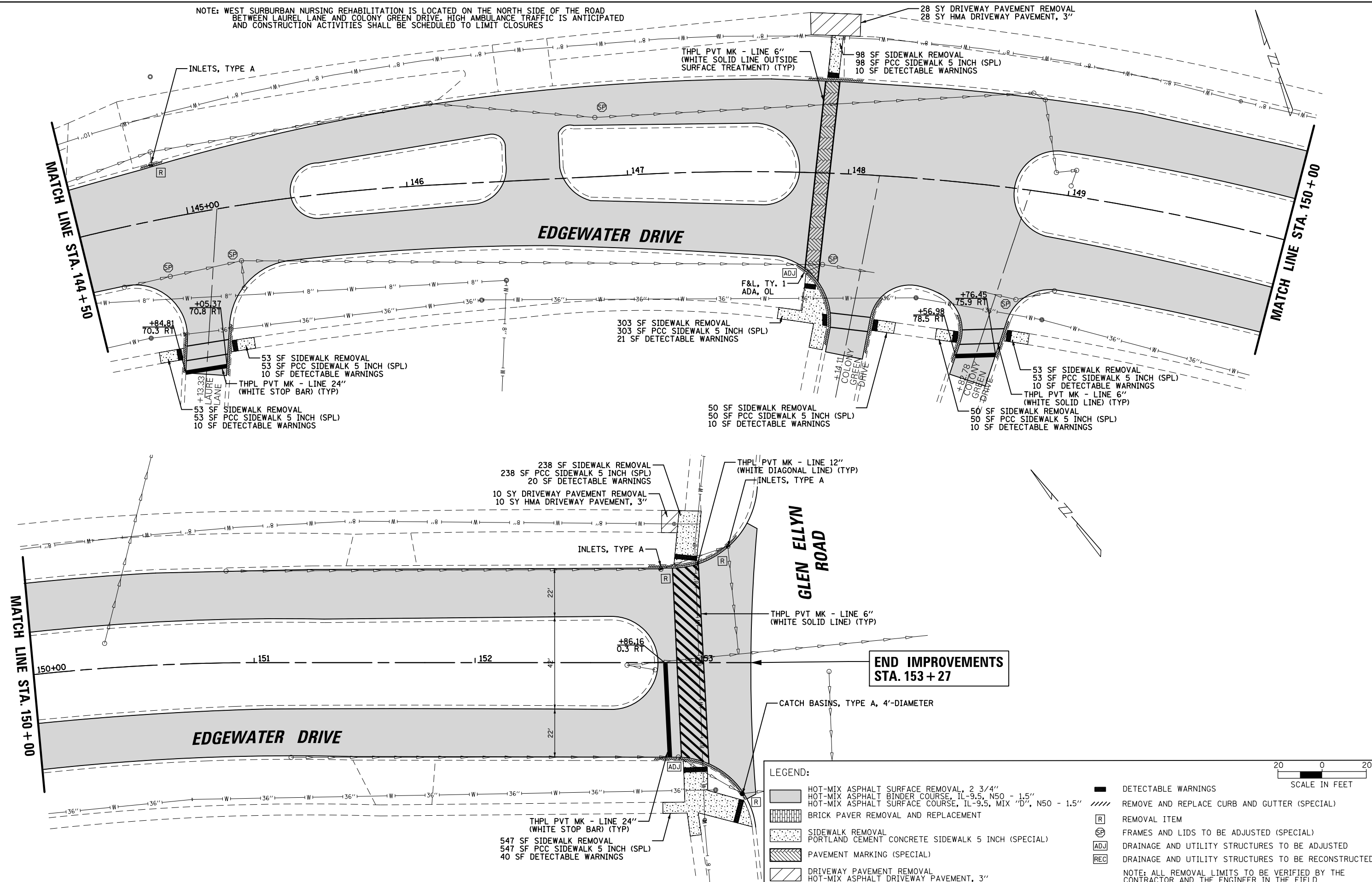

FILE NAME =	USER NAME = dschroeder	DESIGNED - RML	REVISED -
N:\BLOOMINGDALE\230061\Civil\PROJ\230061_005.SHT		DRAWN - RML	REVISED -
Default	PLOT SCALE = 48"	CHECKED - DJS	REVISED -
	PLOT DATE = 9/4/2023	DATE - 9/4/2023	REVISED -

**STATE OF ILLINOIS
DEPARTMENT OF TRANSPORTATION**

**EDGEWATER DRIVE RESURFACING
PROPOSED ROADWAY PLAN**

SCALE: \$SCALE\$ SHEET 5 OF 7 SHEETS STA. 144+50 TO STA. 153+27

F.A.U. RTE.	SECTION	COUNTY	TOTAL SHEETS	SHEET NO.
4120	22-00078-00-R5	DUPAGE	22	12
				CONTRACT NO. 61J77
ILLINOIS FED. AID PROJECT				

LEGEND:

	HOT-MIX ASPHALT SURFACE REMOVAL, 2 3/4"		DETECTABLE WARNINGS
	HOT-MIX ASPHALT BINDER COURSE, IL-9.5, N50 - 1.5"		REMOVE AND REPLACE CURB AND GUTTER (SPECIAL)
	HOT-MIX ASPHALT SURFACE COURSE, IL-9.5, MIX "D", N50 - 1.5"		REMOVAL ITEM
	BRICK PAVER REMOVAL AND REPLACEMENT		FRAMES AND LIDS TO BE ADJUSTED (SPECIAL)
	SIDEWALK REMOVAL		DRAINAGE AND UTILITY STRUCTURES TO BE ADJUSTED
	PORTLAND CEMENT SIDEWALK 5 INCH (SPECIAL)		DRAINAGE AND UTILITY STRUCTURES TO BE RECONSTRUCTED
	PAVEMENT MARKING (SPECIAL)		
	DRIVEWAY PAVEMENT REMOVAL		
	HOT-MIX ASPHALT DRIVEWAY PAVEMENT, 3"		

NOTE: ALL REMOVAL LIMITS TO BE VERIFIED BY THE CONTRACTOR AND THE ENGINEER IN THE FIELD

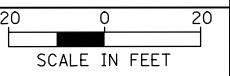

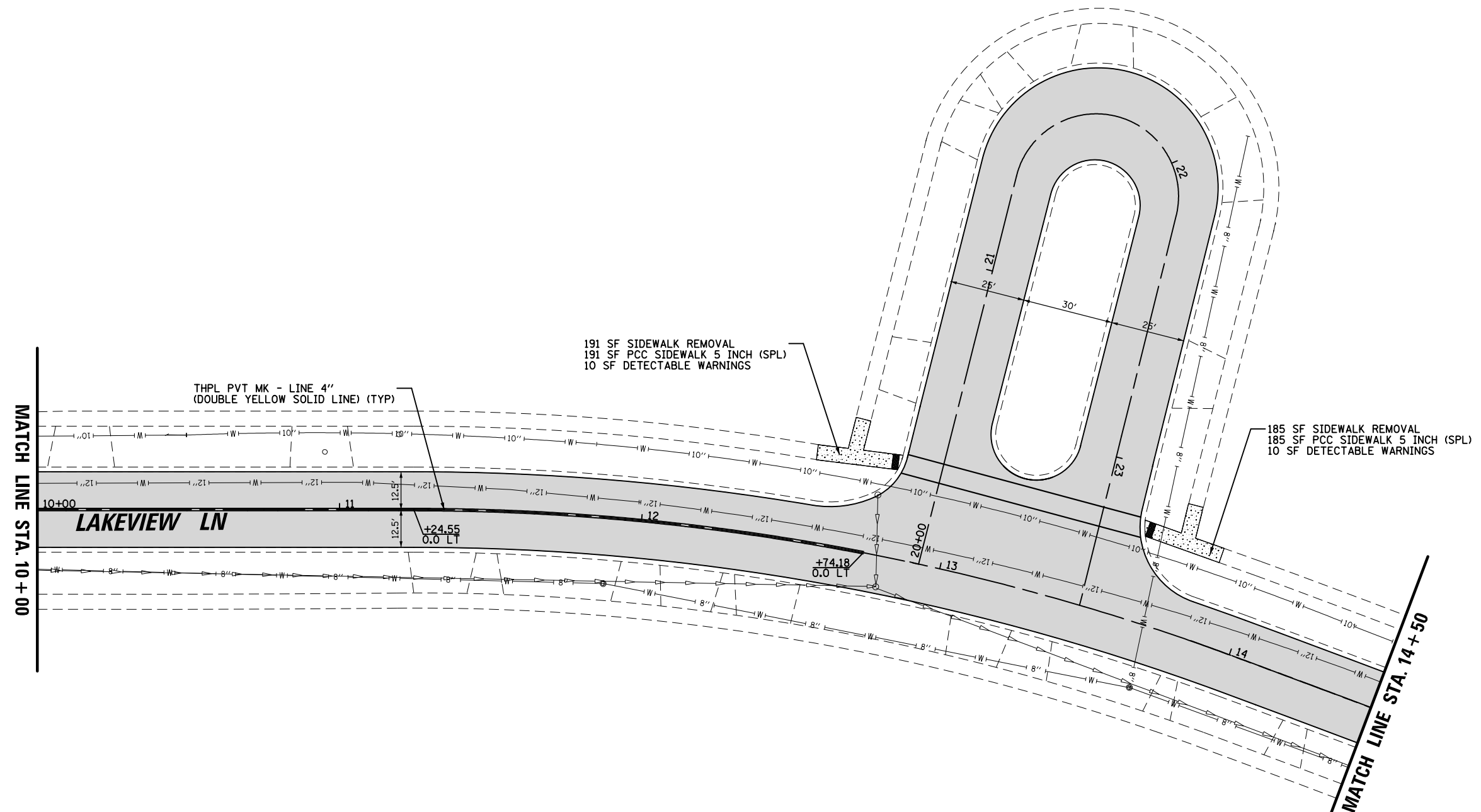
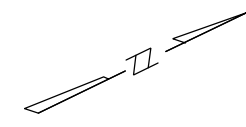

LEGEND:

	HOT-MIX ASPHALT SURFACE REMOVAL, 2 3/4" HOT-MIX ASPHALT BINDER COURSE, IL-9.5, N50 - 1.5" HOT-MIX ASPHALT SURFACE COURSE, IL-9.5, MIX "D", N50 - 1.5"		DETECTABLE WARNINGS
	BRICK PAVER REMOVAL AND REPLACEMENT		REMOVE AND REPLACE CURB AND GUTTER (SPECIAL)
	SIDEWALK REMOVAL PORTLAND CEMENT CONCRETE SIDEWALK 5 INCH (SPECIAL)		REMOVAL ITEM
	PAVEMENT MARKING (SPECIAL)		FRAMES AND LIDS TO BE ADJUSTED (SPECIAL)
	DRIVEWAY PAVEMENT REMOVAL HOT-MIX ASPHALT DRIVEWAY PAVEMENT, 3"		DRAINAGE AND UTILITY STRUCTURES TO BE ADJUSTED
			DRAINAGE AND UTILITY STRUCTURES TO BE RECONSTRUCTED

20 0 20
SCALE IN FEET

NOTE: ALL REMOVAL LIMITS TO BE VERIFIED BY THE CONTRACTOR AND THE ENGINEER IN THE FIELD

FILE NAME =	USER NAME = dschroeder	DESIGNED - RML	REVISED -
N:\BLOOMINGDALE\230061\Civil\PROJ\230061_006.SHT		DRAWN - RML	REVISED -
Default	PLOT SCALE = 48"	CHECKED - DJS	REVISED -
	PLOT DATE = 9/4/2023	DATE - 9/4/2023	REVISED -

**STATE OF ILLINOIS
DEPARTMENT OF TRANSPORTATION**

LAKEVIEW LANE PROPOSED ROADWAY PLAN			
SCALE: #SCALE#	SHEET 6	OF 7 SHEETS	STA. 10+00 TO STA. 14+50

F.A.U. RTE.	SECTION	COUNTY	TOTAL SHEETS	SHEET NO.
4120	22-00078-00-R5	DUPAGE	22	13
CONTRACT NO. 61J77				
ILLINOIS FED. AID PROJECT				

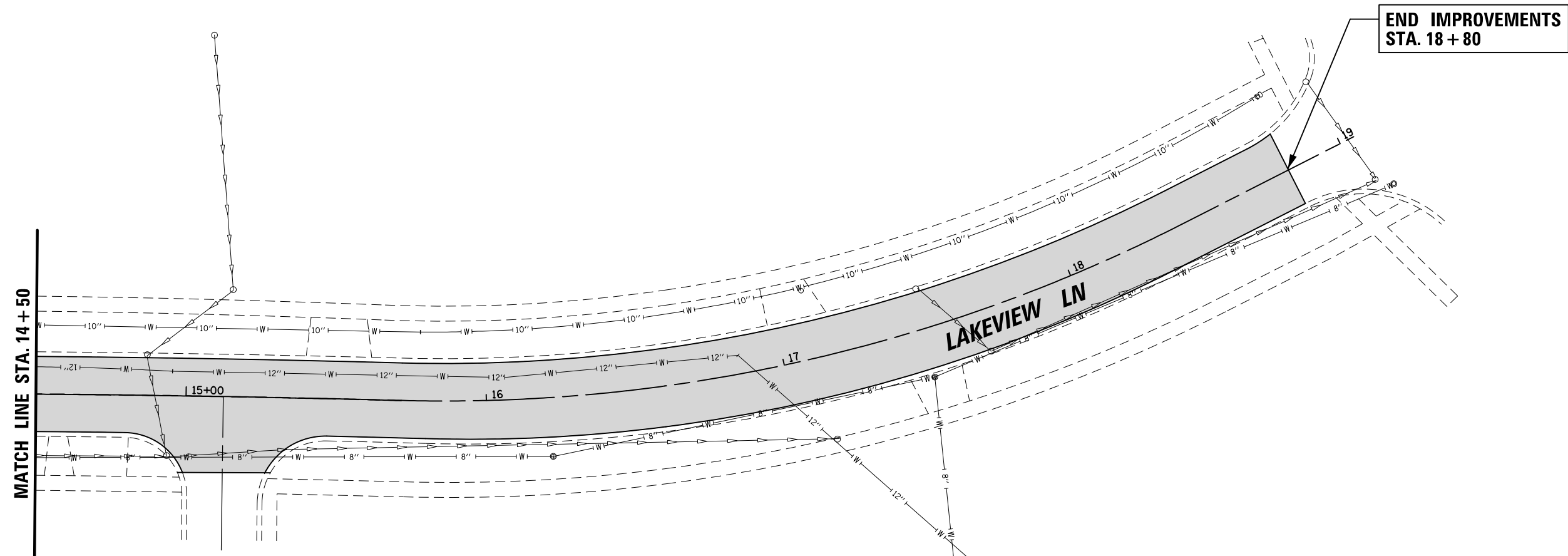
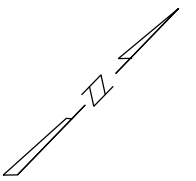

LEGEND:

	HOT-MIX ASPHALT SURFACE REMOVAL, 2 3/4"		DETECTABLE WARNINGS
	HOT-MIX ASPHALT BINDER COURSE, IL-9.5, N50 - 1.5"		REMOVE AND REPLACE CURB AND GUTTER (SPECIAL)
	HOT-MIX ASPHALT SURFACE COURSE, IL-9.5, MIX "D", N50 - 1.5"		REMOVAL ITEM
	BRICK PAVER REMOVAL AND REPLACEMENT		FRAMES AND LIDS TO BE ADJUSTED (SPECIAL)
	SIDEWALK REMOVAL PORTLAND CEMENT CONCRETE SIDEWALK 5 INCH (SPECIAL)		DRAINAGE AND UTILITY STRUCTURES TO BE ADJUSTED
	PAVEMENT MARKING (SPECIAL)		DRAINAGE AND UTILITY STRUCTURES TO BE RECONSTRUCTED
	DRIVEWAY PAVEMENT REMOVAL HOT-MIX ASPHALT DRIVEWAY PAVEMENT, 3"		NOTE: ALL REMOVAL LIMITS TO BE VERIFIED BY THE CONTRACTOR AND THE ENGINEER IN THE FIELD

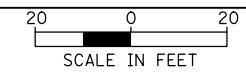

FILE NAME =	USER NAME = dschroeder	DESIGNED - RML	REVISED -
N:\BLOOMINGDALE\230061\Civil\PROJ\230061_007.SHT		DRAWN - RML	REVISED -
Default	PLOT SCALE = 48"	CHECKED - DJS	REVISED -
	PLOT DATE = 9/4/2023	DATE - 9/4/2023	REVISED -

**STATE OF ILLINOIS
DEPARTMENT OF TRANSPORTATION**

**LAKEVIEW LANE RESURFACING
PROPOSED ROADWAY PLAN**

SCALE: *SCALE* SHEET 7 OF 7 SHEETS STA. 14+00 TO STA. 18+81

F.A.U. RTE.	SECTION	COUNTY	TOTAL SHEETS	SHEET NO.
4120	22-00078-00-R5	DUPAGE	22	14
CONTRACT NO. 61J77				
ILLINOIS FED. AID PROJECT				

POINT	NORTHING	EASTING	ELEVATION
1	1923031.38	1053030.30	767.91 (M.E.)
2	1923031.67	1053032.86	768.27 (M.E.)
3	1923029.41	1053033.16	768.23
4	1923029.45	1053034.83	768.26
4A	1923034.45	1053034.77	768.26
4B	1923038.38	1053034.73	768.26 (M.E.)
5	1923029.55	1053039.83	768.21
5A	1923034.55	1053039.69	768.17
5B	1923038.48	1053039.57	767.91 (M.E.)
6	1923019.88	1053032.69	767.70
7	1923019.91	1053034.41	767.95
7A	1923019.93	1053035.04	767.94
8	1923020.03	1053040.03	767.86
9	1923014.95	1053033.88	767.54
10	1923014.97	1053035.54	767.87
11	1923020.05	1053040.98	767.85
12	1923020.13	1053045.98	767.77
13	1923015.05	1053041.06	767.80
14	1923015.13	1053046.06	767.72
15	1923005.98	1053041.19	767.07
16	1923006.06	1053046.19	767.05
17	1923003.78	1053041.23	767.07
18	1923002.08	1053046.25	766.99
19	1923000.26	1053046.28	766.99
20	1922998.43	1053059.61	767.01 (M.E.)
21	1922996.93	1053059.51	766.58 (M.E.)
22	1923020.21	1053065.45	767.03 (M.E.)
23	1923015.32	1053065.46	766.98 (M.E.)

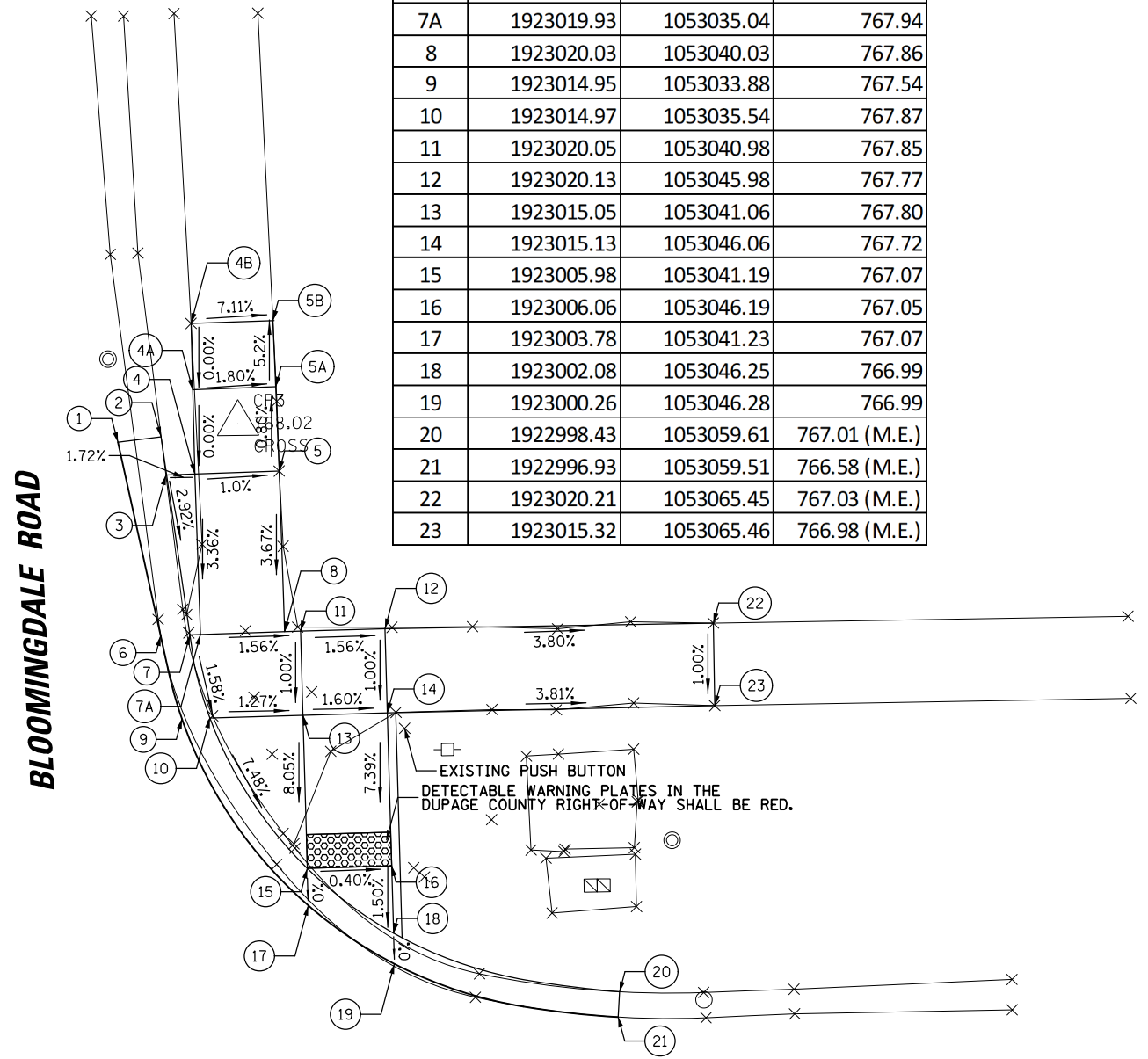
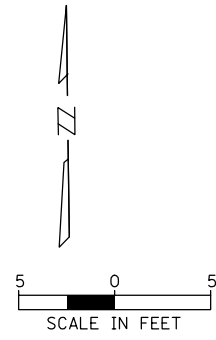

EDGEWATER DRIVE

POINT	NORTHING	EASTING	ELEVATION
CP1	1923018.30	1053114.48	766.50
CP2	1922859.24	1053044.97	768.14
CP3	1923032.41	1053037.43	768.02

EDGEWATER DRIVE

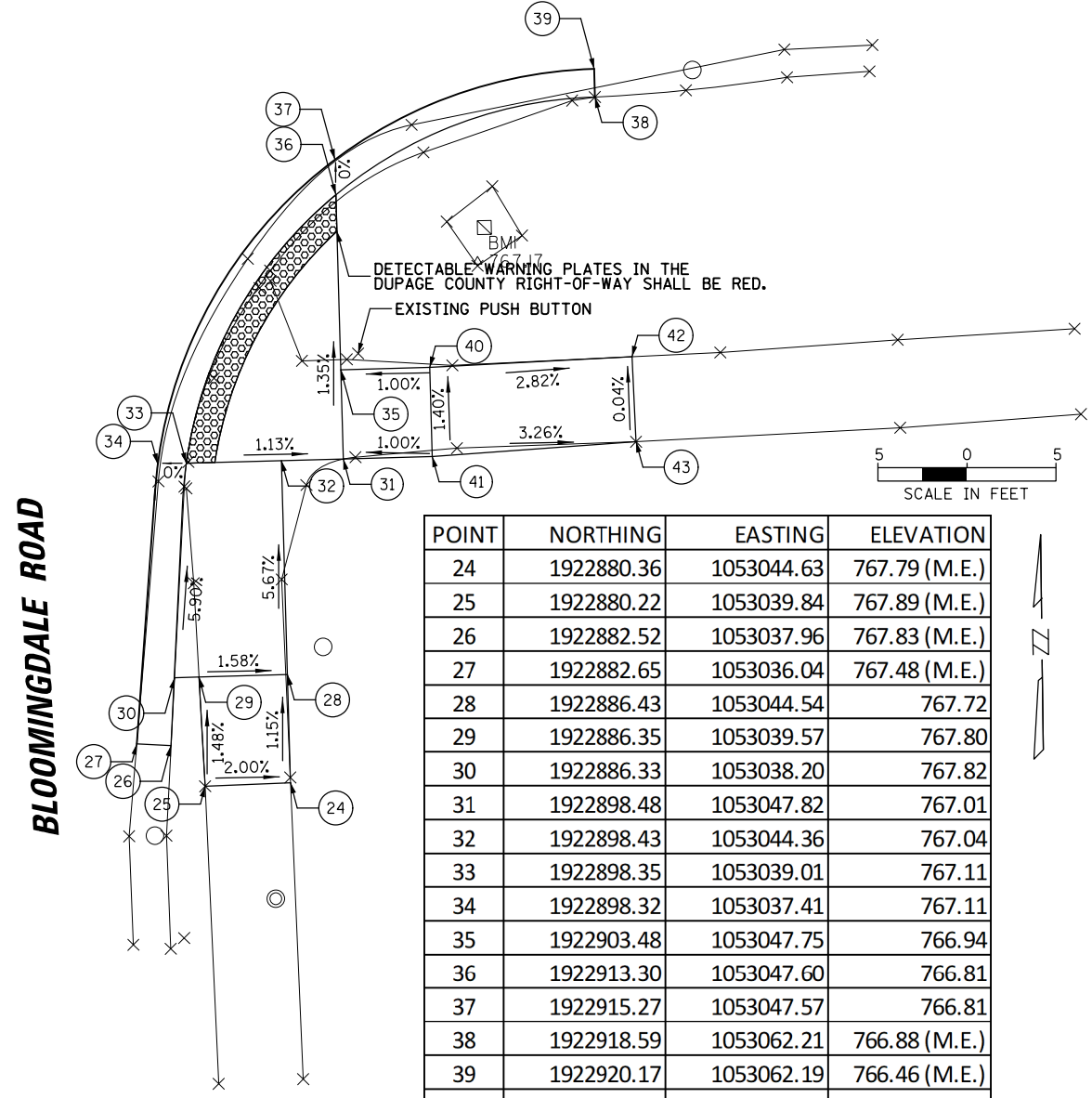

BLOOMINGDALE ROAD

POINT	NORTHING	EASTING	ELEVATION
24	1922880.36	1053044.63	767.79 (M.E.)
25	1922880.22	1053039.84	767.89 (M.E.)
26	1922882.52	1053037.96	767.83 (M.E.)
27	1922882.65	1053036.04	767.48 (M.E.)
28	1922886.43	1053044.54	767.72
29	1922886.35	1053039.57	767.80
30	1922886.33	1053038.20	767.82
31	1922898.48	1053047.82	767.01
32	1922898.43	1053044.36	767.04
33	1922898.35	1053039.01	767.11
34	1922898.32	1053037.41	767.11
35	1922903.48	1053047.75	766.94
36	1922913.30	1053047.60	766.81
37	1922915.27	1053047.57	766.81
38	1922918.59	1053062.21	766.88 (M.E.)
39	1922920.17	1053062.19	766.46 (M.E.)
40	1922903.56	1053052.75	766.99
41	1922898.56	1053052.82	767.06
42	1922904.01	1053064.09	766.67 (M.E.)
43	1922899.23	1053064.26	766.69 (M.E.)

FILE NAME =	USER NAME = dschroeder	DESIGNED - RML	REVISED -
N:\BLOOMINGDALE\230061\Civil\DET_ADA_230061.SHT		DRAWN - RML	REVISED -
Default	PLOT SCALE = 10'	CHECKED - DJS	REVISED -
	PLOT DATE = 10/12/2023	DATE - 10/12/2023	REVISED -

**STATE OF ILLINOIS
DEPARTMENT OF TRANSPORTATION**

EDGEWATER DRIVE RESURFACING BLOOMINGDALE ROAD ADA DETAILS		F.A.U. RTE.	SECTION	COUNTY	TOTAL SHEETS	SHEET NO.
SCALE: *SCALE*	SHEET 1 OF 1 SHEETS	STA. N/A	TO STA. N/A	DUPAGE	22	14A

CONTRACT NO. 61J77		ILLINOIS FED. AID PROJECT	
--------------------	--	---------------------------	--

VARIABLE--TO MEET EXISTING DIMENSIONS AND FIELD CONDITIONS (SEE NOTE 2)

COMBINATION CONCRETE CURB AND GUTTER IN ACCORDANCE WITH STATE STANDARD 606001 (SEE NOTE 2)

SAW CUT FULL DEPTH INCLUDED IN THE COST OF SIDEWALK OR DRIVEWAY REMOVAL PAY ITEM

SEE STATE STANDARD 606001

VARIES

PROPOSED HMA SURFACE (IF APPLICABLE)

EXISTING SIDEWALK, DRIVEWAY, OR GROUND

PROPOSED EXPOSED SURFACE, SIDEWALK, DRIVEWAY PAVEMENT, OR SODDING (SPECIAL)

SUITABLE BACKFILL MATERIAL

EXISTING CONCRETE PAVEMENT, CONCRETE BASE COURSE OR FLEXIBLE PAVEMENT

PROPOSED 3/4" (20) PREFORMED EXPANSION JOINT AT CONCRETE SIDEWALKS, DRIVEWAYS, AND MEDIANS. INCLUDED IN THE COST OF THE PROPOSED RESTORATION ITEM

SAW CUT FULL DEPTH INCLUDED IN THE COST OF REMOVE AND REPLACE CURB AND GUTTER (SPECIAL)

* 2 - #6 EPOXY COATED SMOOTH DOWEL BARS (18" LONG) INCLUDED IN THE COST OF REMOVE AND REPLACE CURB AND GUTTER (SPECIAL)

PROPOSED PAVEMENT REMOVAL AND PROPOSED P.C.C. BASE COURSE 7" (MIN.) INCLUDED IN THE COST OF REMOVE AND REPLACE CURB AND GUTTER (SPECIAL) WHEN ABUTTING EXISTING PAVEMENT

NOTE:

UNSUITABLE SUB-BASE MATERIAL TO BE REMOVED, IF DIRECTED BY THE ENGINEER, SHALL BE REPLACED WITH EITHER SUB-BASE GRANULAR MATERIAL TYPE B OR ADDITIONAL THICKNESS OF CONCRETE.

1. SIDEWALK, DRIVEWAY PAVEMENT OR MEDIAN SURFACE SHALL BE SIMILAR TO THE MATERIAL BEING REMOVED AND WILL BE PAID FOR SEPARATELY.

REMOVAL AND REPLACEMENT 4" (100) OR LESS IS INCLUDED IN REMOVE AND REPLACE CURB AND GUTTER (SPECIAL)

2. CURB OR CURB AND GUTTER SHALL MATCH THE SHAPE OF THE EXISTING CURB OR CURB AND GUTTER UNLESS OTHERWISE DIRECTED BY THE ENGINEER IN THE FIELD

REMOVAL AND REPLACEMENT IN EXCESS OF 4" (100) WILL BE PAID FOR IN ACCORDANCE WITH THE ARTICLE 109.04 OF THE STANDARD SPECIFICATIONS.

4. LONGITUDINAL BARS, IF ENCOUNTERED IN THE EXISTING CURB OR CURB AND GUTTER, ARE NOT TO BE REPLACED. CUTTING AND REMOVING LONGITUDINAL BARS SHALL BE INCLUDED IN THE COST OF REMOVE AND REPLACE CURB AND GUTTER (SPECIAL)

5. THE COST OF HMA SURFACE REMOVAL IN THE EXISTING GUTTER FLAG SHALL BE INCLUDED IN THE COST OF REMOVE AND REPLACE CURB AND GUTTER (SPECIAL)

BASIS OF PAYMENT:

THIS WORK WILL BE PAID FOR AT THE CONTRACT UNIT PRICE PER FOOT (METER) FOR "REMOVE AND REPLACE CURB AND GUTTER (SPECIAL)"

6. THE REMOVAL EXISTING CURB OR CURB AND GUTTER SHALL BE DONE IN ACCORDANCE WITH THE APPLICABLE PORTIONS OF SECTION 440 OF THE STANDARD SPECIFICATIONS AND PAID FOR REMOVE AND REPLACE CURB AND GUTTER (SPECIAL)

ALL DIMENSIONS ARE IN INCHES (MILLIMETERS) UNLESS OTHERWISE SHOWN.

7. THE INSTALLATION OF CURB OR CURB AND GUTTER SHALL BE DONE IN ACCORDANCE WITH THE APPLICABLE PORTIONS OF SECTION 606 OF THE STANDARD SPECIFICATIONS AND PAID FOR AS REMOVE AND REPLACE CURB AND GUTTER (SPECIAL)

8. THE LOCATIONS OF REMOVAL AND REPLACEMENT OF EXISTING CURB OR CURB AND GUTTER SHALL BE DETERMINED BY THE RESIDENT ENGINEER AT THE TIME OF CONSTRUCTION.

REMOVE AND REPLACE CURB AND GUTTER (SPECIAL)

FILE NAME =	USER NAME = dschroeder	DESIGNED - RML	REVISED -	STATE OF ILLINOIS DEPARTMENT OF TRANSPORTATION	EDGEWATER DRIVE RESURFACING CONSTRUCTION DETAILS & STANDARDS	F.A.U. RTE.	SECTION	COUNTY	TOTAL SHEETS	SHEET NO.	
N:\BLOOMINGDALE\230061\Civil\DET_230061_001.SHT		DRAWN - RML	REVISED -			4120	22-00078-00-R5	DUPAGE	22	15	
Default	PLOT SCALE = 48"	CHECKED - DJS	REVISED -			CONTRACT NO. 61J77					
	PLOT DATE = 9/4/2023	DATE - 9/4/2023	REVISED -			SCALE: #SCALE#	SHEET 1 OF 1 SHEETS	STA. N/A	TO STA. N/A	ILLINOIS FED. AID PROJECT	

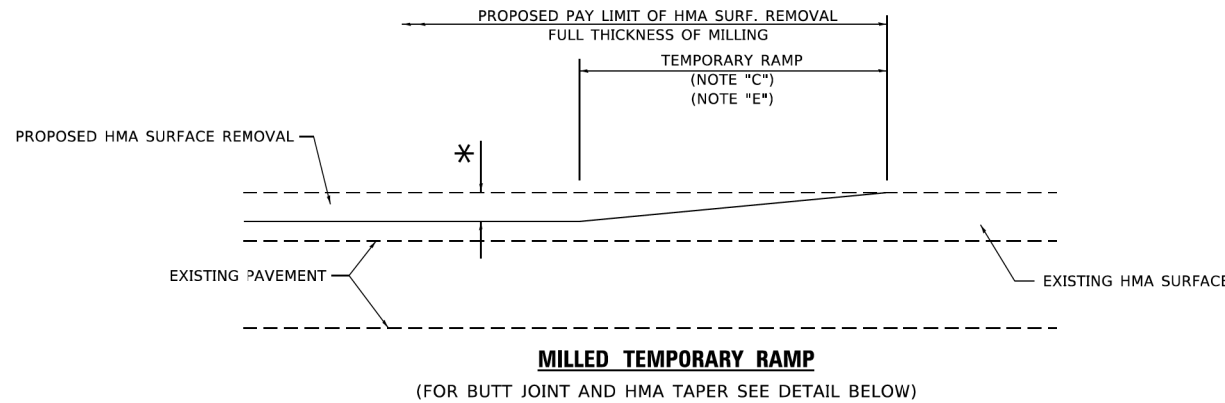

OPTION 1

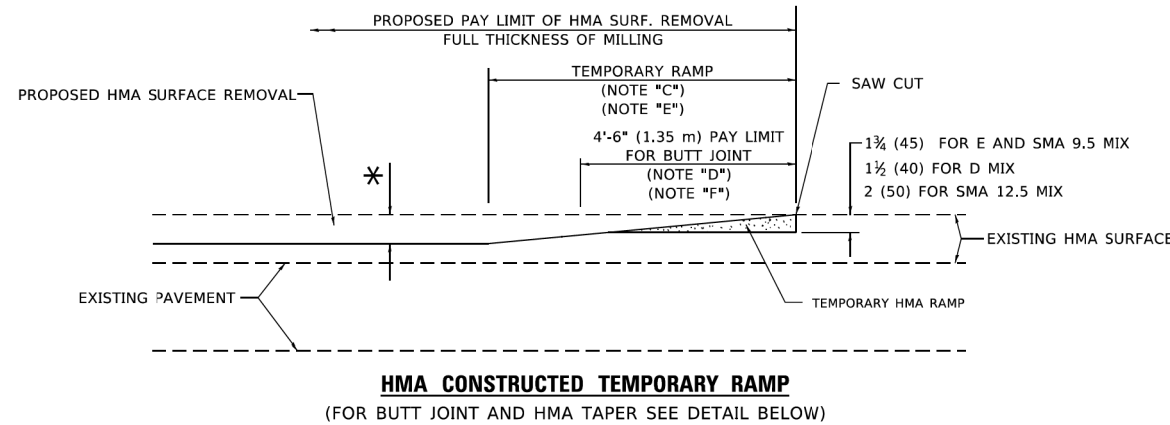

OPTION 2

TYPICAL TEMPORARY RAMP

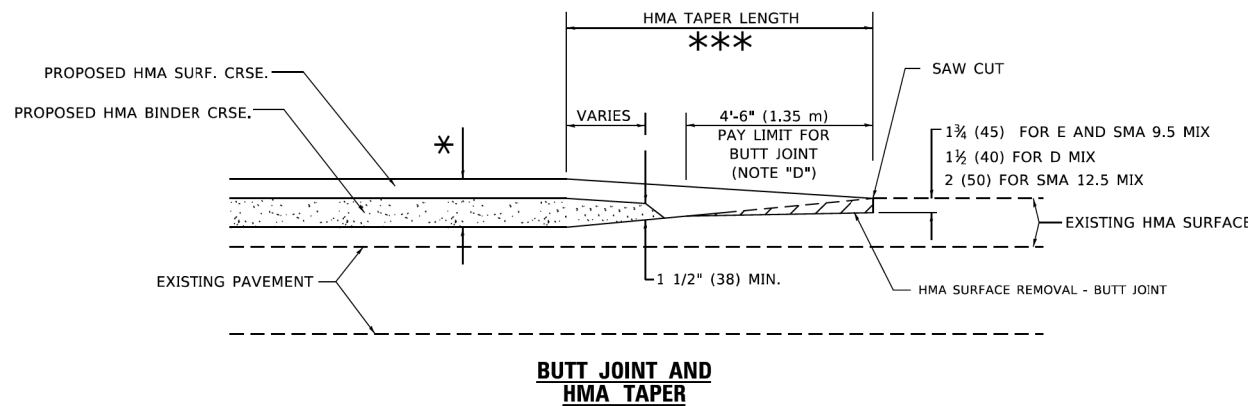

TYPICAL BUTT JOINT AND HMA TAPER FOR MILLING AND RESURFACING

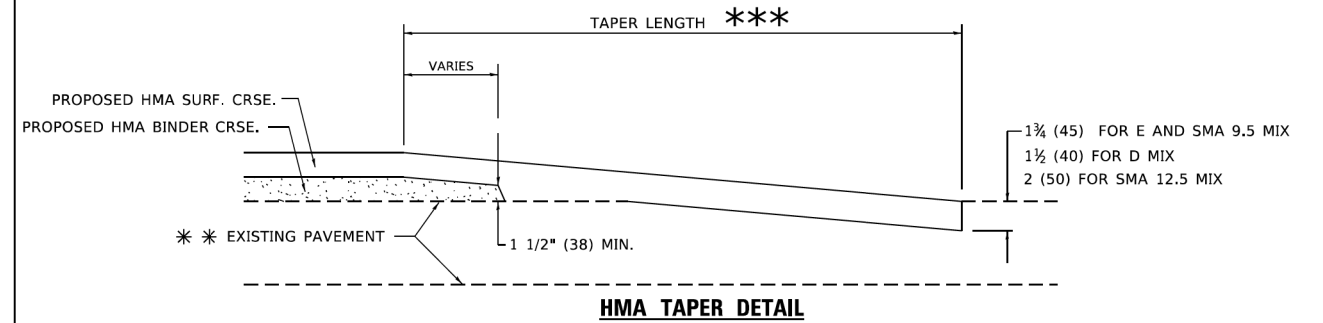
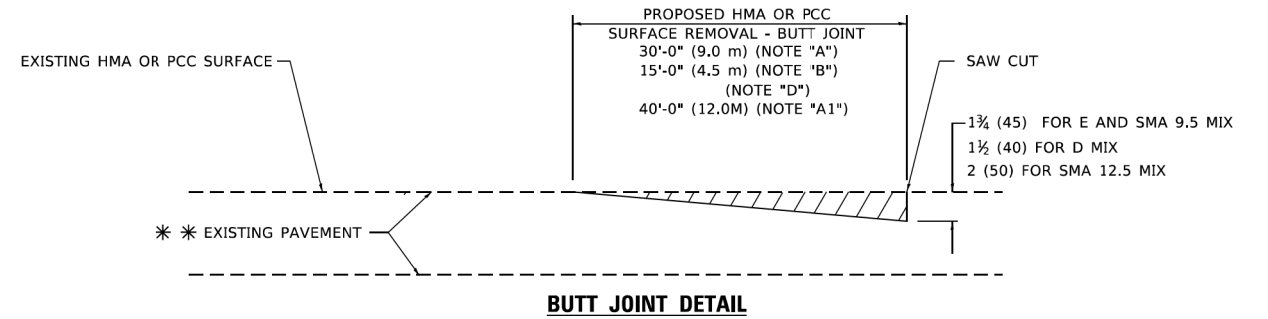

TYPICAL BUTT JOINT AND HMA TAPER FOR RESURFACING ONLY

** PC CONCRETE, HMA OR HMA RESURFACED PAVEMENT.

GENERAL NOTES

- A. MAINLINE ARTERIAL ROADWAYS AND MAJOR SIDE ROADS.
- A1. INTERSTATES
- B. MINOR SIDE ROADS.
- C. THE TEMP. RAMP SHALL BE CONSTRUCTED IMMEDIATELY UPON REMOVAL OF THE EXISTING HMA SURFACE.
- D. THE BUTT JOINT SHALL BE CONSTRUCTED IMMEDIATELY PRIOR TO PLACING THE PROPOSED HMA COURSES.
- E. TAPER THE TEMP. RAMP AT A RATE OF 3' - 4" (1.02m) PER 1 INCH (25 mm) OF MILLING THICKNESS.
* SEE TYPICAL SECTIONS FOR MILLING THICKNESS.
- F. SEE ARTICLE 406.08 AND 406.14 OF THE STANDARD SPECIFICATIONS FOR "HMA AND/OR PCC SURFACE REMOVAL - BUTT JOINT".
*** 20'-0" (6.1 m) PER 1 (25) RESURFACING (NOTE "A")
10'-0" (3.0 m) PER 1 (25) RESURFACING (NOTE "B")

BASIS OF PAYMENT

- 1. THE BUTT JOINT WILL BE PAID FOR AT THE CONTRACT UNIT PRICE PER SQUARE YARD (SQUARE METER) FOR "HOT-MIX ASPHALT SURFACE REMOVAL - BUTT JOINT" OR FOR "PORTLAND CEMENT CONCRETE SURFACE REMOVAL - BUTT JOINT".
- 2. THE TEMPORARY RAMP AND SAW CUT SHALL BE INCLUDED IN THE UNIT COST FOR HMA OR PCC SURFACE REMOVAL-BUTT JOINT.

ALL DIMENSIONS ARE IN INCHES (MILLIMETERS) UNLESS OTHERWISE SHOWN.

MODEL: Default
 FILE NAME: \\bl00mngdale\230061\Civ1\DET.230061_002_IDOT01.SHT
 PROJECT: \\bl00mngdale\230061\Civ1\DET.230061_002_IDOT01.SHT

USER NAME = Lawrence,DeManche	DESIGNED - M. DE YONG	REVISED - A. ABBAS 03-21-97
	DRAWN -	REVISED - M. GOMEZ 04-06-01
PLOT SCALE = 100.0000 * / in.	CHECKED -	REVISED - R. BORO 01-01-07
PLOT DATE = 11/18/2022	DATE - 06-13-90	REVISED - K. SMITH 11-18-22

**STATE OF ILLINOIS
DEPARTMENT OF TRANSPORTATION**

**BUTT JOINT AND
HMA TAPER DETAILS**

F.A. RTE.	SECTION	COUNTY	TOTAL SHEETS	SHEET NO.
SCALE: NONE		SHEET 1 OF 1 SHEETS	STA. TO STA.	
BD400-05		BD-32	CONTRACT NO.	
ILLINOIS FED. AID PROJECT				

FILE NAME =	USER NAME = dschroeder	DESIGNED - RML	REVISED -
N:\BL00MNGDALE\230061\Civ1\DET.230061_002_IDOT01.SHT		DRAWN - RML	REVISED -
Default		CHECKED - DJS	REVISED -
	PLOT DATE = 9/4/2023	DATE - 9/4/2023	REVISED -

**STATE OF ILLINOIS
DEPARTMENT OF TRANSPORTATION**

**EDGEWATER DRIVE RESURFACING
IDOT DISTRICT 1 DETAILS**

F.A. RTE.	SECTION	COUNTY	TOTAL SHEETS	SHEET NO.
4120	22-00078-00-RS	DUPAGE	22	16
SCALE: \$SCALE\$		SHEET 2 OF 7 SHEETS	STA. N/A TO STA. N/A	
		CONTRACT NO. 61J77		
ILLINOIS FED. AID PROJECT				

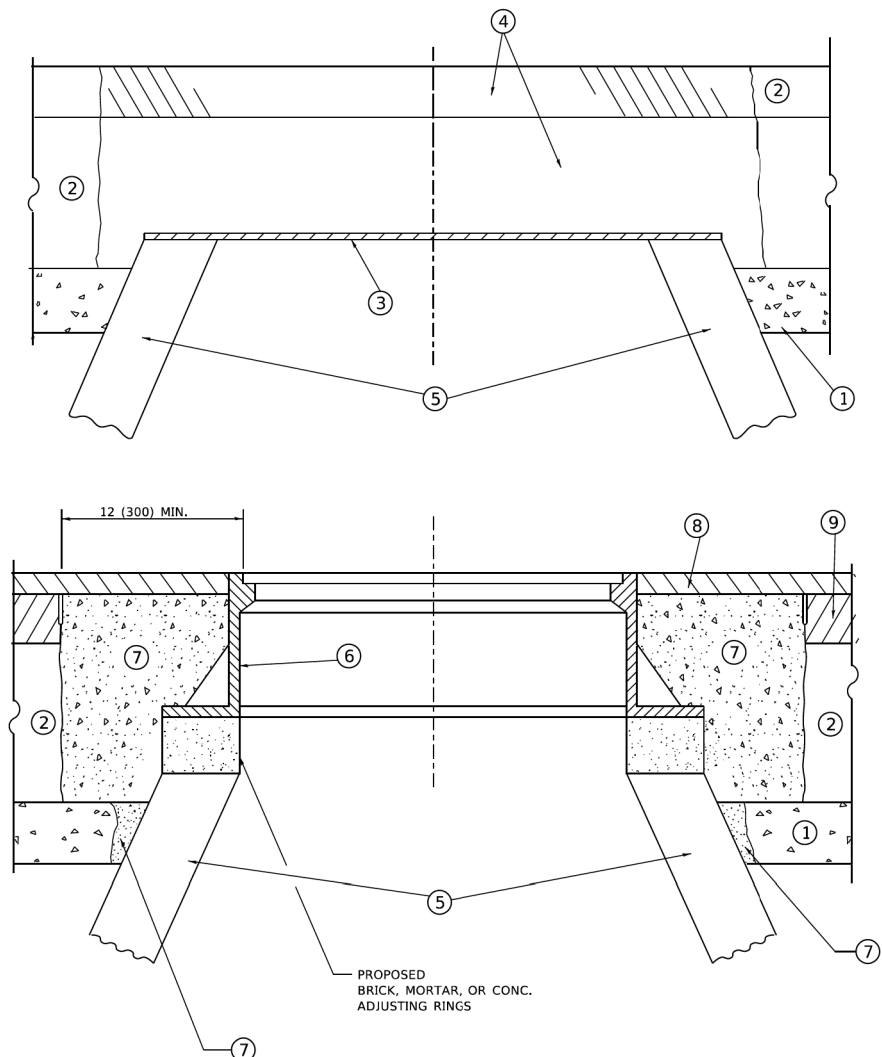

DETAILS FOR FRAMES AND LIDS ADJUSTMENT WITH MILLING

NOTES

1. EXISTING BROKEN FRAMES AND LIDS SHALL BE REMOVED AND DISPOSED OF BY THE CONTRACTOR AND SHALL BE REPLACED AS DIRECTED BY THE ENGINEER. REPLACEMENT FRAMES AND LIDS WILL BE PAID FOR IN ACCORDANCE WITH ARTICLE 109.04 OF THE STANDARD SPECIFICATIONS UNLESS A SEPARATE PAY ITEM HAS BEEN PROVIDED.
2. IF THE EXISTING LIDS ARE OPEN, THE FRAME WILL BE ADJUSTED TO THE ELEVATION OF THE MILLED PAVEMENT SURFACE PRIOR TO THE MILLING OPERATION. THE FRAME WILL NOT BE REMOVED AND COVERED BY THE METAL PLATE.
3. CITY OF CHICAGO CASTINGS ARE THE PROPERTY OF THE CITY AND THE CONTRACTOR SHALL NOTIFY THE CITY FOR REMOVAL AND DISPOSITION OF THE CASTINGS.
4. THE METAL PLATE USED TO COVER THE STRUCTURE SHALL REMAIN THE PROPERTY OF THE CONTRACTOR.

CONSTRUCTION PROCEDURES

- STAGE 1 (BEFORE PAVEMENT MILLING)**
- A) REMOVE A MINIMUM OF 12 (300) OF THE PAVEMENT FROM AROUND THE STRUCTURE.
 - B) REMOVE THE EXISTING FRAME AND LID FROM THE STRUCTURE.
 - C) COVER THE STRUCTURE OPENING WITH A 36 (900) DIAMETER METAL PLATE.
 - D) BACKFILL WITH CRUSHED STONE AND HMA SURFACE MIX APPROVED BY THE ENGINEER. (MIN. 1 1/2 (40) HMA TO REMAIN AFTER MILLING).
- STAGE 2 (AFTER PAVEMENT MILLING)**
- A) REMOVE THE HMA SURFACE MIX AND CRUSHED STONE.
 - B) INSTALL THE FRAME AND LID; ADJUST THE FRAME TO ITS FINAL SURFACE ELEVATION.
 - C) THE SURROUNDING SPACE SHALL BE FILLED WITH CLASS*PP-1 CONCRETE TO THE ELEVATION OF THE SURFACE OF THE EXISTING BASE COURSE OR THE BINDER COURSE.
- * UNLESS OTHERWISE SPECIFIED IN THE PLANS.

THE PROCEDURE EXPLAINED ABOVE SHALL CONFORM TO THE APPLICABLE PORTIONS OF SECTIONS 353, 406, 602, AND 603 OF THE STANDARD SPECIFICATIONS EXCEPT THAT "THE CONTRACTOR SHALL ADJUST THE STRUCTURES TO THE FINISHED PAVEMENT ELEVATION NO MORE THAN 5 CALENDAR DAYS PRIOR TO PLACEMENT OF THE FINAL LIFT OF SURFACE UNLESS APPROVED BY THE ENGINEER."

LEGEND

- | | |
|--|-------------------------------|
| ① SUB-BASE GRANULAR MATERIAL | ⑥ FRAME AND LID (SEE NOTES) |
| ② EXISTING PAVEMENT | ⑦ CLASS*PP-1 CONCRETE |
| ③ 36 (900) DIAMETER METAL PLATE | ⑧ PROPOSED HMA SURFACE COURSE |
| ④ PROPOSED CRUSHED STONE AND HMA SURFACE MIX | ⑨ PROPOSED HMA BINDER COURSE |
| ⑤ EXISTING STRUCTURE | |

LOCATION OF STRUCTURES

THE CONTRACTOR WILL BE REQUIRED TO KEEP A RECORD OF THE LOCATIONS OF THE BURIED STRUCTURES ACCORDING TO THE STATION AND DISTANCE LEFT OR RIGHT OF THE CENTERLINE OF PAVEMENT. UPON COMPLETION OF THE WORK, THE CONTRACTOR WILL DELIVER THE RECORD TO THE ENGINEER.

BASIS OF PAYMENT

1. REMOVING FRAMES AND LIDS ON DRAINAGE AND UTILITY STRUCTURES IN THE PAVEMENT PRIOR TO MILLING, AND ADJUSTING TO FINAL GRADE PRIOR TO PLACING THE SURFACE COURSE, WILL BE PAID FOR AT THE CONTRACT UNIT PRICE EACH FOR "FRAMES AND LIDS TO BE ADJUSTED (SPECIAL)."
2. THIS WORK WILL NOT BE PAID FOR WHEN DRAINAGE AND UTILITY STRUCTURES ARE SPECIFIED FOR PAYMENT AS STRUCTURE RECONSTRUCTION.
3. NEW FRAMES AND LIDS, WHEN SPECIFIED, WILL BE PAID FOR SEPARATELY.
4. WHEN STRUCTURES ARE TO BE ADJUSTED OR RECONSTRUCTED, THE LOWERING AND RAISING OF THE FRAMES AND LIDS WILL NOT BE PAID FOR SEPARATELY BUT WILL BE INCLUDED IN THE COST OF THE CORRESPONDING PAY ITEM.

ALL DIMENSIONS ARE IN INCHES (MILLIMETERS) UNLESS OTHERWISE SHOWN

MODEL: Default
 FILE NAME: \\bl00m\ingdale\230061\Civ1\1\DET.230061_002.IDOTD1.SHT
 PROJECT: \\bl00m\ingdale\230061\Civ1\1\DET.230061_002.IDOTD1.SHT
 OFFICE: \\bl00m\ingdale\230061\Civ1\1\DET.230061_002.IDOTD1.SHT

USER NAME = Lawrence,DeManche	DESIGNED - R. SHAH	REVISED - R. BORO 01-01-07	STATE OF ILLINOIS DEPARTMENT OF TRANSPORTATION	DETAILS FOR FRAMES AND LIDS ADJUSTMENT WITH MILLING		F.A. RTE.	SECTION	COUNTY	TOTAL SHEETS	SHEET NO.
DRAWN -	CHECKED -	REVISED - R. BORO 03-09-11		SCALE: NONE	SHEET 1 OF 1 SHEETS	STA. TO STA.	BD600-03 (BD-08)		CONTRACT NO.	
PLOT SCALE = 100.0000" / in.	DATE - 10-25-94	REVISED - R. BORO 12-06-11								
PLOT DATE = 11/18/2022		REVISED - K. SMITH 11-18-22								

FILE NAME =	USER NAME = dschroeder	DESIGNED - RML	REVISED -	STATE OF ILLINOIS DEPARTMENT OF TRANSPORTATION	EDGEWATER DRIVE RESURFACING IDOT DISTRICT 1 DETAILS		F.A.U RTE.	SECTION	COUNTY	TOTAL SHEETS	SHEET NO.	
N:\BL00M\INGDALE\230061\Civ1\1\DET.230061_002.IDOTD1.SHT		DRAWN - RML	REVISED -		SCALE: \$SCALE\$	SHEET 1 OF 7 SHEETS	STA. N/A TO STA. N/A	4120	22-00078-00-R5	DUPAGE	22	17
Default	PLOT SCALE = 48"	CHECKED - DJS	REVISED -								CONTRACT NO. 61J77	
	PLOT DATE = 9/4/2023	DATE - 9/4/2023	REVISED -								ILLINOIS FED. AID PROJECT	

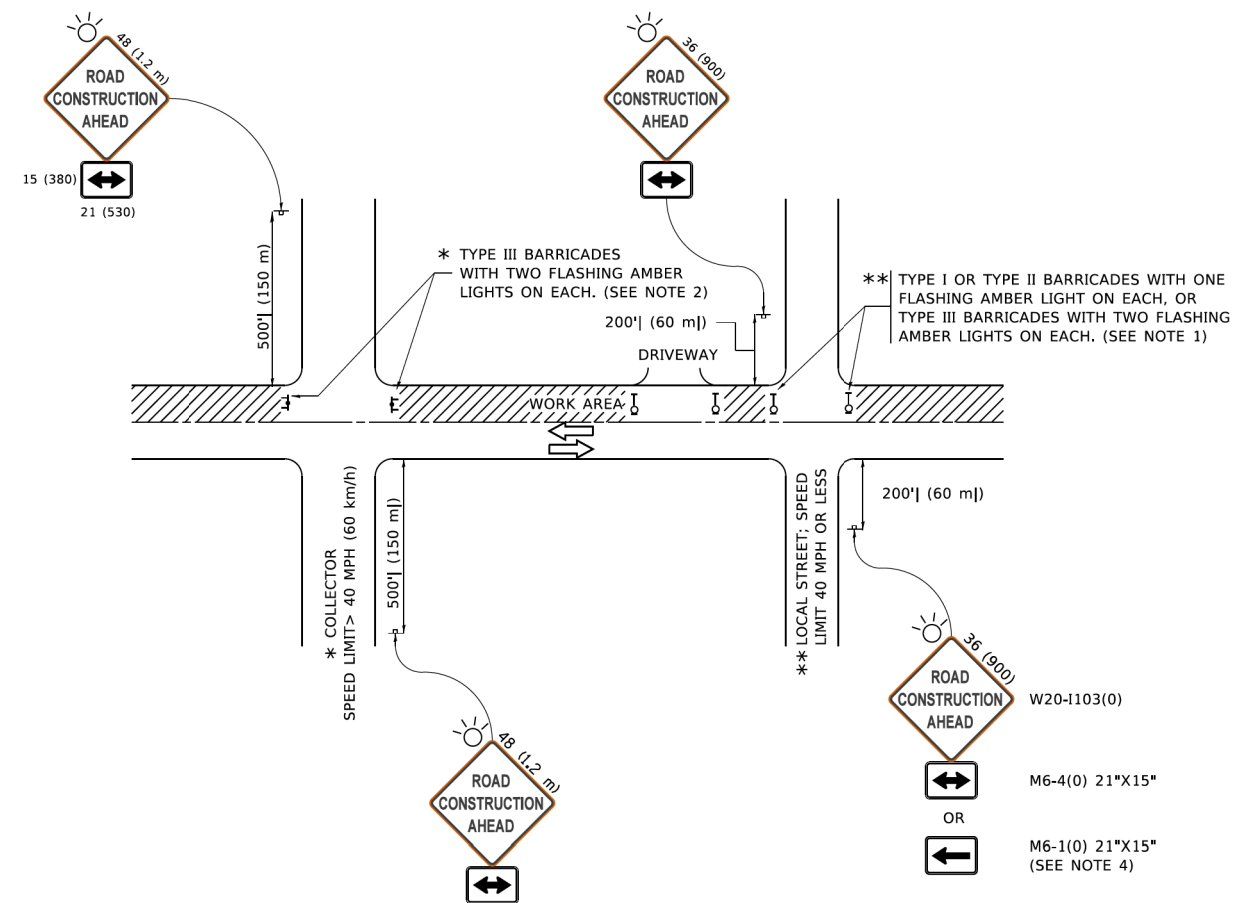

NOTES:

1. SIDE ROAD WITH A SPEED LIMIT OF 40 MPH (60 km/h) OR LESS AS SHOWN ON THE DRAWING AND AS DIRECTED BY THE ENGINEER:
 - a) ONE "ROAD CONSTRUCTION AHEAD" SIGN 36 x 36 (900x900) WITH A FLASHER MOUNTED ON IT APPROXIMATELY 200' (60 m) IN ADVANCE OF THE MAIN ROUTE.
 - b) THE CLOSED PORTION OF THE MAIN ROUTE SHALL BE PROTECTED BY BLOCKING WITH TYPE I, TYPE II OR TYPE III BARRICADES, 1/3 OF THE CROSS SECTION OF THE CLOSED PORTION.
2. SIDE ROAD WITH A SPEED LIMIT GREATER THAN 40 MPH (60 km/h) AS SHOWN ON THE DRAWING AND AS DIRECTED BY THE ENGINEER:
 - a) ONE "ROAD CONSTRUCTION AHEAD" SIGN 48 x 48 (1.2 m x 1.2 m) WITH A FLASHER MOUNTED ON IT APPROXIMATELY 500' (150 m) IN ADVANCE OF THE MAIN ROUTE.
 - b) THE CLOSED PORTION OF THE MAIN ROUTE SHALL BE PROTECTED BY BLOCKING WITH TYPE III BARRICADES, 1/2 OF THE CROSS SECTION OF THE CLOSED PORTION.
3. CONES MAY BE SUBSTITUTED FOR BARRICADES OR DRUMS AT HALF THE SPACING DURING DAY OPERATIONS. CONES SHALL BE A MINIMUM OF 28 (710) IN HEIGHT.
4. SIGNING AND THE WORK ZONE, A SINGLE HEADED ARROW (M6-1) SHALL BE USED IN LIEU OF THE DOUBLE HEADED ARROW (M6-4).
5. WHEN WORK IS BEING PERFORMED ON A SIDE ROAD OR DRIVEWAY, FOLLOW THE APPLICABLE STANDARD(S). THE DIRECTIONAL ARROW (M6-1 OR M6-4) SHALL BE COVERED OR REMOVED WHEN NO LONGER CONSISTENT WITH THE TRAFFIC CONTROL SET-UP.
6. ADVANCE WARNING SIGNS ARE TO BE OMITTED ON DRIVEWAYS UNLESS OTHERWISE SPECIFIED IN THE PLANS OR BY THE ENGINEER.
7. THE TRAFFIC CONTROL AND PROTECTION FOR SIDE ROADS, INTERSECTIONS, AND DRIVEWAYS SHALL BE INCLUDED IN THE COST OF SPECIFIED TRAFFIC CONTROL STANDARDS OR ITEMS.

All dimensions are in inches (millimeters) unless otherwise shown.

MODEL: Default
 FILE NAME: I:\Projects\2023\2023-06-01\Documents\10021\10021_10021.dwg

	USER NAME = footemj	DESIGNED - L.H.A.	REVISED - A. HOUSEH 10-15-96	STATE OF ILLINOIS DEPARTMENT OF TRANSPORTATION	TRAFFIC CONTROL AND PROTECTION FOR SIDE ROADS, INTERSECTIONS, AND DRIVEWAYS	F.A. RTE.	SECTION	COUNTY	TOTAL SHEETS	SHEET NO.	
			REVISOR - T. RAMMACHER 01-06-00								
	PLOT SCALE = 50,0000 ' / in.	CHECKED -	REVISOR - A. SCHUETZE 07-01-13								
	PLOT DATE = 3/4/2019	DATE - 06-89	REVISOR - A. SCHUETZE 09-15-16								
						SCALE: NONE	SHEET 1 OF 1 SHEETS	STA. TO STA.	TC-10 ILLINOIS FED. AID PROJECT		

FILE NAME =	USER NAME = dschroeder	DESIGNED - RML	REVISED -	STATE OF ILLINOIS DEPARTMENT OF TRANSPORTATION	EDGEWATER DRIVE RESURFACING IDOT DISTRICT 1 DETAILS	F.A. RTE.	SECTION	COUNTY	TOTAL SHEETS	SHEET NO.	
			REVISOR -								
	PLOT SCALE = 48"	CHECKED - DJS	REVISOR -								
	PLOT DATE = 9/4/2023	DATE - 9/4/2023	REVISOR -								
						SCALE: \$SCALE\$	SHEET 3 OF 7 SHEETS	STA. N/A TO STA. N/A	CONTRACT NO. 61J77 ILLINOIS FED. AID PROJECT		

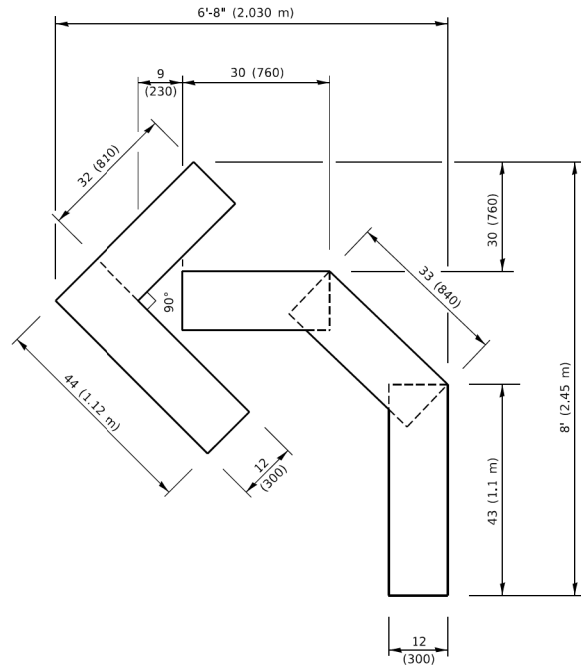

QUANTITY

4 (100) LINE = 45.5 ft. (13.9 m)
15.2 sq. ft. (1.41 sq. m)

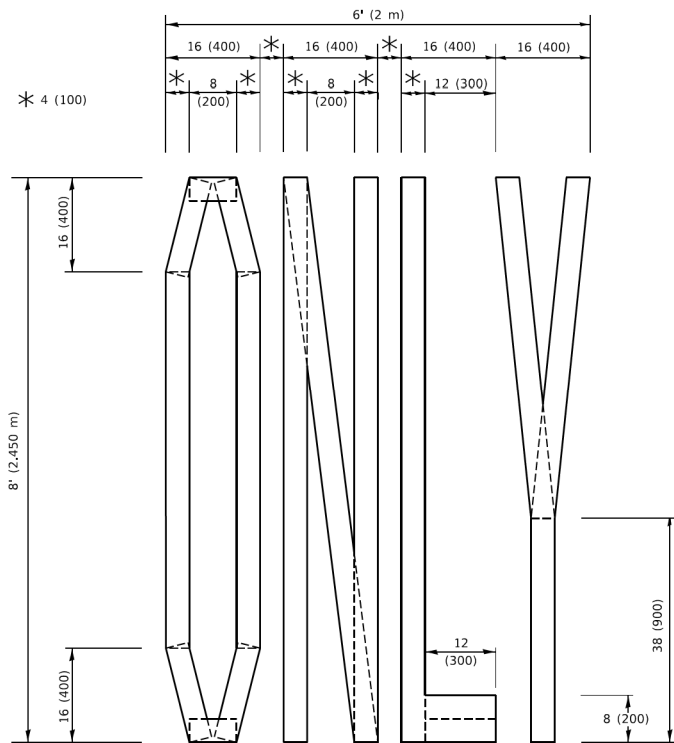

QUANTITY

4 (100) LINE = 64.1 ft. (19.5 m)
21.4 sq. ft. (1.99 sq. m)

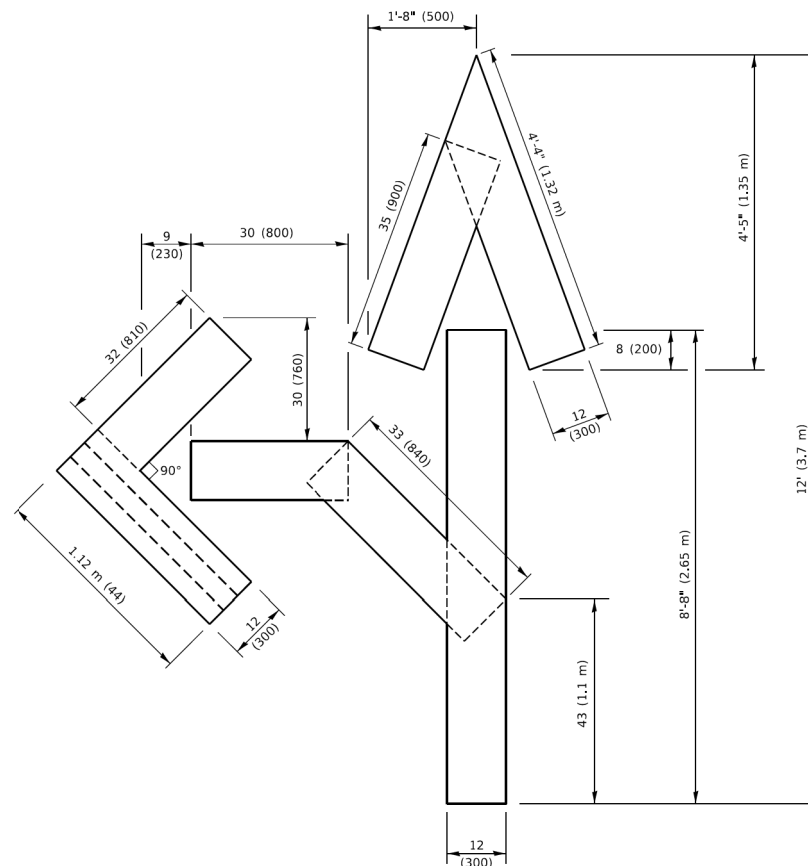

QUANTITY

4 (100) LINE = 82.5 ft. (25.1 m)
27.5 sq. ft. (2.53 sq. m)

NOTE:

ALL QUANTITIES OF PLACEMENT ARE REPRESENTED IN LINEAR FEET OF 4" LINES TO MATCH THE 4" TEMPORARY TAPE PAY ITEM AND REPRESENTS THE TOTAL QUANTITY OF 4" TAPE REQUIRED.

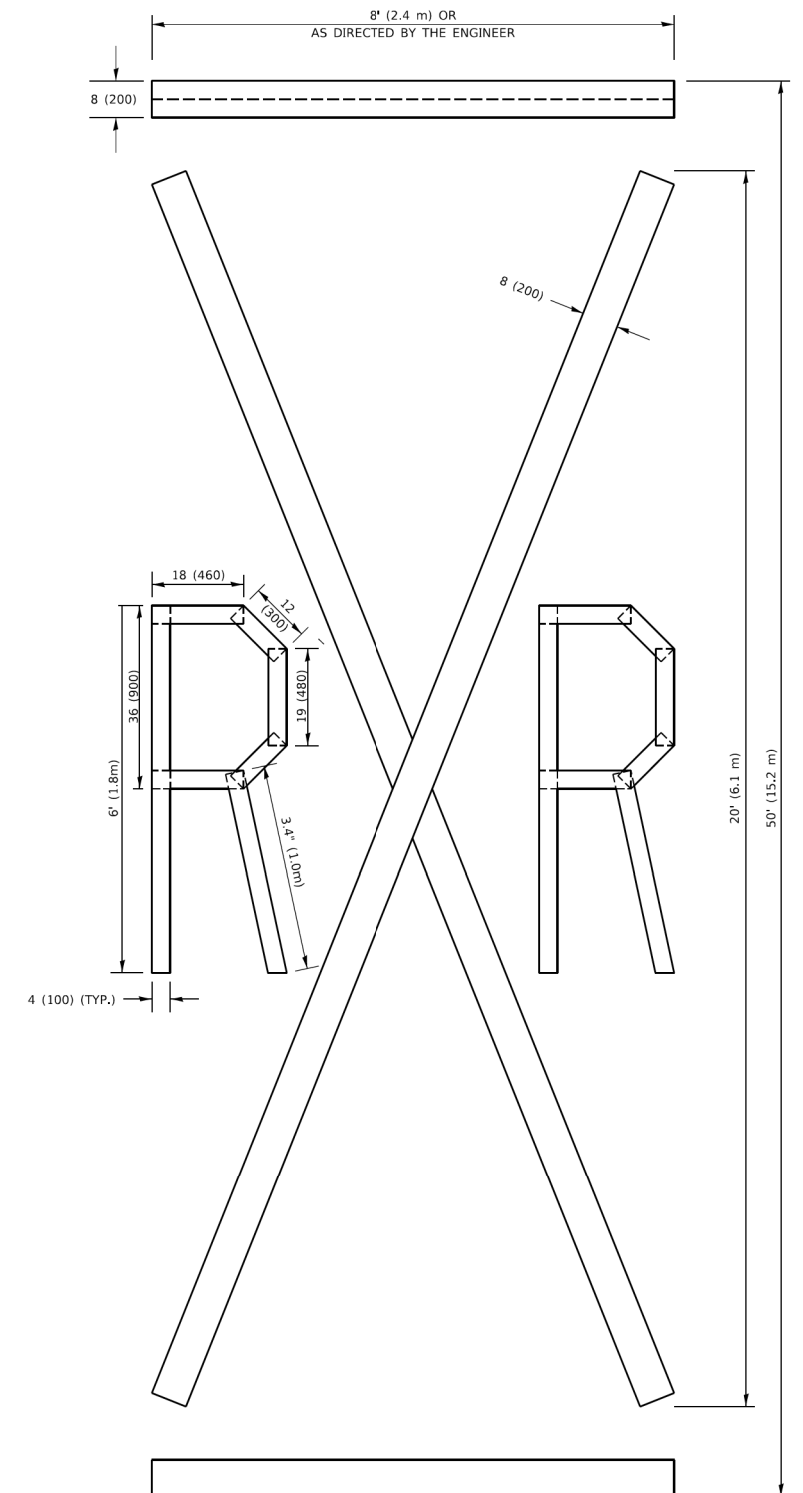

QUANTITY

4 (100) LINE = 225.9 ft. (68.9 m)
75.3 sq. ft. (6.99 sq. m)

All dimensions are in inches (millimeters) unless otherwise shown.

MODEL: DEFNUR
FILE NAME: B:\BLOOMINGDALE\230061\CIVIL\DET\230061_002.IDOTD1.SHT
PROJECT: BLOOMINGDALE\230061\CIVIL\DET\230061_002.IDOTD1.SHT
OFFICE: BLOOMINGDALE

USER NAME = footemj	DESIGNED -	REVISED - T. RAMMACHER 03-02-98
PLOT SCALE = 50.0068' / in.	DRAWN -	REVISED - E. GOMEZ 08-28-00
PLOT DATE = 3/4/2019	CHECKED -	REVISED - E. GOMEZ 08-28-00
	DATE - 09-18-94	REVISED - A. SCHUETZE 09-15-16

**STATE OF ILLINOIS
DEPARTMENT OF TRANSPORTATION**

SHORT TERM PAVEMENT MARKING LETTERS AND SYMBOLS

SCALE: NONE SHEET 1 OF 1 SHEETS STA. TO STA.

F.A.U. RTE.	SECTION	COUNTY	TOTAL SHEETS	SHEET NO.
TC-16			CONTRACT NO.	
ILLINOIS FED. AID PROJECT				

FILE NAME =	USER NAME = dschroeder	DESIGNED - RML	REVISED -
N:\BLOOMINGDALE\230061\CIVIL\DET\230061_002.IDOTD1.SHT		DRAWN - RML	REVISED -
Default		CHECKED - DJS	REVISED -
		DATE - 9/4/2023	REVISED -

**STATE OF ILLINOIS
DEPARTMENT OF TRANSPORTATION**

**EDGEWATER DRIVE RESURFACING
IDOT DISTRICT 1 DETAILS**

SCALE: #SCALE# SHEET 5 OF 7 SHEETS STA. N/A TO STA. N/A

F.A.U. RTE.	SECTION	COUNTY	TOTAL SHEETS	SHEET NO.
4120	22-00078-00-R5	DUPAGE	22	20
CONTRACT NO. 61J77				
ILLINOIS FED. AID PROJECT				

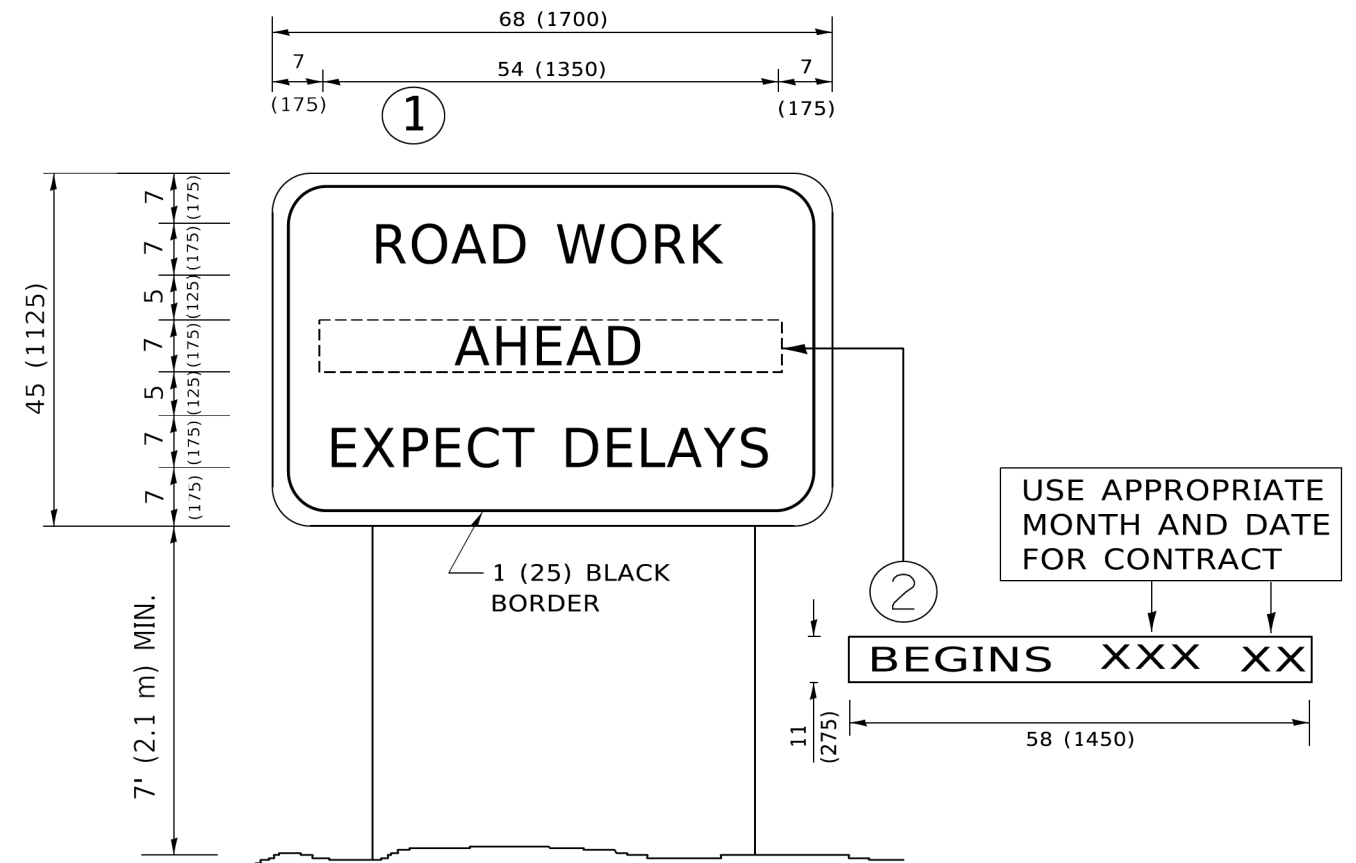

NOTES:

1. USE BLACK LETTERING ON ORANGE BACKGROUND.
2. ERECT SIGNS IN ADVANCE OF THE LOCATION FOR THE "ROAD CONSTRUCTION AHEAD" SIGN AT LOCATIONS AS DIRECTED BY THE ENGINEER.
3. ERECT SIGN ① WITH INSTALLED PANEL ② ONE WEEK PRIOR TO THE START OF CONSTRUCTION.
4. REMOVE PANEL ② SOON AFTER THE START OF CONSTRUCTION.
5. SEE SPECIAL PROVISION FOR "TEMPORARY INFORMATION SIGNING" FOR ADDITIONAL INFORMATION.
6. ONE SIGN ASSEMBLY EQUALS 25.70 SQ. FT. (2.3 SQ. M.)
7. SHALL BE PAID FOR AS TEMPORARY INFORMATION SIGNING.

ALL DIMENSIONS ARE IN INCHES (MILLIMETERS) UNLESS OTHERWISE SHOWN.

MODEL: Default
 FILE NAME: I:\BLOOMINGDALE\230061\Civil\1\DET_230061_002.IDOTD1.SHT
 I:\Projects\Bates\230061\230061_002\230061_002.IDOTD1.SHT

USER NAME = footemj	DESIGNED -	REVISED - R. MIRS 09-15-97
	DRAWN -	REVISED - R. MIRS 12-11-97
PLOT SCALE = 50.0000' / in.	CHECKED -	REVISED - T. RAMMACHER 02-02-99
PLOT DATE = 3/4/2019	DATE -	REVISED - C. JUCIUS 01-31-07

STATE OF ILLINOIS DEPARTMENT OF TRANSPORTATION

ARTERIAL ROAD INFORMATION SIGN		
SCALE: NONE	SHEET 1 OF 1 SHEETS	STA. TO STA.

F.A. RTE.	SECTION	COUNTY	TOTAL SHEETS	SHEET NO.
TC-22			CONTRACT NO.	
ILLINOIS FED. AID PROJECT				

FILE NAME =	USER NAME = dschroeder	DESIGNED - RML	REVISED -
N:\BLOOMINGDALE\230061\Civil\1\DET_230061_002.IDOTD1.SHT		DRAWN - RML	REVISED -
Default		CHECKED - DJS	REVISED -
	PLOT DATE = 9/4/2023	DATE - 9/4/2023	REVISED -

STATE OF ILLINOIS DEPARTMENT OF TRANSPORTATION

EDGEWATER DRIVE RESURFACING IDOT DISTRICT 1 DETAILS		
SCALE: \$SCALE\$	SHEET 6 OF 7 SHEETS	STA. N/A TO STA. N/A

F.A. RTE.	SECTION	COUNTY	TOTAL SHEETS	SHEET NO.
4120	22-00078-00-RS	DUPAGE	22	21
CONTRACT NO. 61J77			ILLINOIS FED. AID PROJECT	

LOOPS NEXT TO SHOULDERS

PROVIDE A PAVEMENT REPLACEMENT NOTE WHICH SHOULD EQUAL 3' (900 mm) X WIDTH OF PAVED SHOULDER.

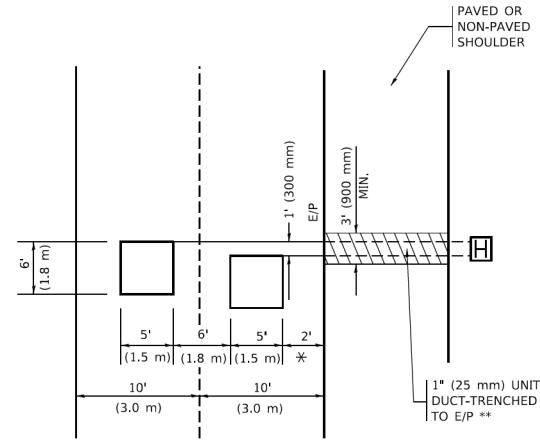

* = (600 mm)

** UNIT DUCT IS TO BE SHOWN ON PLAN SHEETS BUT SHALL NOT BE INCLUDED IN THE PAY ITEMS.

LEFT TURN LANES WITH MEDIANS
VOLUME DENSITY ("FAR OUT" DETECTION)
ON SAME APPROACH
(PROTECTED / PERMITTED LEFT TURN PHASING)

HANDHOLE LOCATION MAY VARY DEPENDING ON GEOMETRICS AND DESIGN OF TRAFFIC SIGNALS. HEAVY-DUTY HANDHOLES TO BE USED WHEN THE MEDIAN IS MOUNTABLE. REFER TO STANDARD 814001 TO ENSURE THAT HANDHOLE FITS IN MEDIAN.

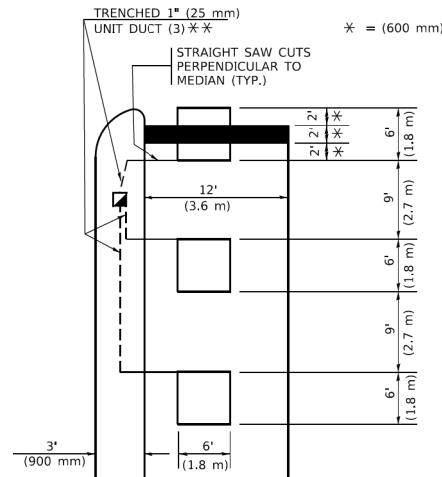

** UNIT DUCT IS TO BE SHOWN ON PLAN SHEETS BUT SHALL NOT BE INCLUDED IN THE PAY ITEMS.

NOTE: DUAL LEFT TURNS NOT SHOWN REFER TO PLAN SHEET FOR DETECTOR LOOP REPLACEMENT

LEFT TURN LANES WITHOUT MEDIANS
VOLUME DENSITY ("FAR OUT" DETECTION)
ON SAME APPROACH
(PROTECTED / PERMITTED LEFT TURN PHASING)

* = (600 mm)

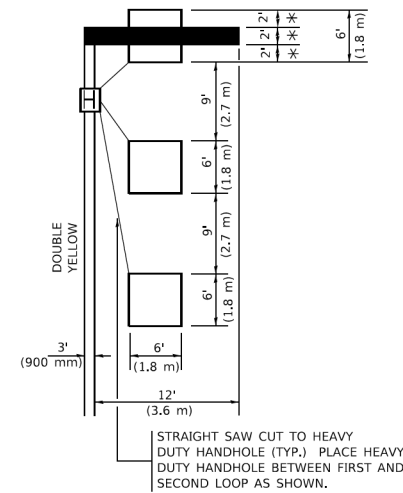

NOTE: DUAL LEFT TURNS NOT SHOWN REFER TO PLAN SHEET FOR DETECTOR LOOP REPLACEMENT

NOTES:

VEHICLES LOOP DETECTORS

- * ALL LEAD IN CABLE SHALL BE TWO CONDUCTOR NO. 14 TWISTED, SHIELDED.
- * EACH DETECTOR LOOP SHALL HAVE ITS OWN SAW CUT FROM THE LOOP TO THE EDGE OF PAVEMENT OR TO A HANDHOLE IN THE PAVEMENT.
- * EACH DETECTOR LOOP SHALL HAVE ITS OWN ONE INCH (25 mm) UNIT DUCT BETWEEN THE EDGE OF PAVEMENT AND THE FIRST HANDHOLE OR JUNCTION BOX. EACH UNIT DUCT RUN SHALL BE SHOWN ON THE PLANS BY THE DESIGNER, BUT SHALL NOT BE PAID FOR SEPARATELY. THIS ITEM IS INCIDENTAL TO THE PAY ITEM FOR DETECTOR LOOPS.
- * ONE DIMENSION OF ALL DETECTOR LOOPS SHALL BE SIX FEET (1.8 m)
- * EACH LANE OF NON-LOCKING, PRESENCE DETECTION AND EACH LANE OF A DOUBLE LEFT TURN LANE REQUIRES A SEPARATE INDUCTIVE LOOP DETECTOR AND LEAD IN CABLE.
- * WHEN NON-LOCKING, PRESENCE DETECTION IS USED, MORE THAN ONE LOOP PER LANE IS REQUIRED BEHIND THE STOP BAR (i.e. 1-1/2, 1-3/4, 2).
- * WHEN SYSTEM LOOPS ARE REQUIRED ON AN APPROACH OF AN INTERSECTION, THE LOOPS USED FOR VOLUME DENSITY AND INTERSECTION TIMING SHALL ALSO BE USED AS SYSTEM DETECTORS. EACH ONE OF THESE TYPE OF LOOPS REQUIRES A SEPARATE TWO CONDUCTOR NO. 14 TWISTED SHIELDED CABLE AND A SEPARATE INDUCTIVE LOOP DETECTOR WHEN NEW CONTROLLERS ARE UTILIZED. THE DESIGNER SHALL LABEL THESE TYPES OF LOOPS AS "INTERSECTION AND SAMPLING (SYSTEM) DETECTORS" ON THE SIGNAL LAYOUT, THE INTERCONNECT PLAN AND THE SYSTEM CABLE PLAN. WHEN AN EXISTING CONTROLLER IS UTILIZED FOR THIS TYPE OF DETECTION, THE PAY ITEM "INDUCTIVE LOOP DETECTOR WITH SYSTEM OUTPUT" SHOULD BE USED.

ARTERIAL-VOLUME DENSITY ("FAR OUT" DETECTION)
CROSS STREET-NON VOLUME DENSITY ("FAR OUT" DETECTION)

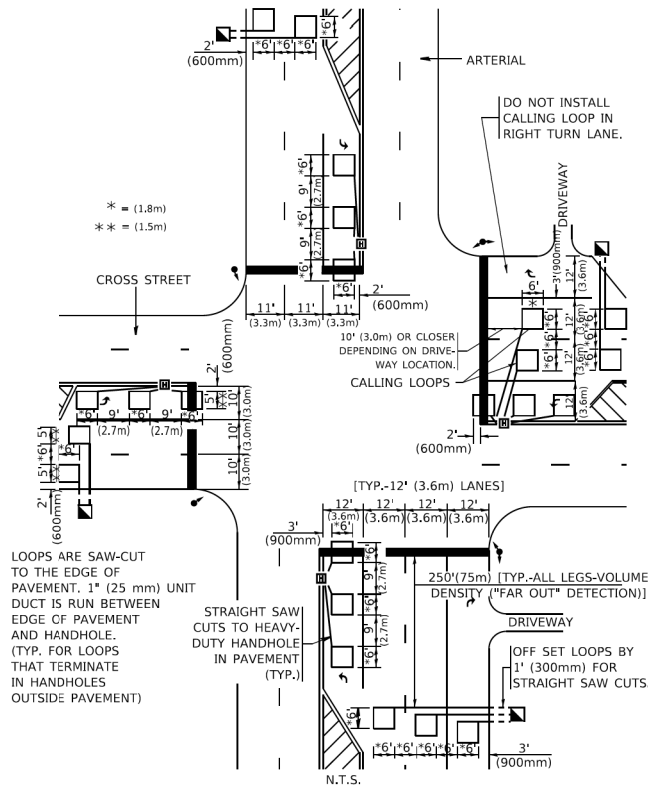

DETAIL 1
N.T.S.

ARTERIAL-VOLUME DENSITY ("FAR OUT" DETECTION)
CROSS STREET-NON VOLUME DENSITY ("UPTIGHT" PRESENCE DETECTION)

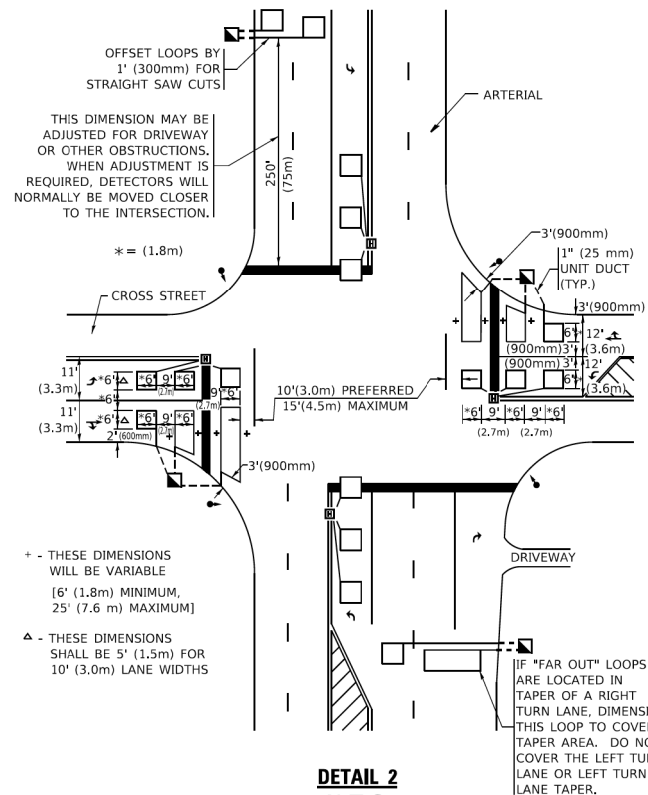

DETAIL 2
N.T.S.

PLACEMENT OF DETECTORS

THE FOLLOWING FIGURES REPRESENT THE MOST COMMON DETECTOR LOOP LOCATIONS AND SIZES. ADJUSTMENTS WILL BE NECESSARY FOR SPECIFIC GEOMETRIC CONSIDERATIONS.

LOCATIONS AND DIMENSIONS OF DETECTOR LOOPS ARE REQUIRED ON ALL SIGNAL LAYOUT PLAN SHEETS.

"FAR OUT" DETECTION REFERS TO LOCKING, PRESENCE TYPE DETECTION LOCATED IN THRU LANES, RIGHT TURN LANES, AND RIGHT TURN LANE TAPER AREAS (IF APPLICABLE), USUALLY 250' (75 m) IN ADVANCE OF STOP BARS. "UPTIGHT" DETECTION REFERS TO NON-LOCKING PRESENCE TYPE DETECTION LOCATED IN ALL LANES AND 10'-15' (3.0 m-4.5 m) BEHIND THE CROSSING STREET'S EDGE OF PAVEMENT EXTENDED.

NOTE:

ALL DETAILS AND NOTES SHOWN ARE FROM THE I.D.O.T. DISTRICT 1 TRAFFIC SIGNAL DESIGN GUIDELINES DATED JANUARY 1995

THIS DRAWING HAS BEEN PREPARED TO ASSIST THE RESIDENT ENGINEER FOR ALL ROADWAY RESURFACING OR S.M.A.R.T. PROJECTS WHERE THE DIMENSIONS ARE NOT SHOWN ON THE PLANS AND THE FINAL LOCATIONS FOR CROSSWALKS OR STOP BARS ARE NOT DETERMINED.

MODEL: Default
 FILE NAME: I:\projects\2019\DOT Documents\DOT - Office\Urban\1\Projects\Signal\23-11\CAD\Signal\CD\sheet1.dgn

USER NAME = footemj	DESIGNED -	REVISED -
PLOT SCALE = 50.0000' / in.	CHECKED - R.K.F.	REVISED -
PLOT DATE = 3/4/2019	DATE -	REVISED -

STATE OF ILLINOIS DEPARTMENT OF TRANSPORTATION	
---	--

DISTRICT 1 - DETECTOR LOOP INSTALLATION DETAILS FOR ROADWAY RESURFACING	
SCALE: NONE	SHEET 1 OF 1 SHEETS STA. TO STA.

F.A.U. RTE.	SECTION	COUNTY	TOTAL SHEETS	SHEET NO.
TS-07			CONTRACT NO.	
ILLINOIS FED. AID PROJECT				

FILE NAME =	USER NAME = dschroeder	DESIGNED - RML	REVISED -
N:\BLOOMINGDALE\230061\Civ1\DET. 230061_002.IDOT01.SHT		DRAWN - RML	REVISED -
Default		CHECKED - DJS	REVISED -
		DATE - 9/4/2023	REVISED -

STATE OF ILLINOIS DEPARTMENT OF TRANSPORTATION	
---	--

EDGEWATER DRIVE RESURFACING IDOT DISTRICT 1 DETAILS	
SCALE: \$SCALE\$	SHEET 7 OF 7 SHEETS STA. N/A TO STA. N/A

F.A.U. RTE.	SECTION	COUNTY	TOTAL SHEETS	SHEET NO.
4120	22-00078-00-R5	DUPAGE	22	22
CONTRACT NO. 61J77				
ILLINOIS FED. AID PROJECT				