

CONSTRUCTION PLANS

RECONSTRUCT AUTO PARKING LOT AND AIRCRAFT HANGAR ACCESS PAVEMENTS

**AIRPORT AUTHORITY OF FLORA
FLORA MUNICIPAL AIRPORT (FOA)
FLORA, CLAY COUNTY, ILLINOIS**

IDA PROJECT NO. FOA-4986

**100% SUBMITTAL
SEPTEMBER 22, 2023**

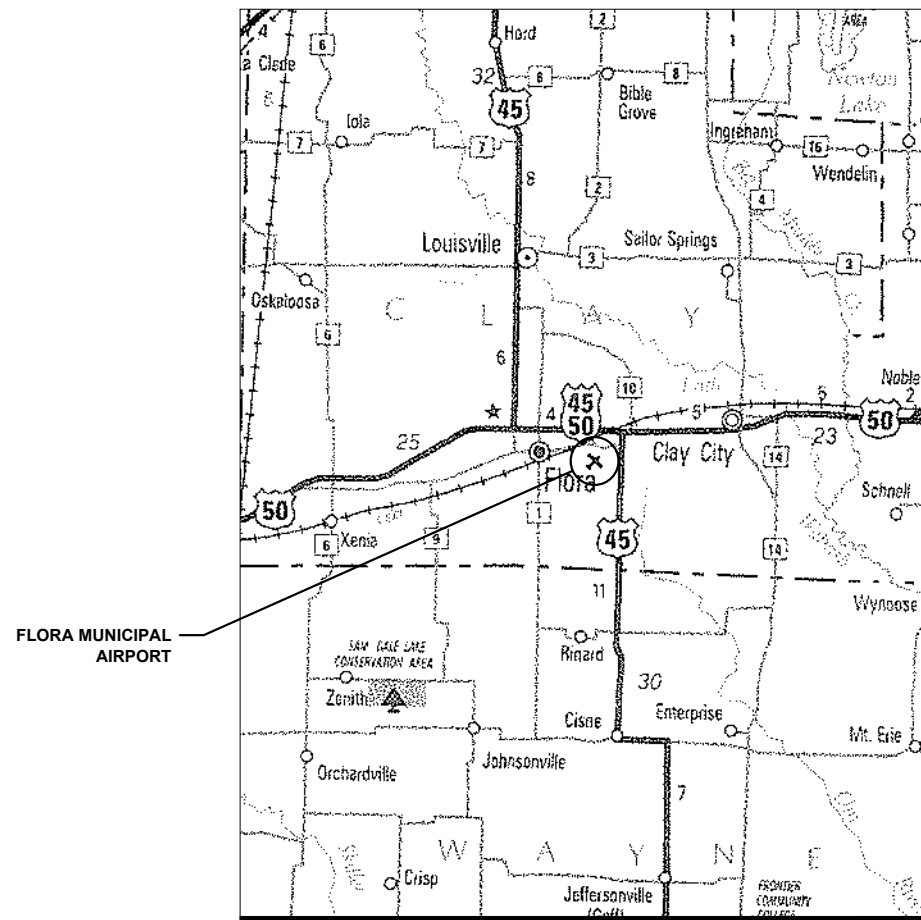

VICINITY MAP

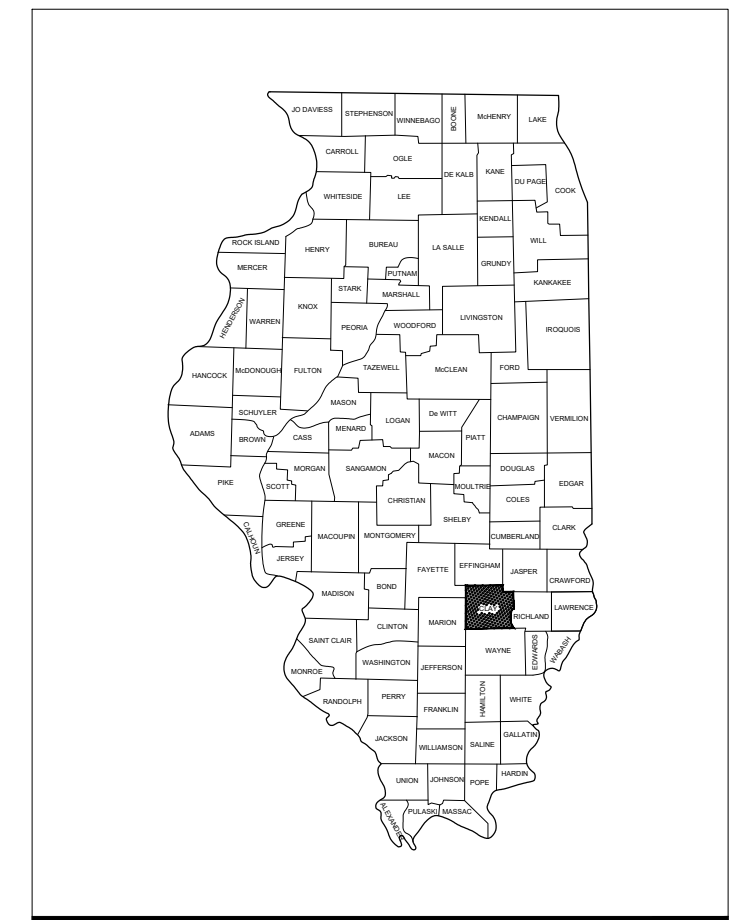

LOCATION MAP

NOTICE TO CONTRACTORS AND BIDDERS

THESE CONSTRUCTION PLANS RELY UPON THE SPECIAL PROVISIONS TO PROVIDE FOR A COMPLETE DESCRIPTION OF THE WORK AND CONSTRUCTION REQUIREMENTS. THE PLANS SHALL ONLY BE USED IN COMBINATION WITH ALL CONTRACT DOCUMENTS.

No.	Issue/Description	Sheets Changed	Date	By

HANSON
HANSON PROFESSIONAL SERVICES INC.
1525 S. Sixth St.
Springfield, Illinois 62703
Telephone: 217.788.2450
Fax: 217.788.2503

Lindsay Hausman
Lindsay D Hausman, P.E. Lic. Exp. 11/30/2023
Project Manager



9/22/23 Date

FLORA MUNICIPAL AIRPORT
1 Airport Toad
Flora, Illinois 62839
Telephone: 618.662.2823

Karen Pickel

Karen Pickel
Airport Manager

9/22/23 Date

INDEX TO SHEETS	
SHEET NUMBER	SHEET TITLE
1	COVER SHEET
2	SUMMARY OF QUANTITIES AND INDEX OF SHEETS
3	CONSTRUCTION SAFETY PHASING PLAN - PHASE 1
4	CONSTRUCTION SAFETY PHASING PLAN - PHASE 2
5	SAFETY NOTES AND DETAILS
6	PROPOSED ALIGNMENT GEOMETRICS PLAN
7	EXISTING CONDITIONS DEMOLITION PLAN - PARKING LOT
8	EXISTING CONDITIONS DEMOLITION PLAN - HANGAR ACCESS
9	PROPOSED GRADING PLAN - PARKING LOT
10	PROPOSED GRADING PLAN - HANGAR ACCESS
11	TYPICAL PAVEMENT SECTIONS
12	STORM WATER POLLUTION PREVENTION PLAN DETAILS
13	PROPOSED CONSTRUCTION PLAN - PARKING LOT
14	PROPOSED CONSTRUCTION PLAN - HANGAR ACCESS
15	PROPOSED PCC JOINTING PLAN
16	PROPOSED JOINT DETAILS
17	REFUSE DISPOSAL AREA DETAILS
18	PROPOSED MARKING PLAN
19	PROPOSED MARKING AND SIGN DETAILS
20	TRENCH DRAIN, UNDERDRAIN DETAILS, AND DRAINAGE SCHEDULE

SUMMARY OF QUANTITIES - BASE BID				
ITEM NO.	DESCRIPTION	UNIT	TOTAL QUANTITY	AS-BUILT QUANTITY
AR108962	REPLACE CABLE	FOOT	105	
AR110117	1 1/2" PVC DUCT, DIRECT BURY	FOOT	100	
AR125901	REMOVE STAKE MOUNTED LIGHT	EACH	1	
AR150510	ENGINEER'S FIELD OFFICE	L SUM	1	
AR150520	MOBILIZATION	L SUM	1	
AR152511	SUBGRADE REPAIR	SQ YD	50	
AR156510	SILT FENCE	FOOT	76	
AR156520	INLET PROTECTION	EACH	5	
AR209604	CRUSHED AGG. BASE COURSE-4"	SQ YD	137	
AR401900	REMOVE BITUMINOUS PAVEMENT	SQ YD	1,873	
AR501506	6" PCC PAVEMENT	SQ YD	97	
AR501605	5" PCC SIDEWALK	SQ FT	349	
AR501900	REMOVE PCC PAVEMENT	SQ YD	508	
AR620520	PAVEMENT MARKING-WATERBORNE	SQ FT	725	
AR620525	PAVEMENT MARKING-BLACK BORDER	SQ FT	190	
AR701900	REMOVE PIPE	FOOT	38	
AR705944	ADJUST UNDERDRAIN CLEANOUT	EACH	3	
AR751001	TRENCH DRAIN	FOOT	16	
AR760810	WATER METER	EACH	1	
AR800925	HDPE PIPE CULVERT	FOOT	50	
AR901510	SEEDING	ACRE	0.13	
AR905530	TOPSOILING	SQ YD	622	
AR908510	MULCHING	ACRE	0.13	
AR910230	HANDICAP SIGN	EACH	2	
AR910410	PARKING BLOCK	EACH	16	
AR910415	REMOVE PARKING BLOCK	EACH	7	
AR910420	BOLLARD	EACH	2	
AR910425	REMOVE BOLLARD	EACH	3	

SUMMARY OF QUANTITIES - ALTERNATE A				
ITEM NO.	DESCRIPTION	UNIT	TOTAL QUANTITY	AS-BUILT QUANTITY
AS152410	UNCLASSIFIED EXCAVATION	CU YD	944	
AS209608	CRUSHED AGGREGATE BASE COURSE-8"	SQ YD	3,806	
AS401613	BIT. SURF. CSE. -METHOD I, SUPERPAVE	TON	503.0	
AS403613	BIT. BASE COURSE-METHOD I SUPERPAVE	TON	465.0	
AS602510	BITUMINOUS PRIME COAT	GALLON.	1,145	
AS603510	BITUMINOUS TACK COAT	GALLON.	570	

SUMMARY OF QUANTITIES - ALTERNATE B				
ITEM NO.	DESCRIPTION	UNIT	TOTAL QUANTITY	AS-BUILT QUANTITY
AT152410	UNCLASSIFIED EXCAVATION	CU YD	682	
AT209604	CRUSHED AGGREGATE BASE COURSE-4"	SQ YD	3,821	
AT501506	6" PCC PAVEMENT	SQ YD	3,821	
AT501530	PCC TEST BATCH	EACH	1	

GENERAL NOTES

- THE PROJECT PAY ITEMS ARE INTENDED TO BE INCLUSIVE OF ALL WORK TO BE PERFORMED AS SHOWN IN THESE PLANS. ALL INCIDENTAL WORK REQUIRED TO COMPLETE THE PROJECT TO THE SATISFACTION OF THE RESIDENT ENGINEER IS TO BE INCLUDED IN THE COSTS OF PERFORMING THESE ITEMS. THE CONTRACTOR SHALL FURNISH ALL LABOR, MATERIAL, EQUIPMENT, AND TRANSPORTATION NECESSARY TO CONSTRUCT ALL ELEMENTS OF THE PROJECT AS DESCRIBED IN THE CONSTRUCTION PLANS AND SPECIFICATIONS.
- THE RULES, REGULATIONS, AND SPECIFICATIONS ENUMERATED HEREIN SHALL BE CONSIDERED AS MINIMUM REQUIREMENTS. THEY SHALL NOT PROHIBIT THE CONTRACTOR FROM FURNISHING AND INSTALLING HIGHER GRADES OF MATERIAL THAN ARE SPECIFIED HEREIN, IF APPROVED BY THE ENGINEER.
- ACCESS TO THE SITE SHALL BE RESTRICTED EXCLUSIVELY TO THE DESIGNATED CONSTRUCTION ENTRANCE, STAGING AREA, AND HAUL ROUTE. NO EQUIPMENT OR PERSONNEL SHALL BE PERMITTED OUTSIDE THE GENERAL PROJECT AREA.
- IT SHALL BE THE RESPONSIBILITY OF THE CONTRACTOR TO PROTECT AND KEEP CLEAN OF DEBRIS ALL EXISTING AIRFIELD AND ROADWAY PAVEMENTS AT ALL TIMES. ANY DAMAGE TO EXISTING ELECTRICAL, DRAINAGE, AND PAVEMENT STRUCTURES SHALL BE IMMEDIATELY REPAIRED AT NO ADDITIONAL COST TO THE CONTRACT.
- CONTRACTOR IS REQUIRED TO PROVIDE THEIR OWN RESTROOM FACILITIES.
- THE OWNER SHALL HAVE THE RIGHT OF FIRST REFUSAL FOR ALL SALVAGEABLE MATERIAL REMOVED ON THE PROJECT.
- THE CONTRACTOR SHALL BE RESPONSIBLE FOR OBTAINING PERMITS FOR HAULING ON PUBLIC ROADS, AS APPLICABLE. THE CONTRACTOR SHALL BE RESPONSIBLE FOR CORRECTING ANY DAMAGES TO ANY PAVEMENTS (PUBLIC OR PRIVATE) CAUSED BY HIS/HER CONSTRUCTION EQUIPMENT OR PERSONNEL.
- THE CONTRACTOR SHALL PROVIDE ONE SET OF PRELIMINARY REDLINED RECORD DRAWINGS TO THE RESIDENT ENGINEER AT THE COMPLETION OF THE PROJECT FOR INCORPORATION INTO THE OFFICIAL RECORD DRAWINGS HE WILL PREPARE.
- APPROXIMATE LOCATIONS OF UNDERGROUND UTILITIES ARE SHOWN THROUGHOUT THESE PLANS. THE CONTRACTOR SHALL DETERMINE EXACT LOCATIONS AND PROTECT THESE UTILITIES DURING CONSTRUCTION. ANY UTILITIES DAMAGED DURING CONSTRUCTION SHALL BE REPAIRED AT THE CONTRACTOR'S EXPENSE. CONTRACTOR SHALL COORDINATE WITH THE PROPER AUTHORITIES FOR THE PURPOSE OF LOCATING AND PROTECTING EXISTING UNDERGROUND UTILITIES.
- THE CONTRACTOR SHALL PROVIDE ALL LAYOUT NEEDS, BOTH VERTICALLY AND HORIZONTALLY.
- ALL REQUESTS FOR INFORMATION SHALL BE PROVIDED IN WRITING AND ALL DIRECTIVES SHALL BE RECEIVED IN WRITING.
- CHANGES TO THE PROJECT SHALL NOT BE INCORPORATED INTO THE PROJECT UNTIL EXPRESSLY APPROVED BY THE ENGINEER.
- NPDES PERMIT - THIS PROJECT WILL NOT DISTURB MORE THAN 1 ACRE, THEREFORE A NPDES PERMIT IS NOT REQUIRED.
- MATERIAL CERTIFICATIONS - MATERIALS CANNOT BE INSTALLED UNTIL ALL THE MATERIAL CERTIFICATIONS FOR THAT ITEM HAVE BEEN RECEIVED, REVIEWED AND ACCEPTED BY THE RESIDENT ENGINEER. MATERIALS INSTALLED WITHOUT APPROVAL ARE SUBJECT TO REMOVAL AND REPLACEMENT AT THE CONTRACTOR'S EXPENSE.
- CERTIFIED PAYROLLS - PAY APPLICATIONS CANNOT BE PROCESSED FOR PAYMENT UNTIL ALL CERTIFIED PAYROLLS FOR THAT PERIOD HAVE BEEN RECEIVED.

UTILITY NOTE

THE LOCATION, SIZE, AND TYPE OF MATERIAL OF EXISTING UNDERGROUND AND/OR ABOVEGROUND UTILITIES INDICATED ON THE PLANS ARE NOT REPRESENTED AS BEING ACCURATE, SUFFICIENT OR COMPLETE. NEITHER THE OWNER NOR THE ENGINEER ASSUMES ANY RESPONSIBILITY WHATEVER IN RESPECT TO THE ACCURACY, COMPLETENESS, OR SUFFICIENCY OF THE INFORMATION. THERE IS NO GUARANTEE, EITHER EXPRESSED OR IMPLIED, THAT THE LOCATIONS, SIZE AND TYPE OF MATERIAL OF EXISTING UNDERGROUND UTILITIES INDICATED ARE REPRESENTATIVE OF THOSE TO BE ENCOUNTERED IN THE CONSTRUCTION. IT SHALL BE THE CONTRACTOR'S RESPONSIBILITY TO DETERMINE THE ACTUAL LOCATION OF ALL SUCH FACILITIES, INCLUDING SERVICE CONNECTIONS TO UNDERGROUND UTILITIES. PRIOR TO CONSTRUCTION, THE CONTRACTOR SHALL NOTIFY THE UTILITY COMPANIES OF HIS OPERATIONAL PLANS AND SHALL OBTAIN FROM THE RESPECTIVE UTILITY COMPANIES DETAILED INFORMATION AND ASSISTANCE RELATIVE TO THE LOCATION OF THEIR FACILITIES AND THE WORKING SCHEDULE OF THE COMPANIES FOR REMOVAL OR ADJUSTMENT WHERE REQUIRED. IN THE EVENT AN UNEXPECTED UTILITY INTERFERENCE IS ENCOUNTERED DURING CONSTRUCTION, THE CONTRACTOR SHALL IMMEDIATELY NOTIFY THE UTILITY COMPANY OF JURISDICTION. THE OWNER'S REPRESENTATIVE AND/OR THE RESIDENT ENGINEER SHALL ALSO BE IMMEDIATELY NOTIFIED. ANY DAMAGE TO SUCH MAINS AND SERVICES SHALL BE RESTORED TO SERVICE AT ONCE AND PAID FOR BY THE CONTRACTOR AT NO ADDITIONAL COST TO THE CONTRACT. ALL UTILITY CABLES AND LINES SHALL BE LOCATED BY THE RESPECTIVE UTILITY. CONTACT JULIE (JOINT UTILITY LOCATION INFORMATION FOR EXCAVATORS) FOR UTILITY INFORMATION, PHONE: 1-800-892-0123. CONTACT THE FAA (FEDERAL AVIATION ADMINISTRATION) FOR ASSISTANCE IN LOCATING FAA CABLES AND UTILITIES. LOCATION OF FAA POWER, CONTROL, AND COMMUNICATION CABLES SHALL BE COORDINATED WITH AND/OR LOCATED BY THE FAA. ALSO CONTACT AIRPORT DIRECTOR/MANAGER AND AIRPORT PERSONNEL FOR ASSISTANCE IN LOCATING UNDERGROUND AIRPORT CABLES AND/OR UTILITIES. ALSO COORDINATE WORK WITH ALL ABOVEGROUND UTILITIES.

J.U.L.I.E. INFORMATION

COUNTY _____ CLAY
 CITY _____ FLORA
 TOWNSHIP _____ STANFORD
 SECTION NO. _____ 29
 ADDRESS _____ FLORA MUNICIPAL AIRPORT
 1 AIRPORT ROAD
 FLORA, ILLINOIS 62839



Offices Nationwide
 www.hanson-inc.com

Hanson Professional Services Inc.
 1525 S. 6th Street
 Springfield, IL 62568
 phone: 217-788-2450
 fax: 217-788-2503

Illinois Licensed
 Professional Service Corporation
 #184-001084

FLORA MUNICIPAL AIRPORT

1 AIRPORT ROAD
 FLORA, ILLINOIS 62839



Lindsay Hausman

DATE SIGNED: 9/22/2023 LICENSE EXPIRES: 11/30/2023

RECONSTRUCT AUTO PARKING LOT AND AIRCRAFT HANGAR ACCESS PAVEMENT

IDA No: FOA-4986

NO.	DATE	DESCRIPTION		
		DES	DWN	REV

ISSUE: SEPTEMBER 22, 2023
 PROJECT NO: 22A0007D
 CAD FILE: G-002-SQ.DWG
 DESIGN BY: MJD 7/28/2023
 DRAWN BY: CWS 7/28/2023
 REVIEWED BY: LDH 9/22/2023

SHEET TITLE

SUMMARY OF QUANTITIES AND INDEX OF SHEETS

FOR BID

OCT 17, 2023 5:37 PM HAUSMAN00682 1:22 JOBS\22A0007D\CAD\AIRPORT\SHHEETC-002-SQ.DWG



Lindsay Hausman

RECONSTRUCT AUTO PARKING LOT AND AIRCRAFT HANGAR ACCESS PAVEMENT

IDA No: FOA-4986

NO.	DATE	DESCRIPTION

ISSUE: SEPTEMBER 22, 2023

PROJECT NO: 22A0007D

CAD FILE: G-003-SFY.DWG

DESIGN BY: MJD 7/28/2023

DRAWN BY: CWS 7/28/2023

REVIEWED BY: LDH 9/22/2023

SHEET TITLE

CONSTRUCTION SAFETY PHASING PLAN - PHASE 1

PHASE 1

- THE PROPOSED SAFETY PLAN WILL GOVERN WHEN WORK IS BEING COMPLETED IN THE SHADED REGIONS SHOWN ON THE PLANS.
- PHASE 1 INCLUDES RECONSTRUCTING THE EXISTING PARKING LOT.
 - FULL DEPTH REMOVAL OF EXISTING PAVEMENT AND REPLACEMENT
 - ALTERNATE A - BITUMINOUS PAVEMENT
 - ALTERNATE B - PCC PAVEMENT
 - DRAINAGE IMPROVEMENTS
 - GRADING
 - REMOVING A 16-INCH CMP CULVERT
 - INSTALLING A HDPE CULVERT
 - INSTALLING A TRENCH DRAIN
 - UTILITY IMPROVEMENTS
 - INSTALLING A NEW "WATER METER" BASIN AND CAST IRON SOLID LID FOR TWO WATER SHUT-OFFS.
 - ADJUSTING CLEANOUTS AND INSTALLING FRAMES AND LIDS
 - BURYING CONDUIT THAT IS CURRENTLY EXPOSED ABOVE GRADE.
 - REFUSE DISPOSAL AREA / DUMPSTER PAD
 - INSTALLING PCC PAD AND BOLLARDS
 - LANDSCAPING ITEMS
 - REMOVING AGGREGATE AND UNSUITABLE TOPSOIL AND REPLACING WITH ON-SITE AND OFF-SITE SUITABLE MATERIAL.
 - SEEDING AND MULCHING
 - PAVEMENT MARKING & MISCELLANEOUS
 - INSTALLING HANDICAP SIGNS AND PARKING BLOCKS
 - RELOCATING MAILBOX (INCIDENTAL)

CLOSURES

- NO AIRFIELD CLOSURES

PHASE TRANSITION

- THE CONTRACTOR WILL CONTACT THE AIRPORT A MINIMUM OF 7 DAYS BEFORE THE DESIRED INITIATION DATE OF WORK IN EACH WORK AREA, AND KEEP THE AIRPORT APPRISED OF ANY CHANGES TO THE PROJECT SCHEDULE, BOTH IMMEDIATE AND OVERALL.
- THE CONTRACTOR SHALL PROVIDE A MINIMUM OF 72 HOURS NOTICE TO AIRPORT OPERATIONS PRIOR TO THE REQUESTED CLOSURE OF ANY TAXIWAYS OR RUNWAYS. THE AIRPORT HAS FINAL AUTHORITY ON DETERMINING CLOSURE DATES AND TIMES OF AIRFIELD PAVEMENTS.
- PRIOR TO REMOVING ANY BARRICADES AND REOPENING ANY PAVEMENTS, THE CONTRACTOR SHALL THOROUGHLY CLEAN AND INSPECT THE AREA.

FLAGGER NOTES

- RADIO CONTROL - THE CONTRACTOR WILL BE REQUIRED TO BE IN TWO-WAY RADIO CONTACT (122.70 MHz.) WITH THE AIRPORT UNICOM. THIS WILL KEEP THE CONTRACTOR IN CONSTANT CONTACT WITH THE FLORA AIRPORT AND ENABLE THE AIRPORT TO IMMEDIATELY CONTACT THE CONTRACTOR IN CASE OF AN AERONAUTIC EMERGENCY THAT WOULD REQUIRE ACTION BY THE CONTRACTOR AND/OR HIS PERSONNEL.

CRITICAL POINTS						
POINT #	LATITUDE	LONGITUDE	DESCRIPTION	ELEV	OBJECT HEIGHT (FT)	OBJECT ELEV
1	038° 40' 08.14"	-088° 27' 08.05"	STAGING AREA	471.1	25	496.1
2	038° 40' 04.93"	-088° 27' 06.30"	EQUIPMENT	467.8	25	492.6

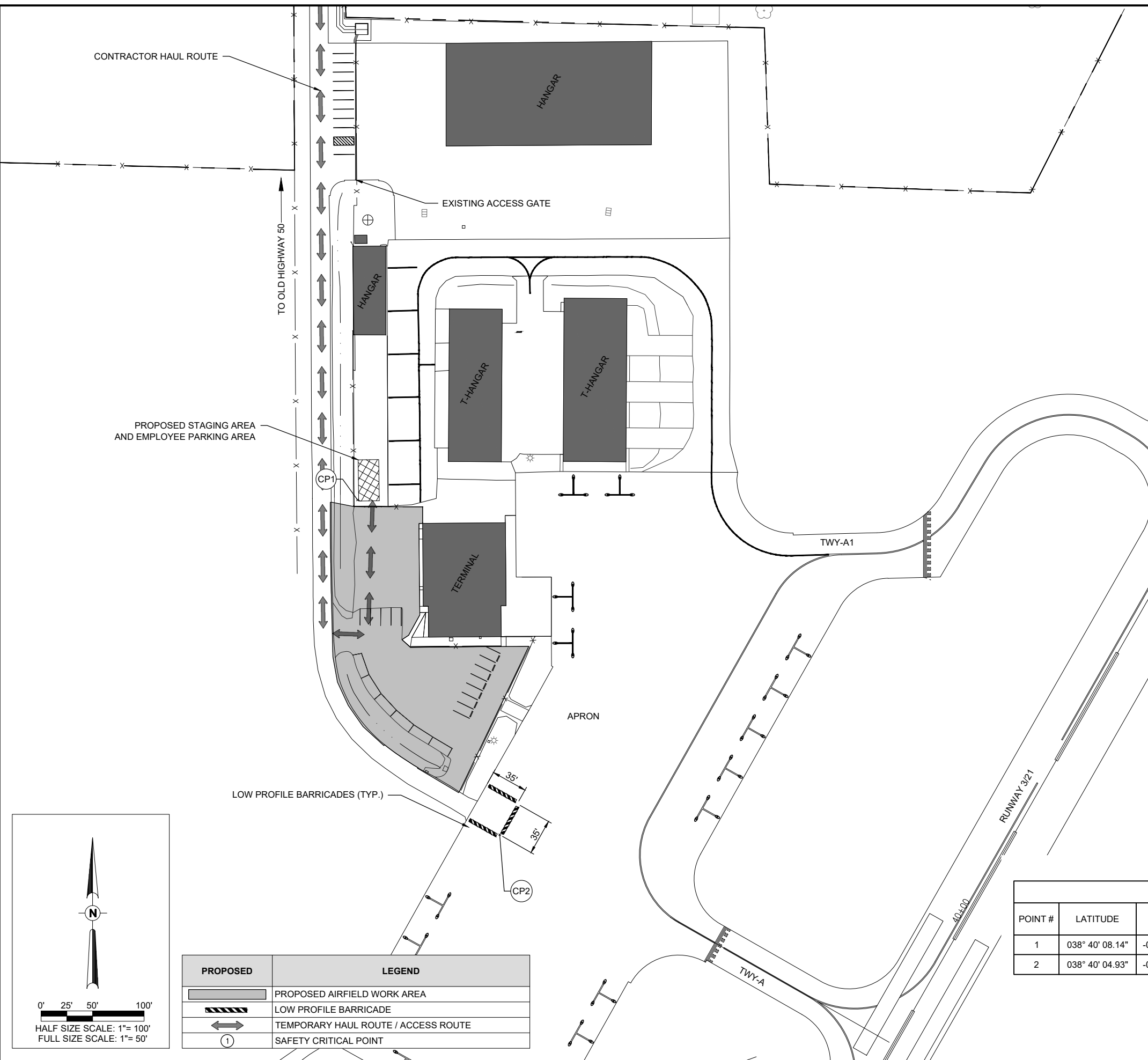

PROPOSED	LEGEND
[Shaded Area]	PROPOSED AIRFIELD WORK AREA
[Hatched Area]	LOW PROFILE BARRICADE
[Arrow]	TEMPORARY HAUL ROUTE / ACCESS ROUTE
[Circle with 1]	SAFETY CRITICAL POINT

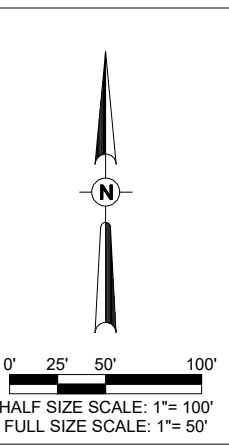

OCT 17, 2023 5:37 PM HAUSM00682 1:22:08S\22A0007D\CAD\AIRPORT\SHETTC-003-SFY.DWG

FOR BID



DATE SIGNED: 9/22/2023 LICENSE EXPIRES: 11/30/2023

RECONSTRUCT AUTO PARKING LOT AND AIRCRAFT HANGAR ACCESS PAVEMENT

IDA No: FOA-4986

NO.	DATE	DESCRIPTION		
		DES	DWN	REV

ISSUE: SEPTEMBER 22, 2023

PROJECT NO: 22A0007D

CAD FILE: G-003-SFY.DWG

DESIGN BY: MJD 7/28/2023

DRAWN BY: CWS 7/28/2023

REVIEWED BY: LDH 9/22/2023

SHEET TITLE

CONSTRUCTION SAFETY PHASING PLAN - PHASE 2

PHASE 2

1. THE PROPOSED SAFETY PLAN WILL GOVERN WHEN WORK IS BEING COMPLETED IN THE SHADED REGIONS SHOWN ON THE PLANS.
2. PHASE 2 INCLUDES RECONSTRUCTING EXISTING APRON
 - 2.1. FULL DEPTH REMOVAL OF EXISTING PAVEMENT AND REPLACEMENT
 - 2.1.1. ALTERNATE A - BITUMINOUS PAVEMENT
 - 2.1.2. ALTERNATE B - PCC PAVEMENT
 - 2.2. UTILITY IMPROVEMENTS
 - 2.2.1. REMOVING A STAKE MOUNTED LIGHT
 - 2.3. LANDSCAPING ITEMS
 - 2.3.1. REMOVING AGGREGATE AND UNSUITABLE TOPSOIL AND REPLACING WITH ON-SITE AND OFF-SITE SUITABLE MATERIAL.
 - 2.3.2. SEEDING AND MULCHING
 - 2.4. PAVEMENT MARKING & MISCELLANEOUS

CLOSURES

1. T-HANGAR PAVEMENTS NORTH OF THE APRON WILL BE CLOSED.

FLAGGER NOTES

1. RADIO CONTROL - THE CONTRACTOR WILL BE REQUIRED TO BE IN TWO-WAY RADIO CONTACT (122.70 MHz.) WITH THE AIRPORT UNICOM. THIS WILL KEEP THE CONTRACTOR IN CONSTANT CONTACT WITH THE FLORA AIRPORT AND ENABLE THE AIRPORT TO IMMEDIATELY CONTACT THE CONTRACTOR IN CASE OF AN AERONAUTIC EMERGENCY THAT WOULD REQUIRE ACTION BY THE CONTRACTOR AND/OR HIS PERSONNEL.

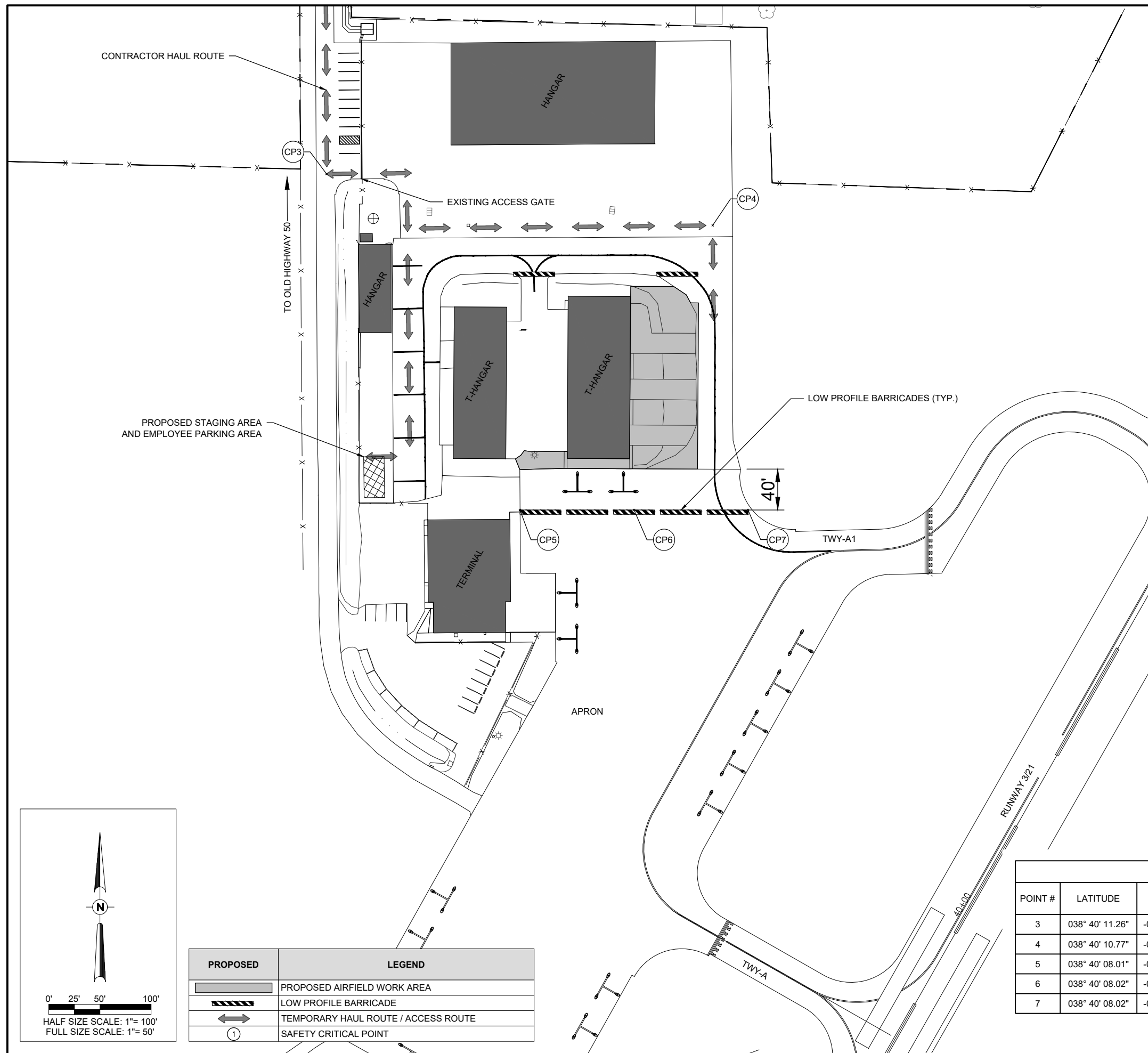

CRITICAL POINTS						
POINT #	LATITUDE	LONGITUDE	DESCRIPTION	ELEV	OBJECT HEIGHT (FT)	OBJECT ELEV
3	038° 40' 11.26"	-088° 27' 08.50"	EQUIPMENT	469.6	25	494.6
4	038° 40' 10.77"	-088° 27' 03.74"	EQUIPMENT	468.3	25	493.3
5	038° 40' 08.01"	-088° 27' 06.11"	EQUIPMENT	470.2	25	495.2
6	038° 40' 08.02"	-088° 27' 04.71"	EQUIPMENT	469.4	25	494.4
7	038° 40' 08.02"	-088° 27' 03.30"	EQUIPMENT	468.9	25	493.9

PROPOSED	LEGEND
	PROPOSED AIRFIELD WORK AREA
	LOW PROFILE BARRICADE
	TEMPORARY HAUL ROUTE / ACCESS ROUTE
	SAFETY CRITICAL POINT

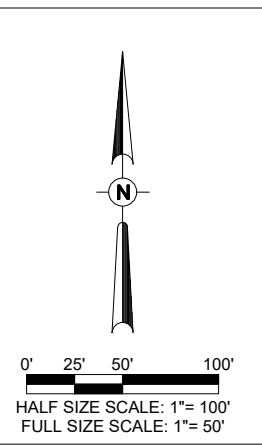

OCT 17, 2023 5:37 PM HAUSM00682 1:22:08S22A0007D\CAD\AIRPORT\SHHEETC-003-SFY.DWG

FOR BID

SAFETY NOTES

- ALL PROVISIONS OF THE LATEST EDITION OF FAA ADVISORY CIRCULAR AC 150/5370-2 (CURRENT EDITION), "OPERATIONAL SAFETY ON AIRPORTS DURING CONSTRUCTION", APPLY TO THIS CONTRACT, EXCEPT AS MODIFIED BY THIS SAFETY PLAN. **ANY CHANGE TO THE CONSTRUCTION PHASING AND SAFETY PLAN MUST BE APPROVED BY THE FAA.**
- THE CONTRACTORS SHALL MINIMIZE DISRUPTION OF STANDARD OPERATING PROCEDURES FOR AERONAUTICAL ACTIVITY BY REMAINING WITHIN THE PRESCRIBED STAGING, CONSTRUCTION, AND PHASING AREAS PRESENTED ON THE CONSTRUCTION SAFETY AND PHASING PLAN SHEETS.
- NO UNAUTHORIZED PERSONNEL SHALL ENTER ANY AREA OF THE AIRPORT THAT COULD POTENTIALLY BE HAZARDOUS. THE AIRPORT MANAGER RESERVES THE RIGHT TO SUSPEND OPERATIONS IN ORDER TO MAINTAIN SAFETY AT THE AIRPORT.
- NO CONSTRUCTION VEHICLES SHALL BE DRIVEN ACROSS ANY ACTIVE AIRFIELD PAVEMENT AREA WITHOUT AN APPROPRIATE ESCORT. CONSTRUCTION EQUIPMENT OR CONSTRUCTION ACTIVITY WILL NOT BE PERMITTED WITHIN **250'** OF ANY ACTIVE RUNWAY CENTERLINE OR WITHIN **62'** OF ANY OTHER ACTIVE AIRPORT TAXIWAY OR APRON.
- CONTRACTOR EQUIPMENT, VEHICLES, AND PROJECT MATERIALS SHALL BE STORED AT THE STAGING AREA SHOWN ON THE PLAN VIEW, EXCEPT AS OTHERWISE PROVIDED FOR AT THE PRECONSTRUCTION CONFERENCE.
- ALL CONSTRUCTION EQUIPMENT OPERATING IN THE PRESCRIBED CONSTRUCTION AREA IS REQUIRED TO DISPLAY A CHECKERBOARD FLAG PROPERLY LOCATED OR A ROTATING BEACON (STROBE) AS SPECIFIED IN AC 150/5210-5, "PAINTING, MARKING, AND LIGHTING OF VEHICLES USED ON AN AIRPORT" LATEST EDITION.
- NO CONSTRUCTION MATERIAL STOCKPILES SHALL BE LOCATED WITHIN **500'** OF ANY ACTIVE RUNWAY, WITHIN **62'** OF ANY OTHER ACTIVE AIRPORT OPERATIONS AREA, OR PENETRATE A PART 77 IMAGINARY SURFACE (PROVIDED BY THE RESIDENT ENGINEER/TECHNICIAN) EXTENDING OUT AND UPWARDS FROM ALL SIDES OF AN ACTIVE RUNWAY.
- CLOSED AIRFIELD PHASING AREAS, OPEN TRENCHES, AND STOCKPILED MATERIALS AT THE CONSTRUCTION SITE SHALL BE PROMINENTLY MARKED WITH LIGHTED BARRICADES WITH STEADY BURNING OR FLASHING RED LIGHTS AS SPECIFIED IN 150/5370-2, "OPERATIONAL SAFETY ON AIRPORT DURING CONSTRUCTION", LATEST EDITION. LIGHTED BARRICADES MUST BE NO TALLER THAN 18" (EXCLUSIVE OF SUPPLEMENTARY LIGHTS AND FLAGS) ON THE TAXIWAYS AND COMPLY WITH ADVISORY CIRCULAR 150/5370-2, LATEST EDITION. CONTRACTOR SHALL NIGHT CHECK BARRICADES DAILY FOR PROPER OPERATION.
- OPEN TRENCHES, EXCAVATIONS, AND STOCKPILED MATERIALS AT THE CONSTRUCTION SITE SHOULD BE PROMINENTLY MARKED WITH ORANGE FLAGS AND LIGHTED WITH FLASHING RED LIGHTS DURING HOURS OF RESTRICTED VISIBILITY AND/OR DARKNESS.
- NO CONSTRUCTION EQUIPMENT GREATER THAN 25' TALL WILL BE PERMITTED ON THE AIRPORT WITHOUT THE APPROVAL OF THE AIRPORT MANAGER AND ADDITIONAL AIRSPACE APPROVAL BY THE FAA. AIRSPACE APPROVALS REQUIRE CONSIDERABLE LEAD TIME AND SHOULD BE REQUESTED WELL IN ADVANCE.
- NO OPEN FLAME WELDING OR TORCH CUTTING OPERATION IS PERMITTED UNLESS ADEQUATE FIRE AND SAFETY PRECAUTIONS ARE PROVIDED AND HAVE BEEN APPROVED BY THE AIRPORT MANAGER NO FLARE POTS ARE ALLOWED ON THE PROJECT.
- SOIL, DEBRIS, AND LOOSE MATERIAL DROPPED OR TRUCKED ONTO AIRPORT ROADS, TAXIWAYS, AND SOD SURFACES, OR WHICH CAN BE BLOWN ONTO SUCH SURFACES, SHALL BE IMMEDIATELY SWEEPED, PICKED UP AND REMOVED, OR PLACED INTO CLOSED CONTAINERS. ANY DAMAGE TO AIRPORT PROPERTY SHALL BE REPAIRED IMMEDIATELY AT NO COST TO THE OWNER.
- CONTRACTOR SHALL TAKE MEASURES TO AVOID TRACKING ASPHALT MATERIALS ONTO ADJACENT PAVEMENT AREAS, UNLESS SUFFICIENT PROTECTION HAS BEEN APPLIED. HEAVY TRACKING OR DAMAGE TO ADJACENT PAVEMENTS MAY BE CAUSE FOR STOPPING THE WORK UNTIL ACCEPTABLE PROTECTION OR CHANGE IN WORK METHODS HAS BEEN PROVIDED.
- EACH CONTRACTOR SHALL BE RESPONSIBLE FOR LOCATING AND MAINTAINING ALL AIRPORT LIGHTING, NAVIGATIONAL ELECTRICAL SYSTEMS, AND ALL WATER, GAS, ELECTRIC, PHONE, AND FIBER OPTIC UTILITIES DURING CONSTRUCTION. A CONTACT PERSON AND TELEPHONE NUMBER FOR 24 HOUR EMERGENCY IMMEDIATE REPAIR SHALL BE SUBMITTED TO THE AIRPORT MANAGER AND RESIDENT ENGINEER/TECHNICIAN. HAUL ROUTES CROSSING PAVEMENT, DRAINAGE, MISCELLANEOUS. STRUCTURES AND/OR AIRFIELD CABLES SHALL BE PROTECTED FROM DAMAGE.
- ALL AIRCRAFT AND AIRPORT OPERATIONS HAVE THE RIGHT-OF-WAY. CONTRACTOR TO YIELD TO VEHICLES AND REMAIN CLEAR AT ALL TIMES.

- CONTRACTOR SHALL PLACE, SECURE, AND MAINTAIN LIGHTED BARRICADES AND CLOSURE CROSSES WHEN A RUNWAY/TAXIWAY/APRON IS CLOSED OR AS REQUIRED BY THE PLANS AND DESIGNATED BY THE RESIDENT ENGINEER/TECHNICIAN.
- CONTRACTOR SHALL MARK HAZARDOUS AREA WITH STEADY-BURNING OR FLASHING RED LIGHTS DURING PERIODS OF LOW VISIBILITY AS REQUIRED.
- THE CONTRACTOR SHALL PERIODICALLY PERFORM ONSITE INSPECTIONS THROUGHOUT THE DURATION OF THE PROJECT WITH THE IMMEDIATE REMEDY OF ANY DIFFERENCES, WHETHER CAUSED BY NEGLIGENCE, OVERSIGHT, OR PROJECT SCOPE CHANGE.
- CONTRACTOR SHALL MOVE MAINTENANCE OF TRAFFIC COMPONENTS AT THE WRITTEN DIRECTION OF THE RESIDENT ENGINEER/TECHNICIAN AT NO ADDITIONAL COST.
- CONTRACTOR SHALL NOT REMOVE THE BARRICADES WITHOUT THE APPROVAL BY THE RESIDENT ENGINEER/TECHNICIAN.
- CONTRACTOR SHALL MAINTAIN FLASHERS, SIGNS AND/OR BARRICADES AS REQUIRED BY THE PLANS, CITY OR COUNTY REGULATIONS OR CONTRACTOR ACTIVITIES. CONTRACTOR SHALL OBTAIN ANY AND ALL REQUIRED LOCAL PERMITS UNLESS SPECIFIED OTHERWISE.
- THE CONTRACTOR SHALL UTILIZE WATER AND/OR CHEMICALS APPROVED BY THE RESIDENT ENGINEER/TECHNICIAN AS NECESSARY TO CONTROL DUST.
- THE CONTRACTOR WILL BE RESPONSIBLE FOR IMPLEMENTING MEASURES TO CONTROL OR AVOID CREATING ATTRACTANTS TO WILDLIFE. MEASURES MAY INCLUDE CONTINUOUSLY REMOVING ANY WASTE OR LOOSE MATERIALS, PLACEMENT OF MATERIALS IN APPROPRIATE STORAGE CONTAINERS, PROPERLY MAINTAINING FENCES AND GATES TO PREVENT ACCESS, AND PREVENTING PONDING OF WATER THROUGHOUT THE SITE.
- UNLESS SPECIFIED OTHERWISE, COST FOR SAFETY, STAGING, AND TRAFFIC MAINTENANCE ITEMS IS TO BE CONSIDERED INCIDENTAL TO THE PROJECT. SEPARATE PAYMENT SHALL NOT BE MADE.
- THE CONTRACTOR SHALL HAVE THE SAFETY PLAN COMPLIANCE DOCUMENT (SPCD), AS DETAILED IN THE SPECIAL PROVISIONS, SUBMITTED AND APPROVED PRIOR TO BEING ISSUED "NOTICE TO PROCEED".
- ALL RUNWAY/TAXIWAY CLOSURES SHALL BE COORDINATED WITH AIRPORT MANAGEMENT A MINIMUM OF 7 DAYS BEFORE THE DESIRED CLOSING TIME TO ALLOW FOR THE PROPER COORDINATION. AIRPORT MANAGEMENT HAS COMPLETE AUTHORITY IN DETERMINING WHEN THE RUNWAY/TAXIWAY MAY BE CLOSED.
- RUNWAY/TAXIWAY CLOSURE PROCEDURES:
 - CONTACT THE AIRPORT MANAGEMENT OR ASSIGNED REPRESENTATIVE A MINIMUM OF 7 DAYS BEFORE THE DESIRED CLOSING TIME..
 - ISSUANCE OF NOTAM AND DEACTIVATION OF THE APPLICABLE AIRFIELD LIGHTING AND NAVAIDS BY THE AIRPORT MANAGEMENT AND/OR FAA.
 - PLACEMENT OF CROSSES AND BARRICADES.
 - ONLY AT THE TIME THAT ALL OF THE ABOVE ARE COMPLETED MAY ANY CONSTRUCTION OPERATIONS BEGIN WITHIN THE RUNWAY/TAXIWAY AIR OPERATIONS AREA.
- RUNWAY/TAXIWAY RE-OPENING PROCEDURES:
 - ENSURE ALL PERSONNEL, EQUIPMENT AND MATERIALS ARE CLEAR OF THE AIR OPERATIONS AREA.
 - INSPECT THE AREA FOR LOOSE OR TRACKED DEBRIS, PAVEMENT DROP-OFFS, AND OPEN TRENCHES.
 - CONTACT AIRPORT MANAGEMENT OR REPRESENTATIVE FOR FINAL INSPECTION OF THE AREA.
 - REMOVE BARRICADES AND CROSSES.
 - ACTIVATION OF THE AIRFIELD LIGHTING AND NAVAIDS AND CANCELLATION OF THE NOTAM BY THE AIRPORT MANAGEMENT AND/OR FAA.

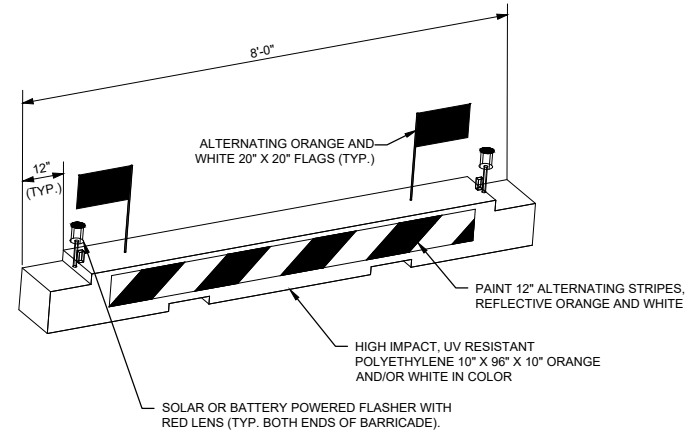

LOW PROFILE AIRCRAFT BARRICADE DETAIL

BARRICADE NOTES

- ALL CONSTRUCTION SIGNS AND TRAFFIC CONTROL DEVICES SHALL CONFORM TO THE MANUAL ON UNIFORM TRAFFIC CONTROL DEVICES INCLUDING THE ILLINOIS SUPPLEMENT (LATEST EDITION) AND THE FAA ADVISORY CIRCULARS (LATEST EDITION) UNLESS NOTED OTHERWISE. THE FAA OR MORE STRINGENT SPECIFICATIONS SHALL GOVERN.
- BARRICADES SHALL BE INTERLOCKED END TO END OVER THE LENGTH OF THE PAVEMENT WHERE PROTECTING OPEN RUNWAYS, AND SPACED END TO END A MAXIMUM OF 4 FEET IN OTHER ALL OTHER AREAS. BARRICADES ARE TO BE SET BACK FROM THE ACTIVE RUNWAY OR TAXIWAY CENTERLINE THE DISTANCE AS SHOWN ON THE PLANS.
- CONSTRUCTION RED WARNING LIGHT: THESE ARE PORTABLE, LENS DIRECTED, ENCLOSED LIGHTS. THE COLOR OF THE LIGHT EMITTED SHALL BE RED. THEY MAY BE USED IN EITHER A STEADY BURN (TYPE C) OR LOW INTENSITY FLASHING MODE (TYPE A) UNLESS NOTED OTHERWISE.
- THE LIGHTING SHALL BE MAINTAINED IN OPERATION DURING THE HOURS OF DARKNESS BETWEEN 1/2 HOUR AFTER SUNSET AND 1/2 HOUR BEFORE SUNRISE AND WHEN CONDITIONS EXIST WHICH TEND TO OBSCURE VISION.
- BARRICADES SHALL BE SECURED TO THE GROUND BY APPROVED METHODS TO PREVENT MOVEMENT BY PROP WASH, JET BLAST OR OTHER WIND CURRENTS.
- THE ONLY COLOR COMBINATION ON BARRICADES IS ORANGE AND WHITE. THE ORANGE STRIPES SHALL BE ENCAPSULATED LENS REFLECTIVE SHEETING. THE WHITE STRIPES SHALL BE EITHER ENCAPSULATED OR ENCLOSED LENS REFLECTIVE SHEETING AND MUST BE IN ACCEPTABLE CONDITION.
- COST FOR PROVIDING, PLACING, MAINTAINING, RELOCATING AND REMOVING BARRICADES SHALL BE INCLUDED AS AN INCIDENTAL COST TO THE CONTRACT, UNLESS OTHERWISE NOTED.



Offices Nationwide
www.hanson-inc.com

Hanson Professional Services Inc.
1525 S. 6th Street
Springfield, IL 62568
phone: 217-788-2450
fax: 217-788-2503

Illinois Licensed
Professional Service Corporation
#184-001084

FLORA MUNICIPAL AIRPORT

**1 AIRPORT ROAD
FLORA, ILLINOIS 62839**



Lindsay Hausman

DATE SIGNED: 9/22/2023 LICENSE EXPIRES: 11/30/2023

RECONSTRUCT AUTO PARKING LOT AND AIRCRAFT HANGAR ACCESS PAVEMENT

IDA No: FOA-4986

NO.	DATE	DESCRIPTION		
		DES	DWN	REV

ISSUE: SEPTEMBER 22, 2023

PROJECT NO: 22A0007D

CAD FILE: G-003-SFY.DWG

DESIGN BY: MJD 7/28/2023

DRAWN BY: CWS 7/28/2023

REVIEWED BY: LDH 9/22/2023

SHEET TITLE

SAFETY NOTES AND DETAILS

OCT 17, 2023 5:37 PM HALUSM00682 1:22:08S\22A0007D\CAD\AIRPORT\SHHEETC-003-SFY.DWG

FOR BID

FLORA MUNICIPAL AIRPORT

1 AIRPORT ROAD
FLORA, ILLINOIS 62839



Lindsay Hausman

DATE SIGNED: 9/22/2023 LICENSE EXPIRES: 11/30/2023

RECONSTRUCT AUTO PARKING LOT AND AIRCRAFT HANGAR ACCESS PAVEMENT

IDA No: FOA-4986

NO.	DATE	DESCRIPTION

ISSUE: SEPTEMBER 22, 2023

PROJECT NO: 22A0007D

CAD FILE: C-100-GEO.DWG

DESIGN BY: MJD 7/28/2023

DRAWN BY: CWS 7/28/2023

REVIEWED BY: LDH 9/22/2023

SHEET TITLE

PROPOSED ALIGNMENT GEOMETRICS PLAN

SURVEY NOTES

1. ALL COORDINATE VALUES SHOWN IN TABLE ARE BASED ON HARN/IL ILLINOIS STATE PLANES COORDINATE SYSTEM, EAST ZONE. ALL ELEVATIONS ARE REFERENCED TO NAVD 88.
2. THE CONTRACTOR SHALL BE RESPONSIBLE FOR ALL CONSTRUCTION LAYOUT AND ANY EXTENSION OF THE CONTROL NETWORK NEEDED TO PROPERLY COMPLETE THE WORK.

ALIGNMENT DATA PR - AIRPORT RD

LABEL	START STATION	END STATION	LENGTH	AZIMUTH	START (N,E)	END (N,E)
L1	0+00.00	0+84.15	84.15	301° 27' 58"	728806.25, 950412.04	728850.18, 950340.26
C1	0+84.15		151.84	IN=N58° 32' 02"W OUT=N0° 32' 02"W DEL=58°00'00"	728850.18, 950340.26	728976.72, 950268.57
L2	2+35.99	6+14.44	378.45	359° 27' 58"	728976.72, 950268.57	729355.15, 950265.04

ALIGNMENT DATA PR - TWY

LABEL	START STATION	END STATION	LENGTH	AZIMUTH	START (N,E)	END (N,E)
L3	0+00.00	4+00.01	400.01	0° 00' 00"	729003.27, 950644.83	729403.28, 950644.83

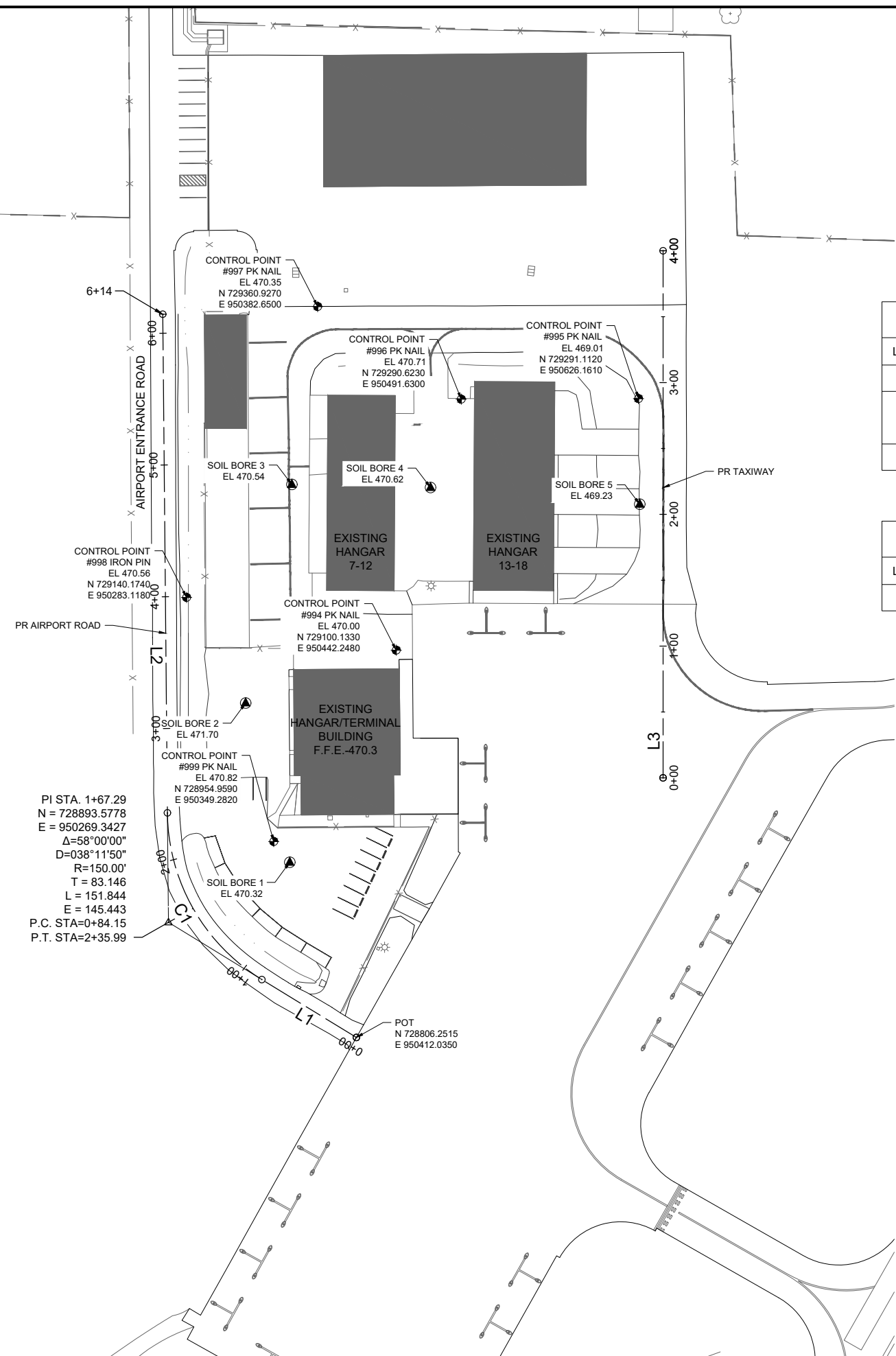

PI STA. 1+67.29
N = 728893.5778
E = 950269.3427
Δ=58°00'00"
D=038°11'50"
R=150.00'
T = 83.146
L = 151.844
E = 145.443
P.C. STA=0+84.15
P.T. STA=2+35.99

POT
N 728806.2515
E 950412.0350

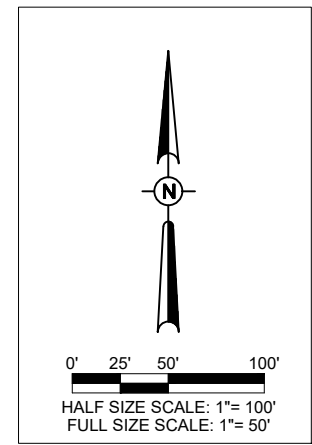

HALF SIZE SCALE: 1"= 100'
FULL SIZE SCALE: 1"= 50'

FOR BID



**RECONSTRUCT AUTO
PARKING LOT AND
AIRCRAFT HANGAR
ACCESS PAVEMENT**

IDA No: FOA-4986

NO.	DATE	DESCRIPTION		
		DES	DWN	REV

ISSUE: SEPTEMBER 22, 2023

PROJECT NO: 22A0007D

CAD FILE: C-101-DMO.DWG

DESIGN BY: MJD 7/28/2023

DRAWN BY: CWS 7/28/2023

REVIEWED BY: LDH 9/22/2023

SHEET TITLE

**EXISTING
CONDITIONS
DEMOLITION PLAN -
PARKING LOT**

NOTES:

- EXISTING FENCE SHALL BE PROTECTED DURING CONSTRUCTION. ANY DAMAGE TO THE FENCE SHALL BE REPAIRED AT NO ADDITIONAL COST TO THE CONTRACT.
- DURING REMOVAL AND REPLACEMENT OF THE DRAINAGE PIPE THE CONTRACTOR SHALL PROVIDE LOW-PROFILE BARRICADES ACCORDING TO THE SAFETY PLAN.
- CONTRACTOR SHALL TAKE CARE TO PROTECT THE EXISTING ELECTRICAL CONDUIT, WATER, GAS, FIBER OPTIC, SEWER, AND OTHER UTILITIES DURING CONSTRUCTION.

LEGEND

- OHE— EXISTING OVERHEAD ELECTRIC
- E— EXISTING ELECTRIC
- G— EXISTING GAS
- FO— EXISTING FIBER OPTIC
- W— EXISTING WATER
- >— EXISTING STORM SEWER
- X— EXISTING FENCE
- ☀ EXISTING POLE LIGHT
- ▨ PROPOSED BITUMINOUS PAVEMENT REMOVAL
- ▩ PROPOSED CONCRETE PAVEMENT REMOVAL
- ⊖ A CLEANOUT TO BE ADJUSTED W/ NEW FRAME AND LID
- ⊖ A WATER METER/SHUTOFF TO BE ADJUSTED
- PIPE BOLLARD TO BE REMOVED
- ⊖ FIRE HYDRANT

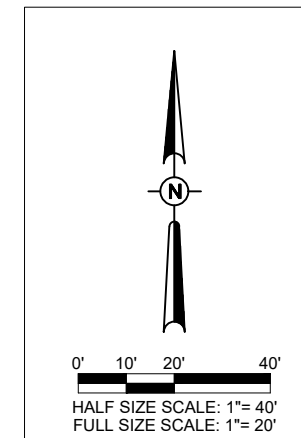

FOR BID

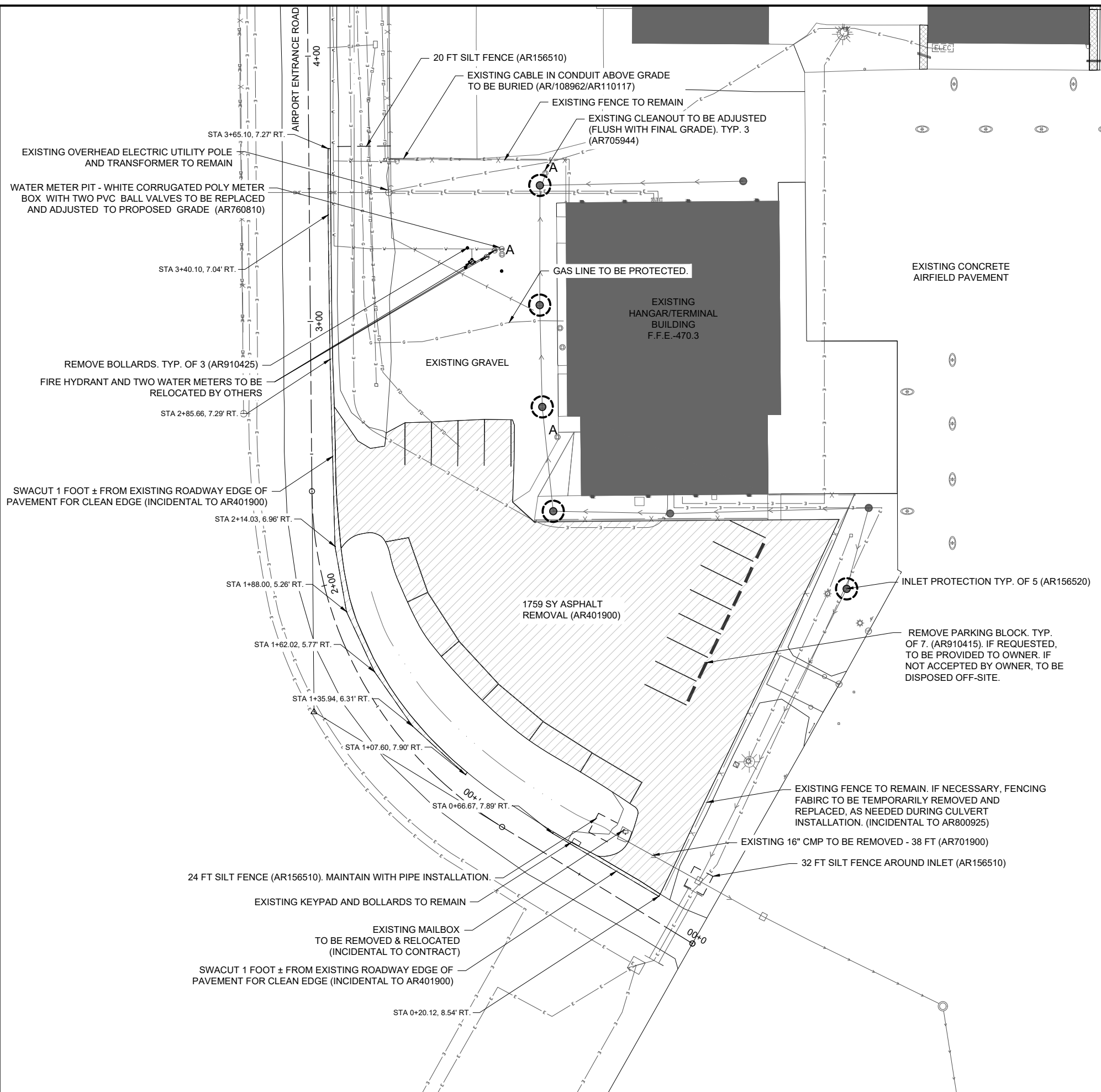

OCT 17, 2023 5:37 PM HAUSM00682 1:22:08S22A0007D\CAD\AIRPORT\SHHEETC-101-DMO.DWG

FLORA MUNICIPAL AIRPORT

1 AIRPORT ROAD
FLORA, ILLINOIS 62839



DATE SIGNED: 9/22/2023 LICENSE EXPIRES: 11/30/2023

RECONSTRUCT AUTO PARKING LOT AND AIRCRAFT HANGAR ACCESS PAVEMENT

IDA No: FOA-4986

NO.	DATE	DESCRIPTION		
		DES	DWN	REV

ISSUE: SEPTEMBER 22, 2023

PROJECT NO: 22A0007D

CAD FILE: C-101-DMO.DWG

DESIGN BY: MJD 7/28/2023

DRAWN BY: CWS 7/28/2023

REVIEWED BY: LDH 9/22/2023

SHEET TITLE

**EXISTING CONDITIONS
DEMOLITION PLAN -
HANGAR ACCESS**

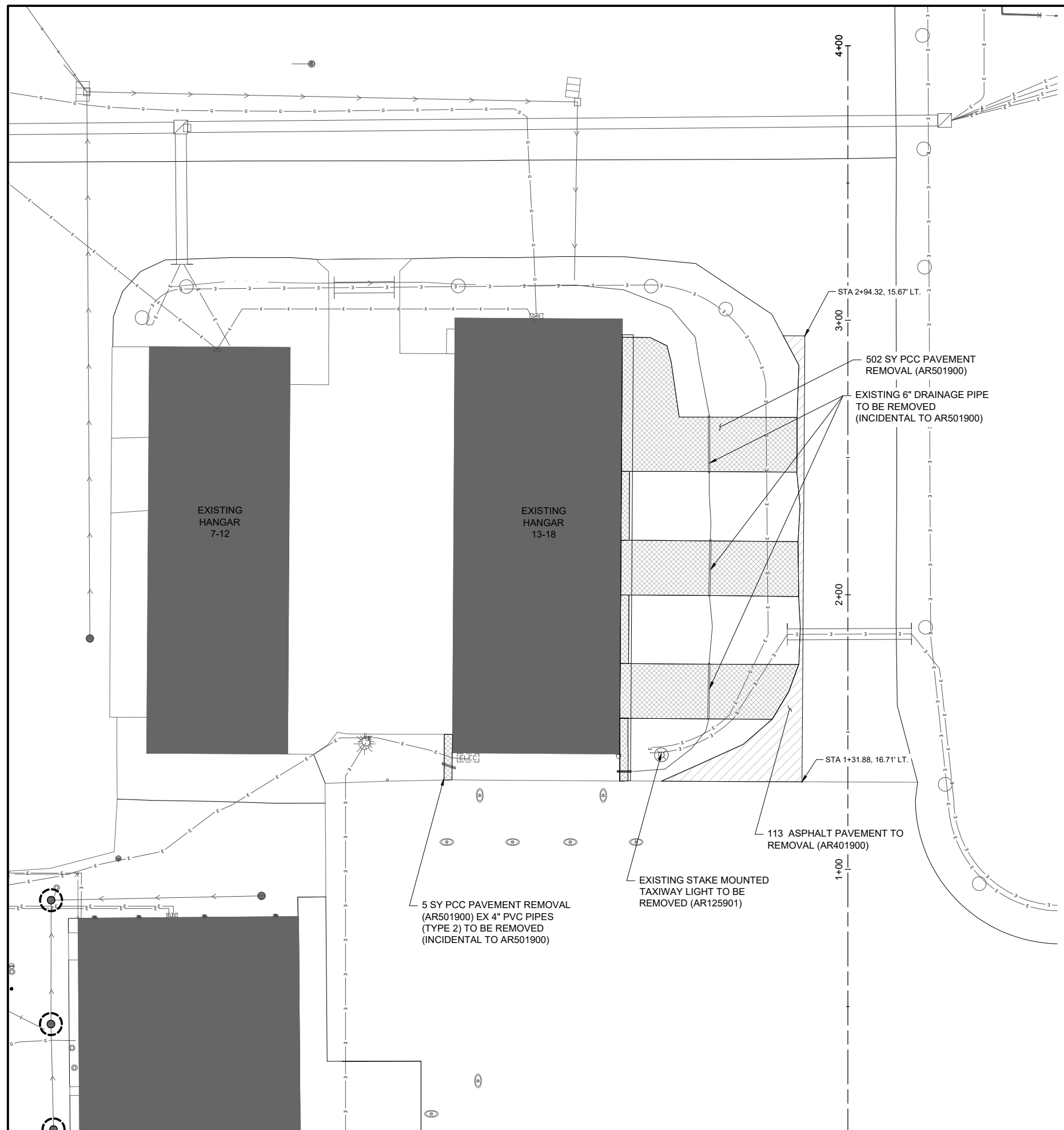

- LEGEND**
- OHE— EXISTING OVERHEAD ELECTRIC
 - E— EXISTING ELECTRIC
 - G— EXISTING GAS
 - FO— EXISTING FIBER OPTIC
 - W— EXISTING WATER
 - S— EXISTING STORM SEWER
 - X— EXISTING FENCE
 - ☀ EXISTING POLE LIGHT
 - ▨ PROPOSED BITUMINOUS PAVEMENT REMOVAL
 - ▩ PROPOSED CONCRETE PAVEMENT REMOVAL

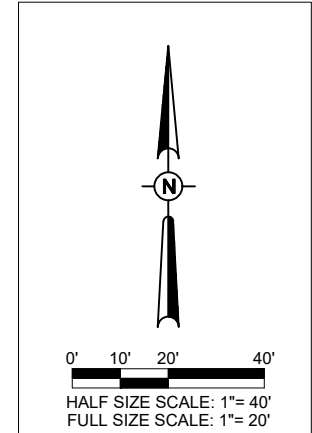

FOR BID

OCT 17, 2023 5:37 PM HALJSM00682
I:\22\JOBS\22A0007D\CAD\AIRPORT\ISHEETC-101-DMO.DWG

FLORA MUNICIPAL AIRPORT

1 AIRPORT ROAD
FLORA, ILLINOIS 62839



DATE SIGNED: 9/22/2023 LICENSE EXPIRES: 11/30/2023

RECONSTRUCT AUTO PARKING LOT AND AIRCRAFT HANGAR ACCESS PAVEMENT

IDA No: FOA-4986

NO.	DATE	DESCRIPTION		
		DES	DWN	REV

ISSUE: SEPTEMBER 22, 2023

PROJECT NO: 22A0007D
CAD FILE: C-130-GRD.DWG
DESIGN BY: MJD 7/28/2023
DRAWN BY: CWS 7/28/2023
REVIEWED BY: LDH 9/22/2023

SHEET TITLE

PROPOSED GRADING PLAN - PARKING LOT

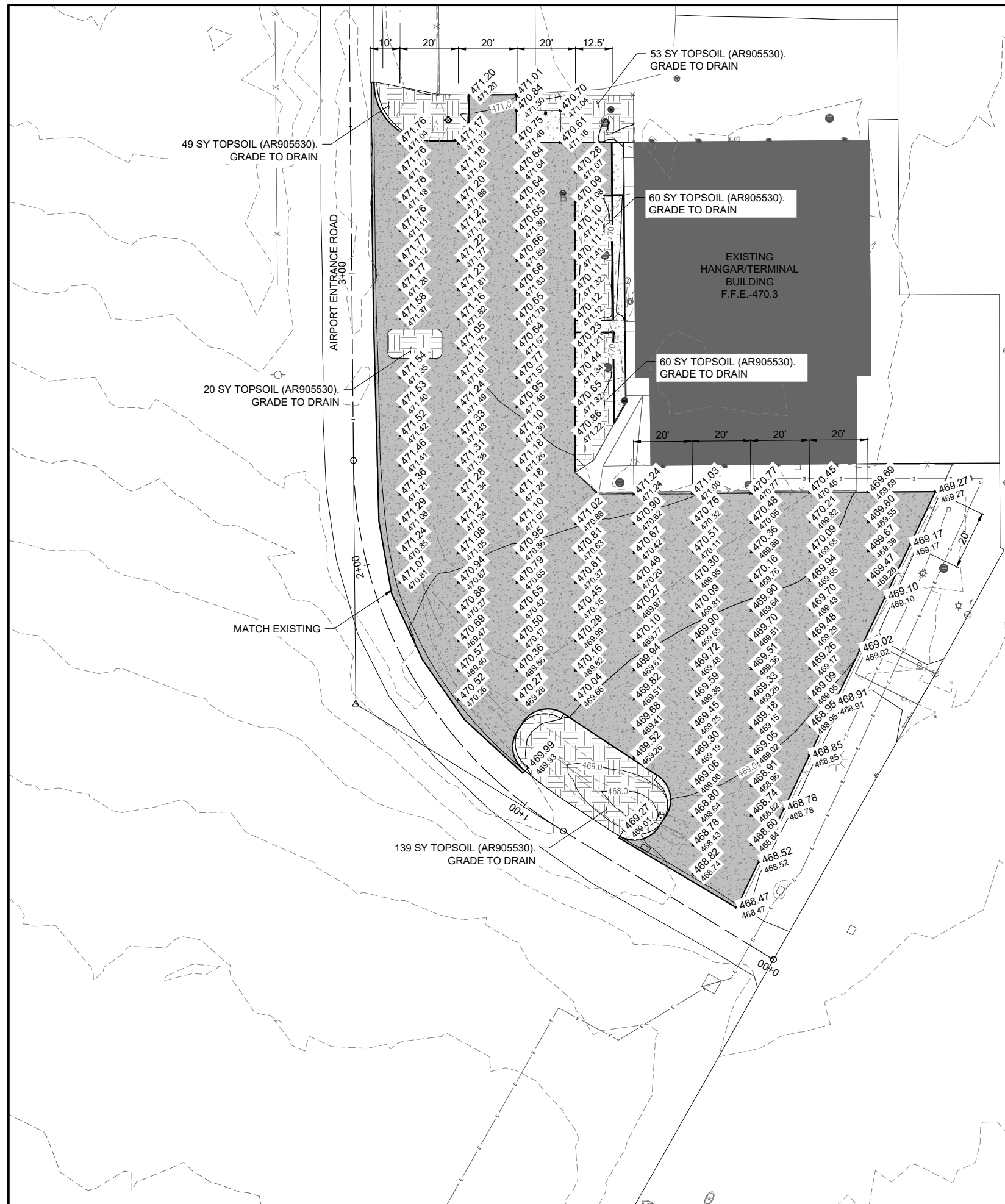

LEGEND

- OHE— EXISTING OVERHEAD ELECTRIC
- E— EXISTING ELECTRIC
- G— EXISTING GAS
- FO— EXISTING FIBER OPTIC
- W— EXISTING WATER
- S— EXISTING STORM SEWER
- X— EXISTING FENCE
- ☀ EXISTING POLE LIGHT
- PROPOSED HMA PAVEMENT
- PROPOSED PCC PAVEMENT
- ▨ PROPOSED TOPSOIL AREA
- ▲ PROPOSED ELEVATION
- EXISTING ELEVATION

- NOTES:**
- EARTHWORK QUANTITIES (CUT/FILL VOLUMES) FOR THE "EXISTING GROUND VS. PROP. DESIGN" SHOWN BELOW WERE CALCULATED UTILIZING AUTODESK CIVIL3D 2023 SOFTWARE. THE CALCULATION METHOD WAS BY A COMPARISON OF SURFACE MODELS CREATED WITH EXISTING SURVEY DATA AND PROPOSED DESIGN GRADES. THE VOLUMES WERE CALCULATED IN TWO PARTS: THE CUT/FILL VOLUME REQUIRED TO CORE OUT AND FILL FOR THE PROPOSED PAVEMENT SECTION AS COMPARED TO THE EXISTING SUBGRADE DATUM, AND THE CUT/FILL VOLUMES REQUIRED FOR PROPOSED GRADING WORK OUTSIDE OF THE PROPOSED PAVEMENT LIMITS AS COMPARED TO THE EXISTING GROUND SURFACE. THE NUMBERS IN THE SUMMARY TABLES ABOVE REPRESENT A TOTAL OF THESE TWO PARTS ADDED TOGETHER FOR CLARITY.
 - IF THE CONTRACTOR DOES NOT AGREE TO THE QUANTITIES DERIVED IN THIS METHOD, THE CONTRACTOR MAY ELECT TO SURVEY THE EXISTING GRADES PRIOR TO BEGINNING EARTHWORK OPERATIONS AS PART OF THE PROJECT FOR THE ENGINEER TO REVIEW FOR A POTENTIAL ADJUSTMENT TO THE PAY ITEM QUANTITY. ANY COSTS ASSOCIATED WITH THE CONTRACTOR-PROVIDED SURVEY SHALL BE INCLUDED IN THE ORIGINAL BID AMOUNT, AND NO ADDITIONAL PAYMENT SHALL BE MADE. FOLLOWING THE CONTRACTOR'S VERIFICATION OF THE QUANTITIES, IF A DISAGREEMENT STILL EXISTS, THE MEASUREMENT OF THE EARTHWORK FOR PAYMENT SHALL BE MADE BY THE RESIDENT ENGINEER, PER THE 152 SPECIFICATION, WHO SHALL TAKE CROSS-SECTIONAL ELEVATIONS AND MEASUREMENTS OF THE EXISTING GROUND SURFACE AND THE FINAL GRADED SURFACE FOR COMPARISON.

EARTHWORK QUANTITY SUMMARY (UNCLASSIFIED EXCAVATION)

	CUT (CY) AS152410	CUT (CY) AT152410
PARKING LOT ALTERNATE A - HMA	757	
TAXIWAY ALTERNATE A - HMA	187	
PARKINGLOT ALTERNATE B - PCC		534
TAXIWAY ADD ALTERNATE B - PCC		148

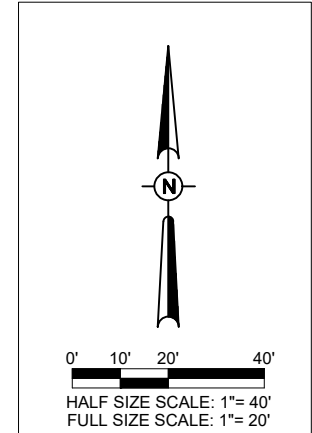

FOR BID



DATE SIGNED: 9/22/2023 LICENSE EXPIRES: 11/30/2023

RECONSTRUCT AUTO PARKING LOT AND AIRCRAFT HANGAR ACCESS PAVEMENT

IDA No: FOA-4986

NO.	DATE	DESCRIPTION		
		DES	DWN	REV
ISSUE: SEPTEMBER 22, 2023				
PROJECT NO: 22A0007D				
CAD FILE: C-130-GRD.DWG				
DESIGN BY: MJD 7/28/2023				
DRAWN BY: CWS 7/28/2023				
REVIEWED BY: LDH 9/22/2023				

SHEET TITLE

PROPOSED GRADING PLAN - HANGAR ACCESS

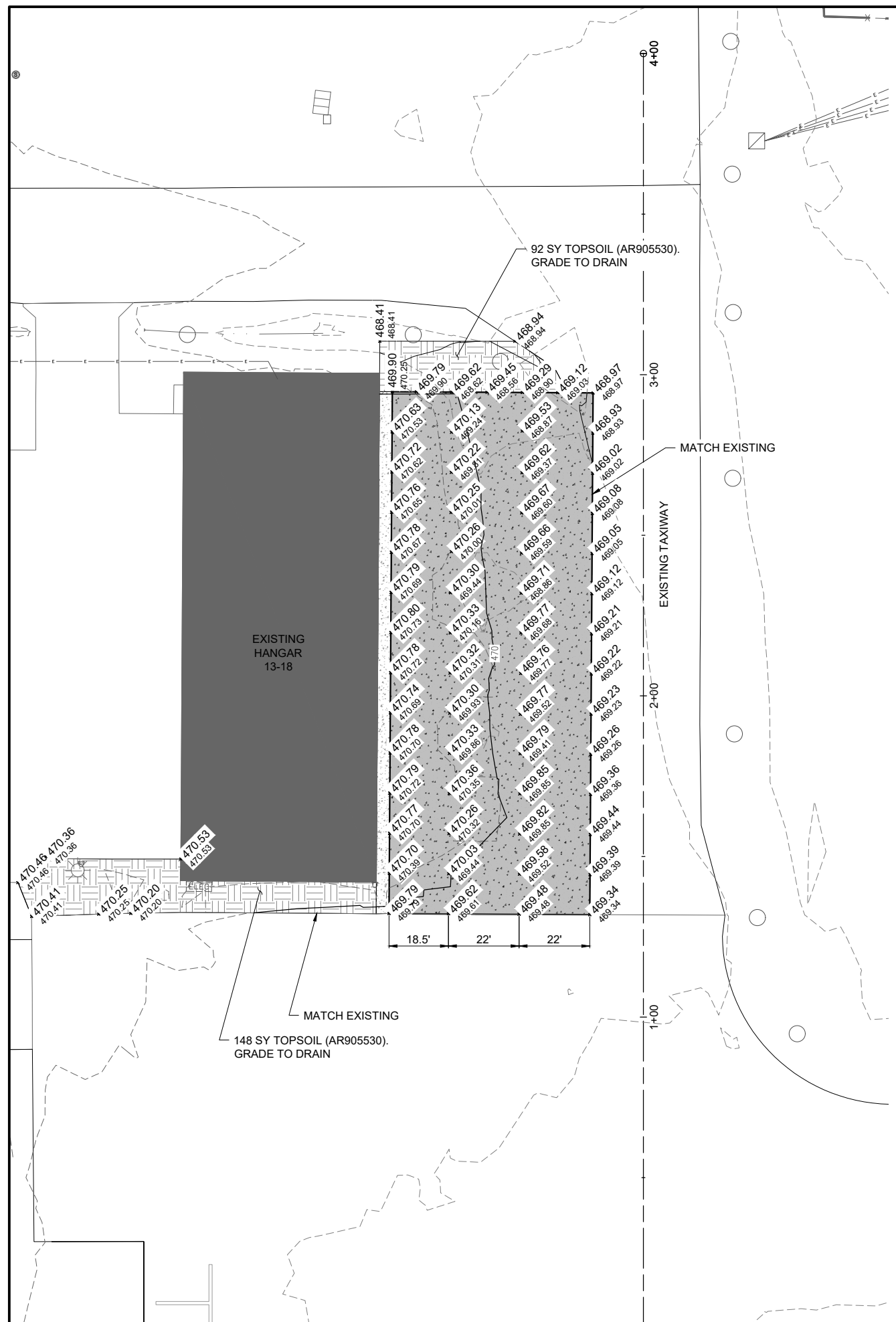

LEGEND

- OHE— EXISTING OVERHEAD ELECTRIC
- E— EXISTING ELECTRIC
- G— EXISTING GAS
- FO— EXISTING FIBER OPTIC
- W— EXISTING WATER
- >— EXISTING STORM SEWER
- X— EXISTING FENCE
- ☀ EXISTING POLE LIGHT
- PROPOSED HMA PAVEMENT
- ▨ PROPOSED PCC PAVMENT
- ▤ PROPOSED TOPSOIL AREA
- ▲ PROPOSED ELEVATION
- ★ EXISTING ELEVATION

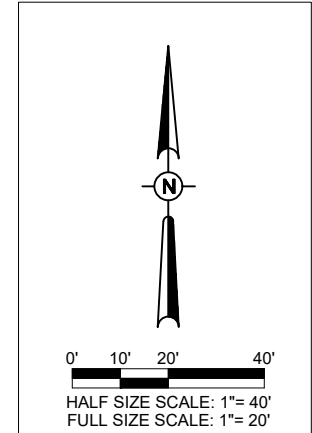

FOR BID

OCT 17, 2023 5:38 PM HAUSM00682 1:22:08S22A0007D\CAD\AIRPORT\ISHEETC-130-GRD.DWG



DATE SIGNED: 9/22/2023 LICENSE EXPIRES: 11/30/2023

RECONSTRUCT AUTO PARKING LOT AND AIRCRAFT HANGAR ACCESS PAVEMENT

IDA No: FOA-4986

NO.	DATE	DESCRIPTION		
		DES	DWN	REV
ISSUE: SEPTEMBER 22, 2023				
PROJECT NO: 22A0007D				
CAD FILE: C-302-TYP.DWG				
DESIGN BY: MJD 7/28/2023				
DRAWN BY: CWS 7/28/2023				
REVIEWED BY: LDH 9/22/2023				

SHEET TITLE

TYPICAL PAVEMENT SECTIONS

ALTERNATE A

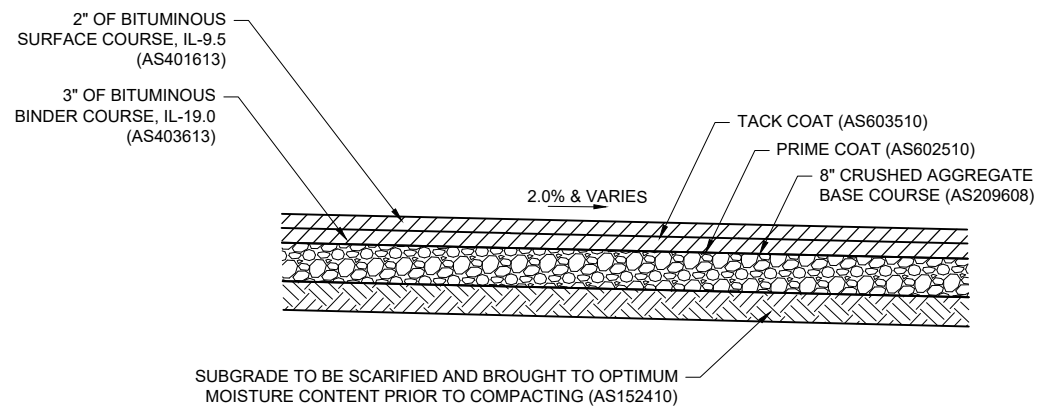

PROPOSED BITUMINOUS PARKING LOT SECTION
NOT TO SCALE

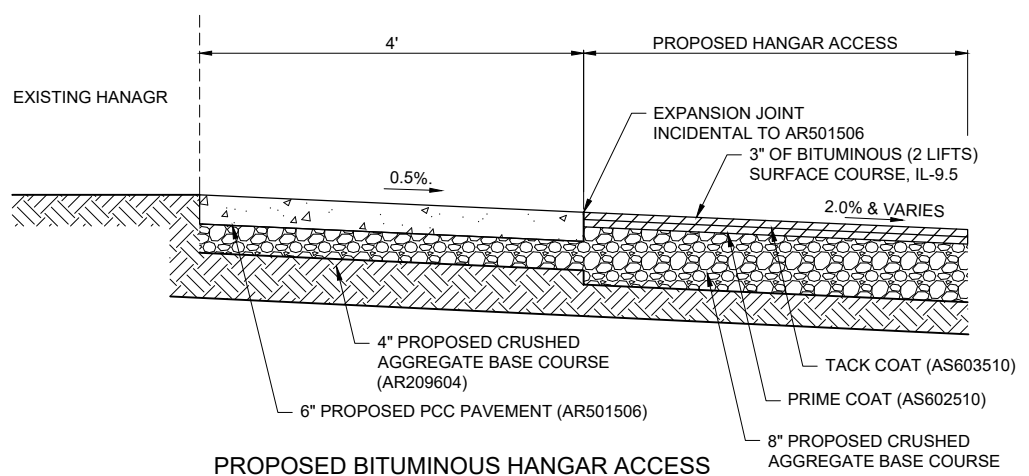

PROPOSED BITUMINOUS HANGAR ACCESS PAVEMENT SECTION
NOT TO SCALE

ALTERNATE B

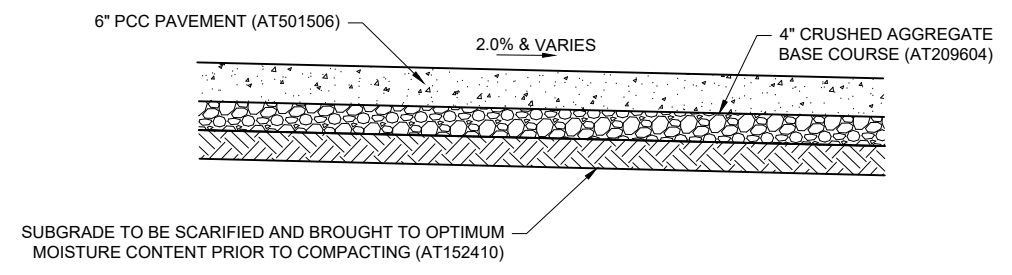

PROPOSED PCC PARKING LOT SECTION
NOT TO SCALE

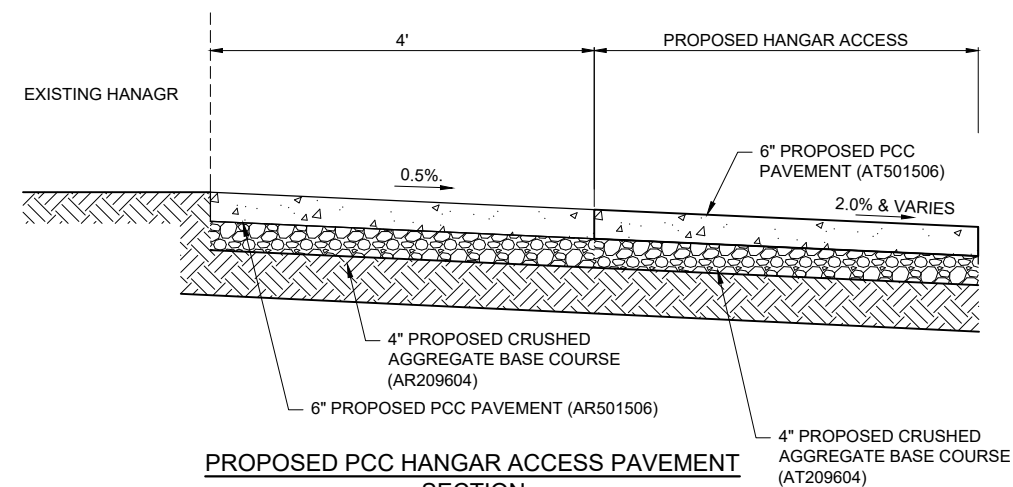

PROPOSED PCC HANGAR ACCESS PAVEMENT SECTION
NOT TO SCALE

SIDEWALK DETAILS

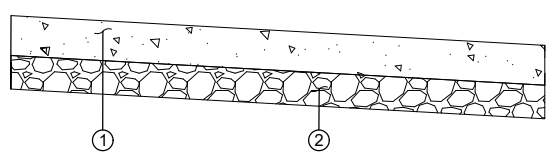

5" PCC SIDEWALK

- ① PROPOSED 5 INCH PCC SIDEWALK, ITEM AR501605
- ② PROPOSED 4 INCH AGGREGATE BASE COURSE, ITEM AR209604

NOTES

1. 3/4" PREFORMED JOINT FILLER TO BE USED IN ALL LOCATIONS WHERE SIDEWALK IS ADJACENT TO EXISTING PAVEMENT.
2. JOINTS ARE TO BE SPACED EVENLY, MAX. SPACING IS 4 FEET WITH 3/4" PREFORMED EXPANSION JOINTS AT 24' MAX. INTERVALS.

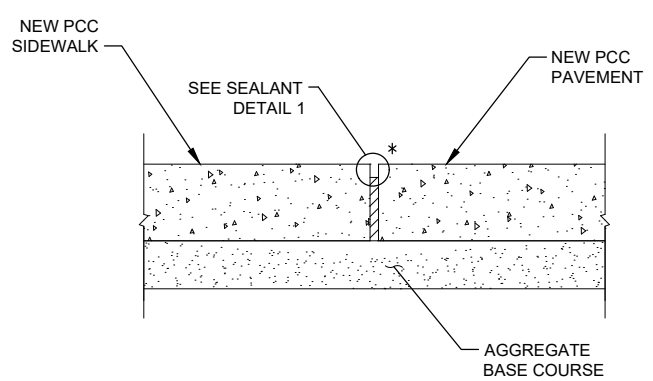

EXPANSION JOINT

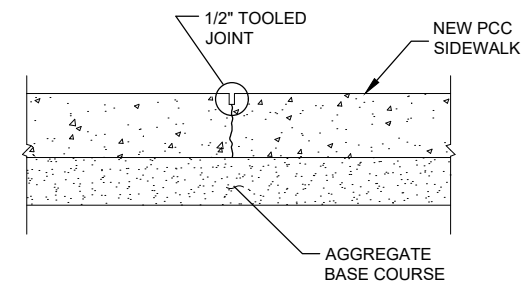

TOOLED CONTRACTION JOINT

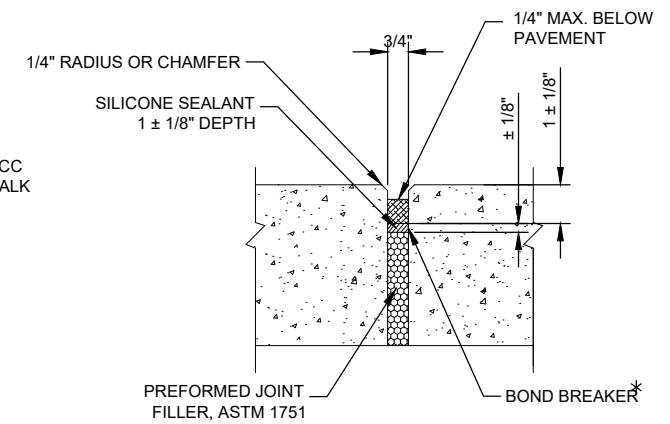

DETAIL 1 - SEALANT

* POLYETHYLENE OR POLYESTER TAPE (3 MIL. MIN.) OR MARKING TAPE, RUBBER TAPE, 1/8" WIDER THAN WIDTH OF JOINT.

FOR BID



RECONSTRUCT AUTO PARKING LOT AND AIRCRAFT HANGAR ACCESS PAVEMENT

IDA No: FOA-4986

SEDIMENTATION AND EROSION CONTROL NOTES:

- A. SEDIMENT CONTROL MEASURES SHALL BE INSTALLED PRIOR TO THE COMMENCEMENT OF HYDROLOGIC DISTURBANCE OF UPLAND AREAS.
- B. FOR THOSE DEVELOPMENTS THAT REQUIRE A DESIGNATED EROSION CONTROL INSPECTOR (DECI), INSPECTIONS AND DOCUMENTATION SHALL BE PERFORMED, AT A MINIMUM:
 - UPON COMPLETION OF SEDIMENT AND RUNOFF CONTROL MEASURES (INCLUDING PERIMETER CONTROLS AND DIVERSIONS), PRIOR TO PROCEEDING WITH ANY OTHER EARTH DISTURBANCE OR GRADING.
 - AFTER EVERY SEVEN (7) CALENDAR DAYS OR STORM EVENT WITH GREATER THAN 0.5 INCH OF RAINFALL OR LIQUID EQUIVALENT PRECIPITATION.
- C. SOIL DISTURBANCE SHALL BE CONDUCTED IN SUCH A MANNER AS TO MINIMIZE EROSION. IF STRIPPING, CLEARING, GRADING, OR LANDSCAPING ARE TO BE DONE IN PHASES, THE PERMITTEE SHALL PLAN FOR APPROPRIATE SOIL EROSION AND SEDIMENT CONTROL MEASURES.
- D. A STABILIZED MAT OF CRUSHED STONE MEETING IDOT GRADATION CA-01 UNDERLAIN WITH FILTER FABRIC AND IN ACCORDANCE WITH THE ILLINOIS URBAN MANUAL, OR OTHER APPROPRIATE MEASURE(S) AS APPROVED BY THE ENFORCEMENT OFFICER, SHALL BE INSTALLED AT ANY POINT WHERE TRAFFIC WILL BE ENTERING OR LEAVING A CONSTRUCTION SITE. SEDIMENT OR SOIL REACHING AN IMPROVED PUBLIC RIGHT OF WAY, STREET, ALLEY OR PARKING AREA SHALL BE REMOVED BY SCRAPING OR STREET CLEANING AS ACCUMULATIONS WARRANT AND TRANSPORTED TO A CONTROLLED SEDIMENT DISPOSAL AREA.
- E. TEMPORARY DIVERSIONS SHALL BE CONSTRUCTED AS NECESSARY TO DIRECT ALL RUNOFF FROM HYDROLOGICALLY DISTURBED AREAS TO AN APPROPRIATE SEDIMENT TRAP OR BASIN.
- F. DISTURBED AREAS SHALL BE STABILIZED WITH TEMPORARY OR PERMANENT MEASURES WITHIN SEVEN (7) CALENDAR DAYS FOLLOWING THE END OF ACTIVE HYDROLOGIC DISTURBANCE OR REDISTURBANCE.
- G. ALL STOCKPILES SHALL HAVE APPROPRIATE MEASURES TO PREVENT EROSION. STOCKPILES SHALL NOT BE PLACED IN FLOOD PRONE AREAS OR WETLANDS AND DESIGNATED BUFFERS.
- H. SLOPES STEEPER THAN 3H:1V SHALL BE STABILIZED WITH APPROPRIATE MEASURES AS APPROVED BY THE ENFORCEMENT OFFICER.
- I. APPROPRIATE EROSION CONTROL BLANKET SHALL BE INSTALLED ON ALL INTERIOR DETENTION BASIN SIDE SLOPES BETWEEN THE NORMAL WATER LEVEL AND HIGH WATER LEVEL.
- J. STORM SEWERS THAT ARE OR WILL BE FUNCTIONING DURING CONSTRUCTION SHALL BE PROTECTED BY AN APPROPRIATE SEDIMENT CONTROL MEASURE.
- K. IF DEWATERING SERVICES ARE USED, ADJOINING PROPERTIES AND DISCHARGE LOCATIONS SHALL BE PROTECTED FROM EROSION AND SEDIMENTATION. DISCHARGES SHALL BE ROUTED THROUGH AN APPROVED ANIONIC POLYMER DEWATERING SYSTEM OR A SIMILAR MEASURE AS APPROVED BY THE ENFORCEMENT OFFICER. DEWATERING SYSTEMS SHOULD BE INSPECTED DAILY DURING OPERATIONAL PERIODS. THE ENFORCEMENT OFFICER, OR APPROVED REPRESENTATIVE, MUST BE PRESENT AT THE COMMENCEMENT OF DEWATERING ACTIVITIES.
- L. IF INSTALLED SOIL EROSION AND SEDIMENT CONTROL MEASURES DO NOT MINIMIZE SEDIMENT LEAVING THE DEVELOPMENT SITE, ADDITIONAL MEASURES SUCH AS ANIONIC POLYMERS OR FILTRATION SYSTEMS MAY BE REQUIRED BY THE ENFORCEMENT OFFICER.
- M. ALL TEMPORARY AND PERMANENT EROSION CONTROL MEASURES MUST BE MAINTAINED AND REPAIRED AS NEEDED. THE PROPERTY OWNER SHALL BE ULTIMATELY RESPONSIBLE FOR MAINTENANCE AND REPAIR.
- N. ALL TEMPORARY SEDIMENT CONTROL MEASURES SHALL BE REMOVED WITHIN 30 DAYS AFTER FINAL SITE STABILIZATION IS ACHIEVED OR AFTER THE TEMPORARY MEASURES ARE NO LONGER NEEDED.
- O. THE EROSION CONTROL MEASURES INDICATED ON THE PLANS ARE THE MINIMUM REQUIREMENTS. ADDITIONAL MEASURES MAY BE REQUIRED, AS DIRECTED BY THE ENGINEER, ENFORCEMENT OFFICER, OR OTHER GOVERNING AGENCY.

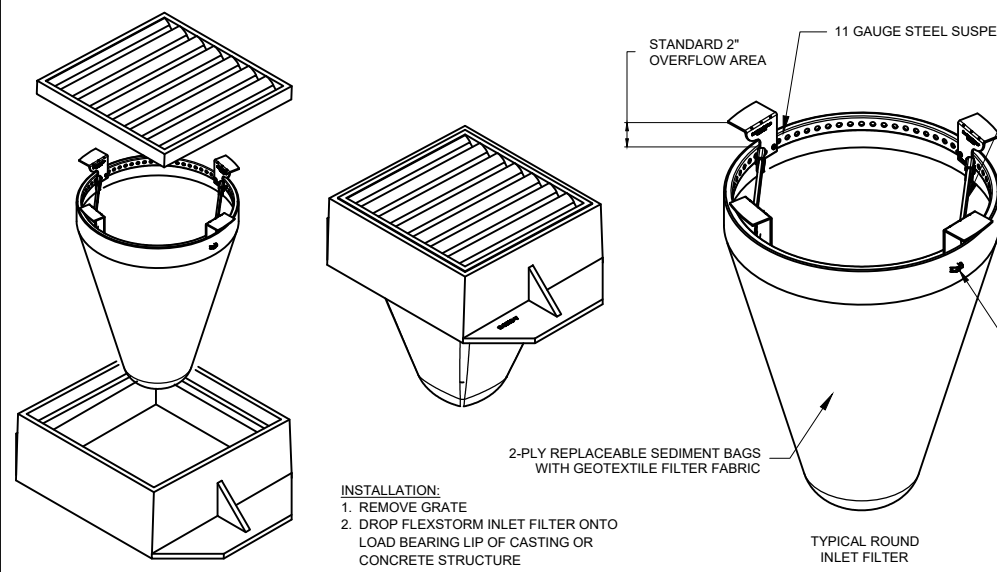

- INSTALLATION:**
1. REMOVE GRATE
 2. DROP FLEXSTORM INLET FILTER ONTO LOAD BEARING LIP OF CASTING OR CONCRETE STRUCTURE
 3. REPLACE GRATE

NOTES:

1. FILTER FABRIC INLET PROTECTION SHALL CONSIST OF INLET BASKET AND FABRIC INSERT, FLEXSTORM CATCH-IT BY ADVANCED DRAINAGE SYSTEMS, FLOGARD TEMPORARY INLET FILTER BY OLDCASTLE, OR APPROVED EQUAL.
2. DEVICE SHALL BE EQUIPPED WITH AN OVERFLOW FEATURE SO DRAINAGE TO INLET IS NOT COMPLETELY BLOCKED IF DEVICE IS FULL OF SILT.
3. INLET BASKET IS AVAILABLE TO FIT ROUND, RECTANGULAR, BEEHIVE OR CURB INLET CASTINGS.
4. FILTER FABRIC SHALL HAVE AN APPARENT OPENING SIZE (AOS) OF AT LEAST 70 SIEVE FOR NONWOVEN.
5. FILTER FABRIC SHALL HAVE A GRAB TENSILE STRENGTH OF A LEAST 100 LBS FOR NON WOVEN.
6. POLYESTER OUTER REINFORCEMENT BAG SHALL HAVE FABRIC WITH A WEIGHT OF 4.55 OZ/SQYD +/- 15 PERCENT.
7. FRAME CONSTRUCTION SHALL HAVE A TENSILE STRENGTH OF AT LEAST 58,000 PSI AND A YIELD STRENGTH OF AT LEAST 36,000 PSI.
8. MAINTENANCE SHALL BE PERFORMED AS NEEDED. REMOVE SILT FROM FABRIC INSERT WHEN 50% OF CAPACITY IS REACHED. REMOVE SILT FROM INTERIOR AND EXTERIOR OF INLET DAM WHEN 50% OF DAM HEIGHT IS REACHED.
9. PAYMENT FOR INLET PROTECTION MAINTENANCE SHALL BE INCIDENTAL TO INLET PROTECTION.

INLET PROTECTION AT MANHOLES IN IMPERVIOUS AREAS

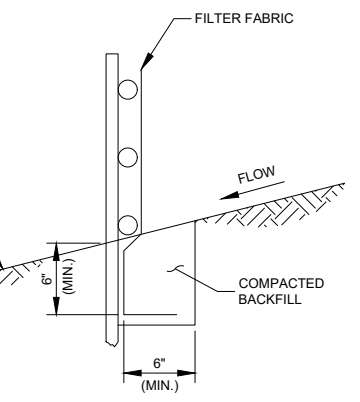

FABRIC ANCHOR DETAIL

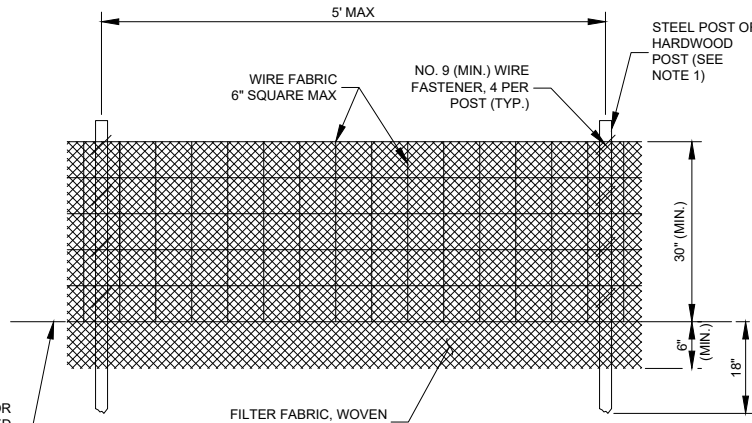

ELEVATION

NOTES:

1. FENCE POST SHALL BE EITHER STEEL 1/2\"/>
2. TOP AND BOTTOM WIRE OF WIRE FABRIC SHALL BE MINIMUM GAGE NO. 9. INTERMEDIATE WIRES OF THE WIRE FABRIC SHALL BE MINIMUM GAGE NO. 11.
3. WIRE FABRIC SHALL BE SECURELY FASTENED TO FENCE POSTS WITH NO. 9 GAGE WIRE MINIMUM. FOUR (4) FASTENERS PER POST REQUIRED.
4. FILTER FABRIC SHALL BE SECURELY FASTENED TO WIRE FABRIC AND POSTS WITH TIES OR STAPLES SPACED AT 12\"/>
5. WHEN TWO SECTIONS OF FILTER FABRIC MEET, THEY SHALL BE OVERLAPPED BY 6\"/>
6. FILTER FABRIC SHALL BE IN ACCORDANCE WITH SPECIAL PROVISIONS WITH APPARENT OPENING SIZE (AOS) OF AT LEAST 40 FOR NONWOVEN AND WOVEN. THE FABRIC MUST MEET THE APPLICABLE STANDARDS OF AASHTO 288-00 (Article IV, Section B.1.j.1.f.i, AS AMENDED), OR EQUIVALENT.
7. A MAXIMUM OF 5 FEET IS USED FOR POST-TO-POST SPACING.
8. SOIL DISTURBANCE SHALL BE PERFORMED AS NEEDED AND MATERIAL REMOVED AND REPLACED WHEN BULGES DEVELOP IN THE SILT FENCE.
9. ALL STORM SEWERS THAT ARE OR WILL BE FUNCTIONING DURING CONSTRUCTION SHALL BE PROTECTED BY AN APPROPRIATE SEDIMENT CONTROL MEASURE.
10. SILT FENCE SHALL BE INSTALLED PRIOR TO ANY GRADING WORK IN THE AREA TO BE PROTECTED. PERIODIC INSPECTION SHALL BE PERFORMED AND REQUIRED MAINTENANCE SHALL BE PROVIDED AFTER EACH RAIN EVENT.
11. MAINTENANCE SHALL BE PERFORMED AS NEEDED AND MATERIAL REMOVED AND REPLACED WHEN BULGES DEVELOP IN THE SILT FENCE.
12. IF DEWATERING SERVICES ARE USED, ADJOINING PROPERTIES AND DISCHARGE LOCATIONS SHALL BE PROTECTED FROM EROSION. DISCHARGES SHALL BE ROUTED THROUGH AN EFFECTIVE SEDIMENT CONTROL MEASURE (E.G. SEDIMENT TRAP, SEDIMENT BASIN, OR OTHER APPROPRIATE MEASURE).
13. FENCE POSTS SHALL BE REMOVED WHEN DIRECTED AT PROJECT END.
14. THE EROSION CONTROL MEASURES INDICATED ON THE PLANS ARE THE MINIMUM REQUIREMENTS. ADDITIONAL MEASURES MAY BE REQUIRED, AS DIRECTED BY THE ENGINEER OR GOVERNING AGENCY.

STORM WATER POLLUTION PREVENTION NOTES

GENERAL
THE CONTRACTOR SHALL IMPLEMENT ALL PROVISIONS OF THE CONTRACT DOCUMENTS TO ASSURE THAT STORM WATER POLLUTION PREVENTION ITEMS ARE CONSTRUCTED AND MAINTAINED IN A TIMELY MANNER. SEDIMENTATION MUST NOT BE TRANSPORTED OFF THE CONSTRUCTION SITE. PERMANENT DRAINAGE FEATURES AND VEGETATIVE MEASURES SHALL BE PROVIDED AS SOON AS POSSIBLE.

THE MAINTENANCE OF ALL STORM WATER POLLUTION PREVENTION MEASURES IS INCIDENTAL TO THE ASSOCIATED ITEM.

POLLUTION PREVENTION MEASURES
THE CONTRACTOR SHALL BE REQUIRED TO IMPLEMENT AND MAINTAIN STORM WATER POLLUTION PREVENTION PRACTICES AND MEASURES PRIOR TO THE STRIPPING OF EXISTING VEGETATION WHEREVER POSSIBLE AND AS SOON AS CONSTRUCTION PERMITS IN OTHER AREAS. POLLUTION CONTROL MEASURES SHALL BE IN ACCORDANCE WITH THE CONTRACT DOCUMENTS, INCLUDING THESE CONSTRUCTION PLANS, AND WITH STANDARDS AND SPECIFICATIONS FOR SOIL EROSION AND SEDIMENT CONTROL, ILLINOIS ENVIRONMENTAL PROTECTION AGENCY, CURRENT ISSUE. THE CONTRACTOR SHALL ADJUST HIS OPERATIONS AND IMPLEMENT POLLUTION CONTROL MEASURES SO THAT NO RUNOFF FROM STRIPPED AREAS WILL LEAVE THE CONSTRUCTION SITE OTHER THAN THROUGH SEDIMENT TRAPS OR OTHER SUITABLE CONTROL MEASURES.

POLLUTION CONTROL ITEMS SHALL BE PROVIDED AS NOTED ON THE STORM WATER POLLUTION PREVENTION PLAN AND IN THE STORM WATER POLLUTION PREVENTION DETAILS AND AS DIRECTED BY THE ENGINEER. THE LIMITS OF SUCH MEASURES SHALL BE STAKED BY THE CONTRACTOR PRIOR TO THE COMMENCEMENT OF CONSTRUCTION. SUCH LIMITS MAY BE ADJUSTED BY THE ENGINEER TO ACCOUNT FOR ACTUAL SITE CONDITIONS EXPERIENCED DURING CONSTRUCTION. ADDITIONAL COMPENSATION FOR MEASURES EXCEEDING THE PLAN QUANTITIES WILL BE PAID FOR AT THE CONTRACT UNIT PRICE FOR EACH ITEM.

THE CONTRACTOR IS TO MAINTAIN AND ADJUST, REPAIR OR REPLACE ALL POLLUTION PREVENTION MEASURES AS REQUIRED OR AS DIRECTED BY THE ENGINEER UNTIL PERMANENT VEGETATION HAS BEEN ESTABLISHED. MAINTENANCE OF POLLUTION CONTROL MEASURES IS TO BE PROVIDED AT NO ADDITIONAL COST TO THE CONTRACT.

ADDITIONAL STORMWATER POLLUTION PREVENTION MEASURES ARE EXISTING ON SITE LOCATED AT DRAINAGE FACILITIES AND ALONG THE PROPERTY LINE.

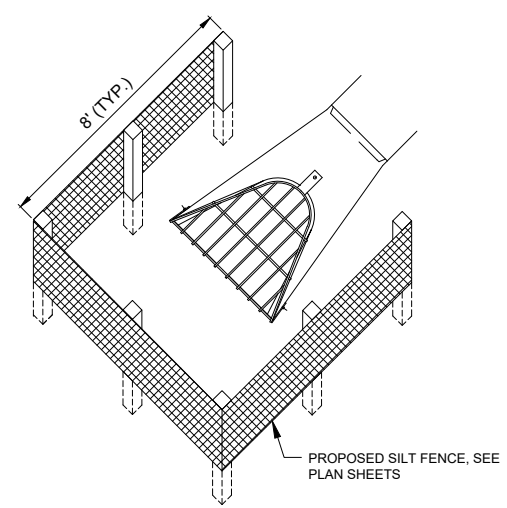

SILT FENCE PLACEMENT AT FLARED END SECTIONS (FES)

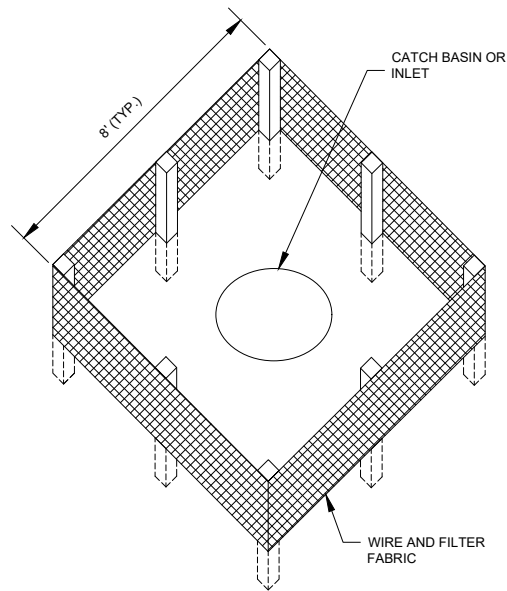

SILT FENCE AT MANHOLES IN PERVIOUS AREAS

NOTES:

1. FILTER FABRIC SHALL BE EMBEDDED 8\"/>
2. INSPECTION SHALL BE FREQUENT AND REPAIR/REPLACEMENT SHALL BE MADE PROMPTLY AS NEEDED.
3. SILT FENCE SHALL BE REMOVED WHEN IT HAS SERVED ITS USEFULNESS AT THE DIRECTION OF THE AIRPORT REPRESENTATIVE OR OWNER SO AS NOT TO BLOCK OR IMPEDE STORM FLOW OR DRAINAGE. CONTRACTOR SHALL PLACE SEED AND MULCH AROUND STRUCTURES PER LANDSCAPING PLAN. COST OF REMOVAL SHALL BE INCLUDED IN THE CONTRACT UNIT PRICE FOR SILT FENCE.
4. AREAS DISTURBED OUTSIDE OF CONSTRUCTION LIMITS DURING PLACEMENT OF INLET PROTECTION TO BE RE-GRADED, SEEDED AND MULCHED, COST INCIDENTAL TO SILT FENCE.
5. FENCE AND POSTS SHALL BE REMOVED WHEN DIRECTED AT PROJECT END.
6. PAID UNDER AR156510 SILT FENCE

NO.	DATE	DESCRIPTION		
		DES	DWN	REV

SHEET TITLE

STORM WATER POLLUTION PREVENTION PLAN DETAILS

FOR BID



Lindsay Hausman

NO.	DATE	DESCRIPTION		
		DES	DWN	REV

ISSUE: SEPTEMBER 22, 2023
PROJECT NO: 22A0007D
CAD FILE: C-120-PAV.DWG
DESIGN BY: MJD 7/28/2023
DRAWN BY: CWS 7/28/2023
REVIEWED BY: LDH 9/22/2023

SHEET TITLE

PROPOSED CONSTRUCTION PLAN - PARKING LOT

PAVEMENT LAYOUT (PARKING LOT)				
POINT	EASTING	NORTHING	STATION	OFFSET (R+ / L-)
1	950274.637	729105.891	3+65.10	7.27
2	950276.553	729105.924	3+65.11	9.19
3	950296.553	729085.924	3+44.93	29.00
4	950297.748	729101.745	3+60.74	30.34
5	950306.025	729090.923	3+49.84	38.52
6	950308.025	729090.923	3+49.82	40.52
7	950308.025	729101.594	3+60.49	40.62
8	950324.220	729101.695	3+60.44	56.81
9	950364.262	729101.497	3+59.87	96.85
10	950324.219	729096.344	3+55.09	56.76
11	950337.219	729096.344	3+54.97	69.76
12	950324.219	729085.344	3+44.09	56.66
13	950337.219	729085.344	3+43.97	69.66
14	950364.291	729085.468	3+43.84	96.73
15	950360.769	729085.344	3+43.75	93.21
16	950360.910	729067.340	3+25.75	93.18
17	950356.905	729067.340	3+25.78	89.18
18	950344.280	729067.340	3+25.90	76.55
19	950357.310	729024.498	2+82.94	89.18
20	950344.280	729024.498	2+83.06	76.15
21	950357.346	729020.498	2+78.94	89.18
22	950344.280	729020.498	2+79.06	76.12
23	950361.572	728996.498	2+54.90	93.18
24	950357.623	728989.404	2+47.84	89.17
25	950350.675	728976.864	2+34.62	82.10
26	950344.280	728972.635	2+26.34	75.52
27	950352.427	728965.105	2+08.25	82.60
28	950467.350	728966.085	0+36.25	165.20
29	950399.893	728824.861	0+20.07	9.53
30	950399.328	728824.036	0+20.12	8.54
31	950359.282	728847.782	0+66.67	7.89
32	950360.858	728850.441	0+66.72	10.98
33	950374.452	728854.005	0+56.98	21.11
34	950371.352	728867.456	0+66.65	30.97
35	950372.351	728869.172	0+66.69	32.95
36	950340.492	728890.168	1+10.66	32.40
37	950339.377	728888.511	1+10.33	30.42
38	950325.410	728885.655	1+20.13	18.75
39	950328.221	728871.911	1+07.50	10.57
40	950326.715	728869.671	1+07.17	7.89
41	950306.500	728888.180	1+35.94	6.31
42	950292.161	728908.659	1+62.02	5.77
43	950281.595	728931.316	1+88.00	5.26
44	950277.254	728955.937	2+14.03	6.96
45	950275.395	729026.458	2+85.66	7.29
46	950274.637	729080.891	3+40.10	7.04
47	950280.280	729019.567	2+78.73	12.11
48	950282.280	729021.567	2+80.71	14.13
49	950296.780	729021.567	2+80.57	28.63
50	950298.780	729019.567	2+78.55	30.61
51	950298.780	729013.567	2+72.55	30.55
52	950296.780	729011.567	2+70.57	28.54
53	950282.280	729011.567	2+70.71	14.04
54	950280.280	729013.567	2+72.73	12.05
55	950333.799	728880.211	1+08.80	20.50
56	950365.850	728859.106	0+66.98	20.97
57	950301.025	729090.924	3+49.89	33.52
58	950296.553	729105.924	3+64.93	29.19
59	950296.780	729019.567	2+78.57	28.61
60	950296.780	729013.567	2+72.57	28.55
61	950282.280	729019.567	2+78.71	14.11
62	950282.280	729013.567	2+72.71	14.05

LEGEND

- EXISTING OVERHEAD ELECTRIC
- EXISTING ELECTRIC
- EXISTING GAS
- EXISTING FIBER OPTIC
- EXISTING WATER
- EXISTING STORM SEWER
- EXISTING FENCE
- EXISTING POLE LIGHT
- PROPOSED HMA PAVEMENT
- PROPOSED PCC PAVEMENT
- CLEANOUT TO BE ADJUSTED
- FIRE HYDRANT

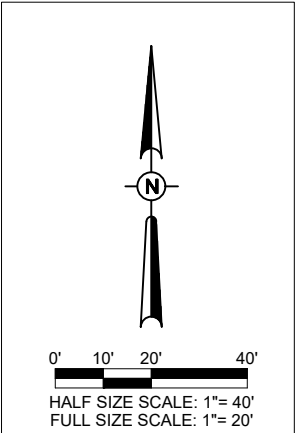

FOR BID

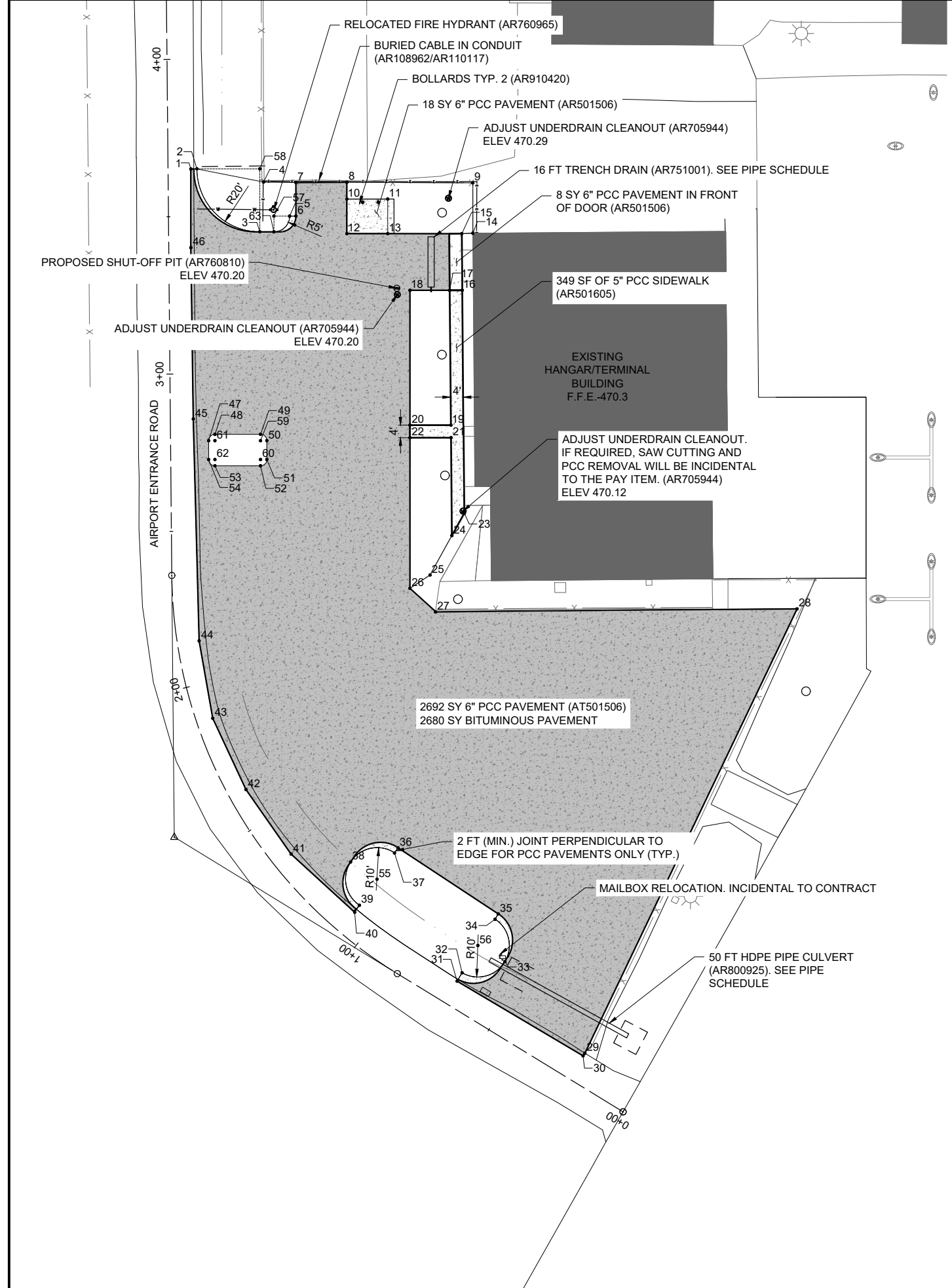

OCT 17, 2023 5:38 PM HALUSM00682
I:\22JOBS\22A0007D\CAD\AIRPORT\1SHEETC-120-PAV.DWG

FLORA MUNICIPAL AIRPORT

1 AIRPORT ROAD
FLORA, ILLINOIS 62839



DATE SIGNED: 9/22/2023 LICENSE EXPIRES: 11/30/2023

RECONSTRUCT AUTO PARKING LOT AND AIRCRAFT HANGAR ACCESS PAVEMENT

IDA No: FOA-4986

NO.	DATE	DESCRIPTION		
		DES	DWN	REV

ISSUE: SEPTEMBER 22, 2023

PROJECT NO: 22A0007D

CAD FILE: C-120-PAV.DWG

DESIGN BY: MJD 7/28/2023

DRAWN BY: CWS 7/28/2023

REVIEWED BY: LDH 9/22/2023

SHEET TITLE

PROPOSED CONSTRUCTION PLAN - HANGAR ACCESS

PAVEMENT LAYOUT (TAXIWAY)				
POINT	EASTING	NORTHING	STATION	OFFSET (R+ / L-)
64	950562.653	729298.003	2+94.74	-82.17
65	950566.652	729297.977	2+94.71	-78.17
66	950621.257	729297.640	2+94.37	-23.57
67	950629.151	729297.592	2+94.32	-15.67
68	950561.675	729145.279	1+42.01	-83.15
69	950561.769	729135.410	1+32.14	-83.06
70	950565.612	729135.481	1+32.21	-79.21
71	950628.112	729135.146	1+31.88	-16.71

LEGEND

- EXISTING OVERHEAD ELECTRIC
- EXISTING ELECTRIC
- EXISTING GAS
- EXISTING FIBER OPTIC
- EXISTING WATER
- EXISTING STORM SEWER
- EXISTING FENCE
- EXISTING POLE LIGHT
- PROPOSED HMA PAVEMENT
- PROPOSED PCC PAVEMENT

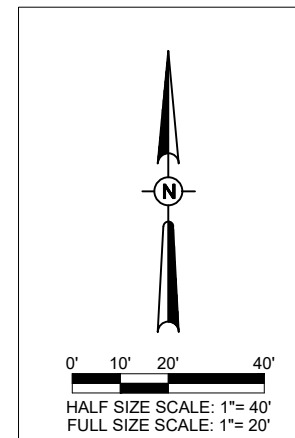

FOR BID

OCT 17, 2023 5:38 PM HAUSM00682 1:22:08S22A0007D\CAD\AIRPORT\ISHEET\C-120-PAV.DWG



DATE SIGNED: 9/22/2023 LICENSE EXPIRES: 11/30/2023

RECONSTRUCT AUTO PARKING LOT AND AIRCRAFT HANGAR ACCESS PAVEMENT

IDA No: FOA-4986

NO.	DATE	DESCRIPTION		
		DES	DWN	REV

ISSUE: SEPTEMBER 22, 2023

PROJECT NO: 22A0007D

CAD FILE: C-125-JNT.DWG

DESIGN BY: MJD 7/28/2023

DRAWN BY: CWS 7/28/2023

REVIEWED BY: LDH 9/22/2023

SHEET TITLE

PROPOSED PCC JOINTING PLAN

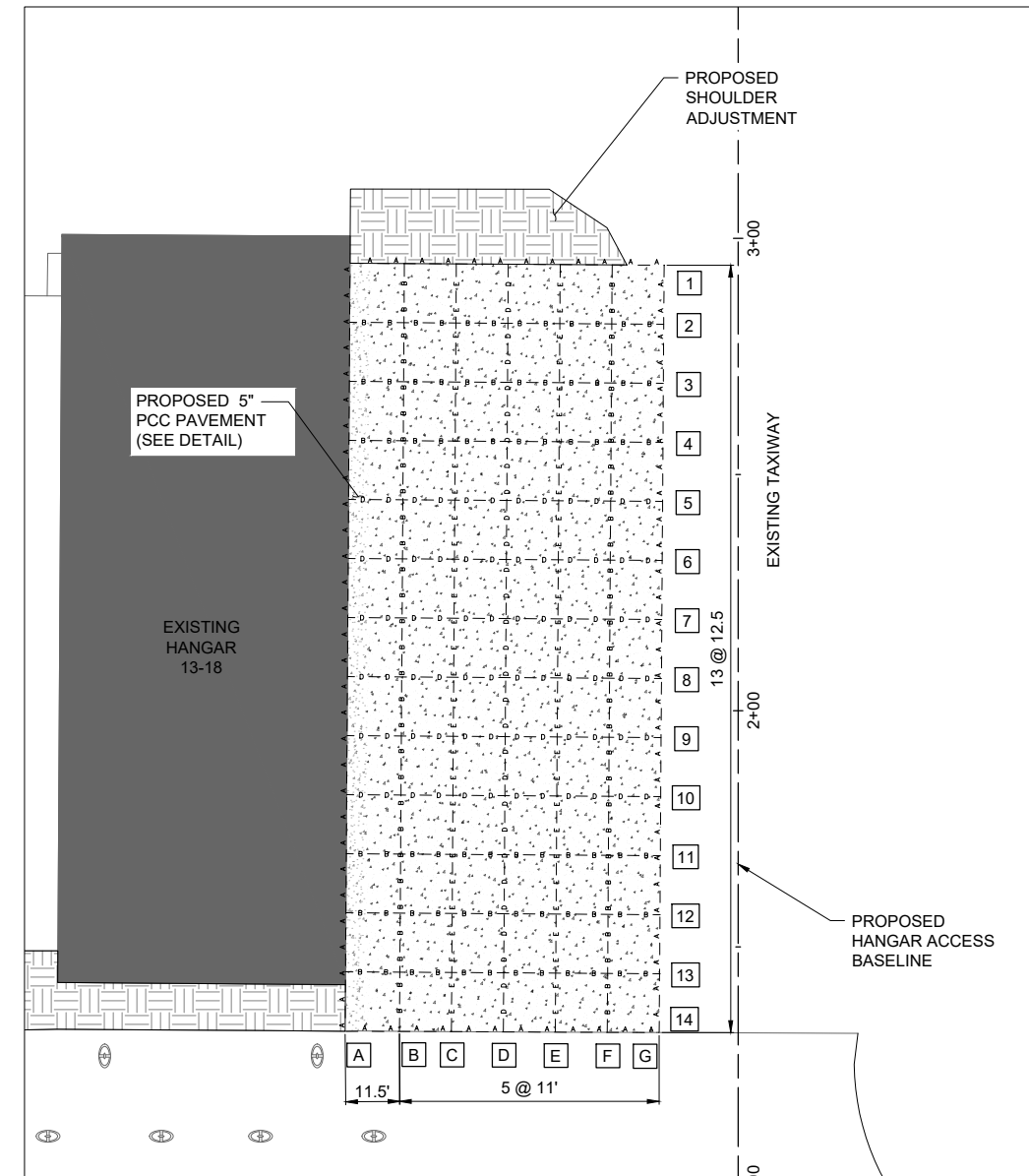
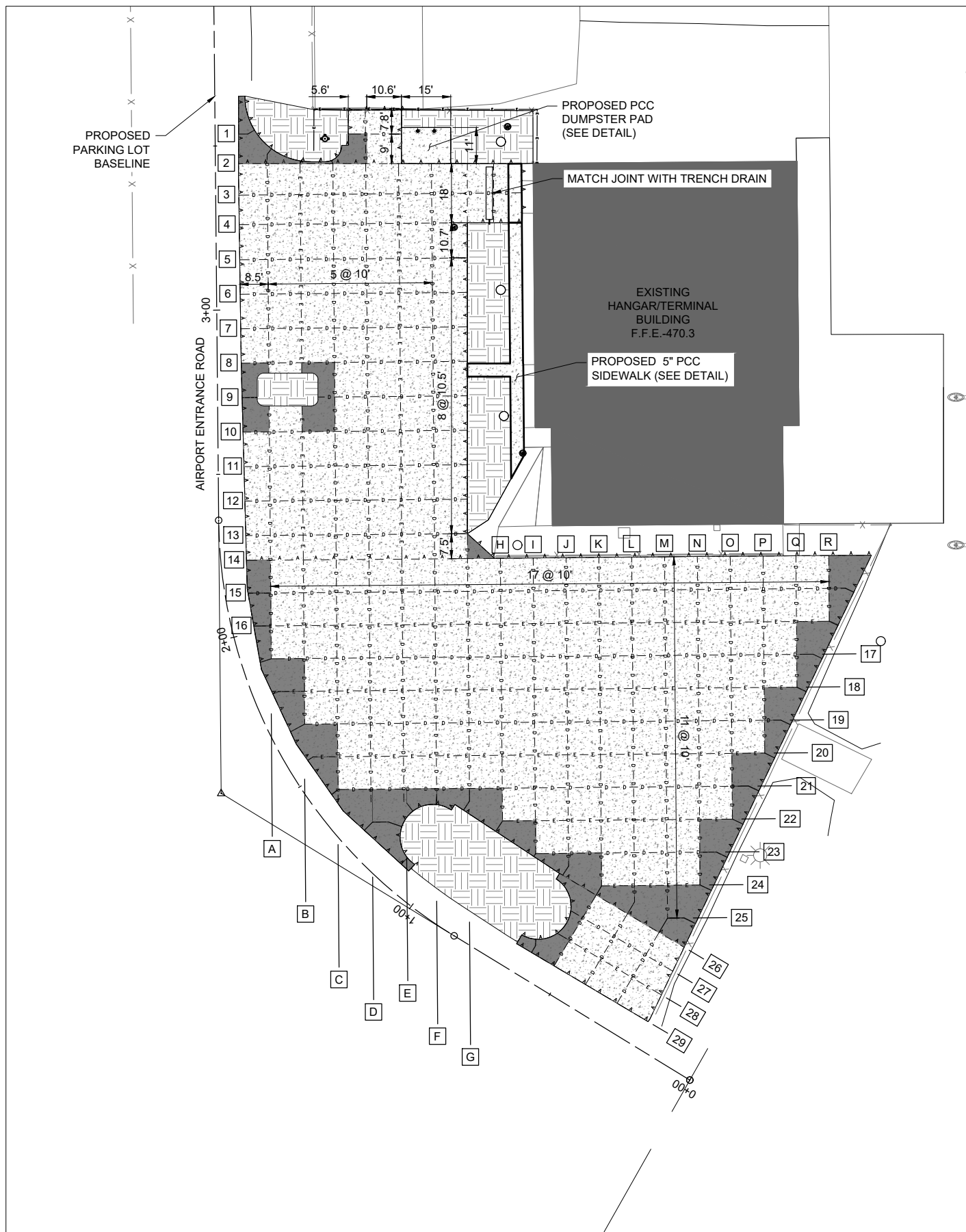

- LEGEND**
- A— TYPE A - THICKENED EDGE ISOLATION JOINT
 - B— TYPE B - HINGED CONTRACTION JOINT
 - D— TYPE D - DUMMY CONTRACTION JOINT
 - E— TYPE E - DOWELED CONSTRUCTION JOINT
 - PROPOSED REINFORCED SLAB
 - PROPOSED PCC PAVEMENT
 - ▨ PROPOSED GRADING AREA

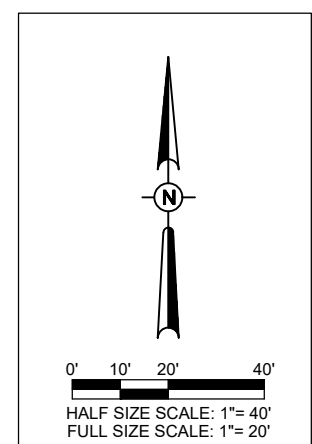

FOR BID



Lindsay Hausman

NO.	DATE	DESCRIPTION		
		DES	DWN	REV

ISSUE: SEPTEMBER 22, 2023

PROJECT NO: 22A0007D

CAD FILE: C-561-JNT.DWG

DESIGN BY: MJD 7/28/2023

DRAWN BY: CWS 7/28/2023

REVIEWED BY: LDH 9/22/2023

SHEET TITLE

PROPOSED JOINT
DETAILS

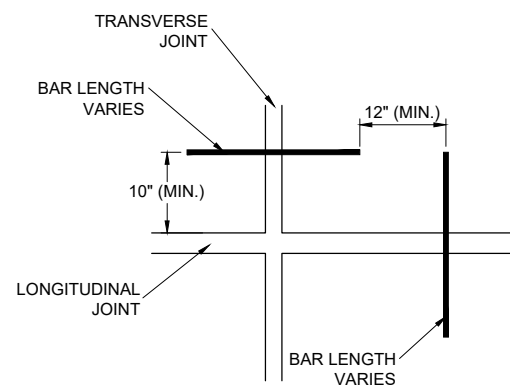
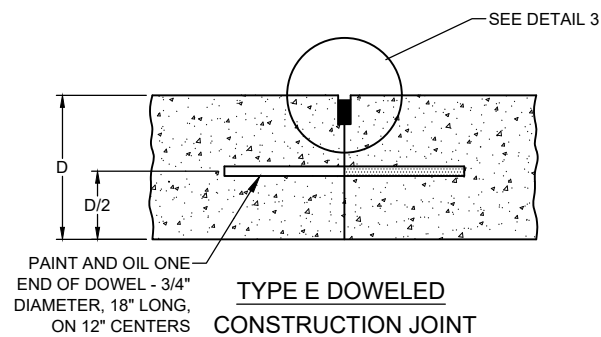
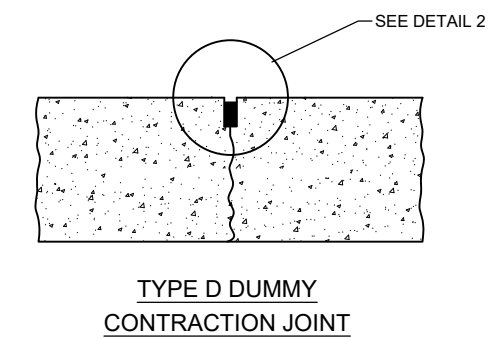
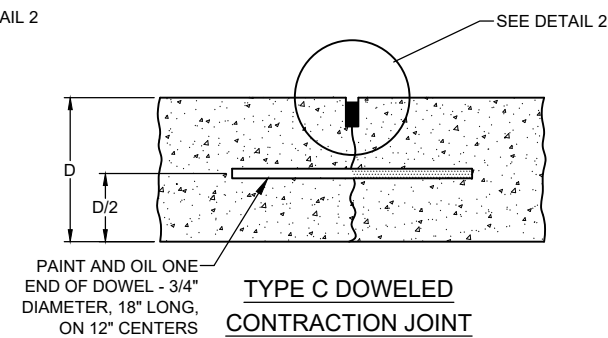
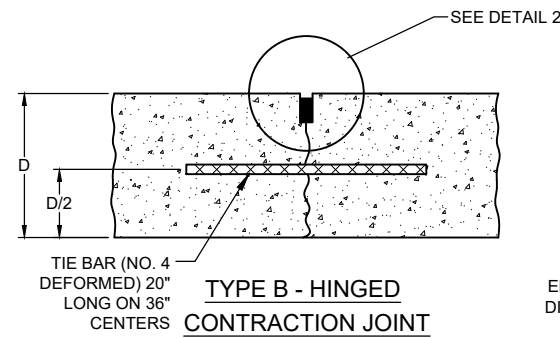
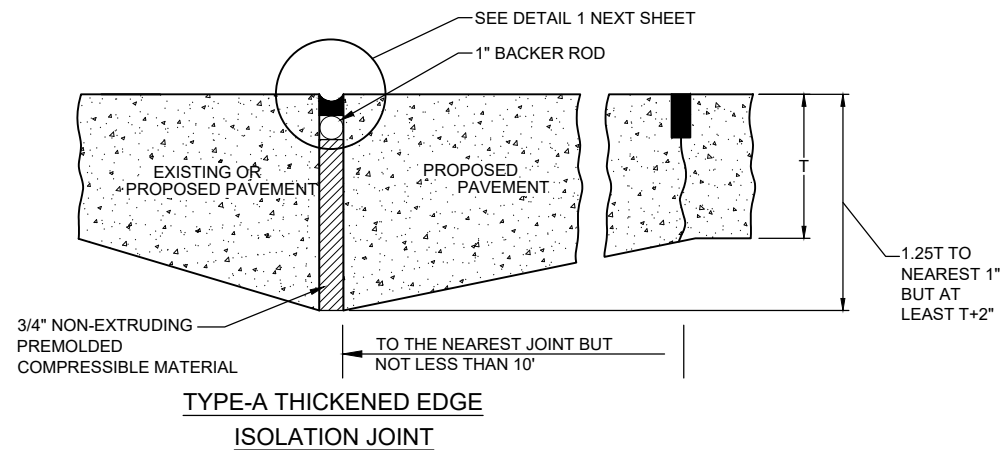

1. POSITION OF DOWELS AT EDGE OF JOINT TYPE C OR E
2. ELIMINATE DOWEL OR TIE BAR FROM LONGITUDINAL JOINT AS NECESSARY TO MAINTAIN 12 INCH FROM END OF TRANSVERSE DOWEL BARS

DOWEL PLAN VIEW

NOTES:

1. ALL WELDED WIRE FABRIC TO BE 12" X 12"- W5 X W5, WITH 65,000 PSI YIELD STRENGTH. WIRE SIZE AND SPACING MAY BE ALTERED AS LONG AS A MINIMUM W4 WIRE SIZE IS USED AND THE SECTIONAL AREA IS A MINIMUM OF 0.05 SQUARE INCHES PER FOOT AND 12" MAX WIRE SPACING.
2. EDGE SPACING FOR THE WELDED WIRE FABRIC TO BE THREE (3) INCHES. A MINIMUM OF THREE (3) WIRES ARE TO BE PROVIDED IN ANY ONE DIRECTION IN EACH SLAB.
3. WELDED WIRE FABRIC, JOINT REINFORCING, JOINT EXPANSION MATERIAL AND JOINT SAWING AND SEALING ARE INCIDENTAL TO P.C.C. PAVEMENT.
4. SEE STAKING PLAN FOR ELEVATIONS.

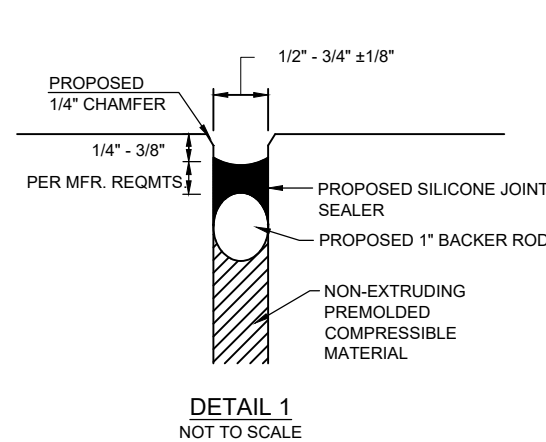

DETAIL 1
NOT TO SCALE

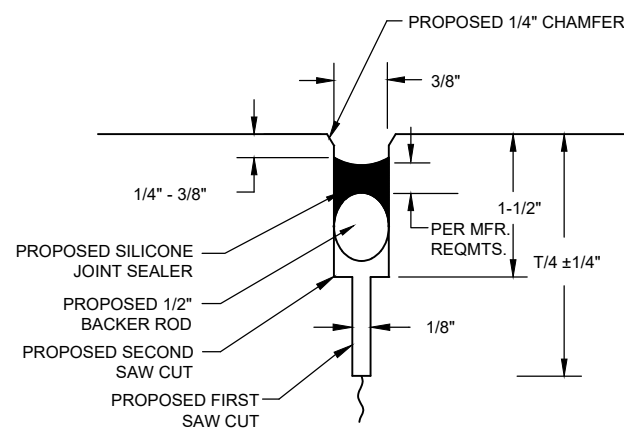

DETAIL 2
NOT TO SCALE

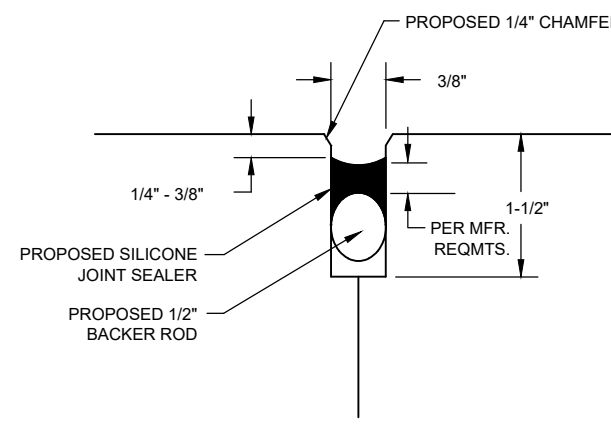

DETAIL 3
NOT TO SCALE

JOINT SEALING DETAILS
NOT TO SCALE

FLORA MUNICIPAL AIRPORT

1 AIRPORT ROAD
FLORA, ILLINOIS 62839



Lindsay Hausman

DATE SIGNED: 9/22/2023 LICENSE EXPIRES: 11/30/2023

RECONSTRUCT AUTO PARKING LOT AND AIRCRAFT HANGAR ACCESS PAVEMENT

IDA No: FOA-4986

NO.	DATE	DESCRIPTION		
		DES	DWN	REV

ISSUE: SEPTEMBER 22, 2023

PROJECT NO: 22A0007D

CAD FILE: C-302-TYP.DWG

DESIGN BY: MJD 7/28/2023

DRAWN BY: CWS 7/28/2023

REVIEWED BY: LDH 9/22/2023

SHEET TITLE

REFUSE DISPOSAL AREA DETAILS

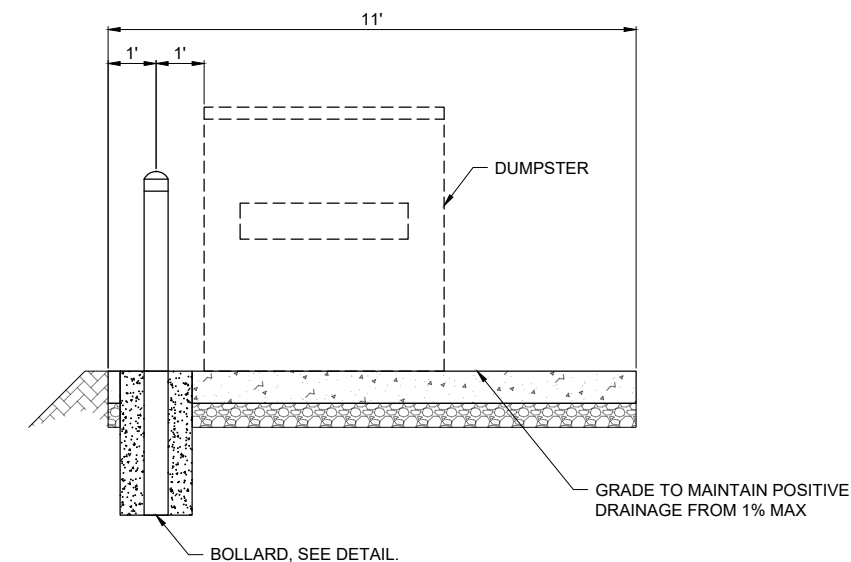

SIDE VIEW

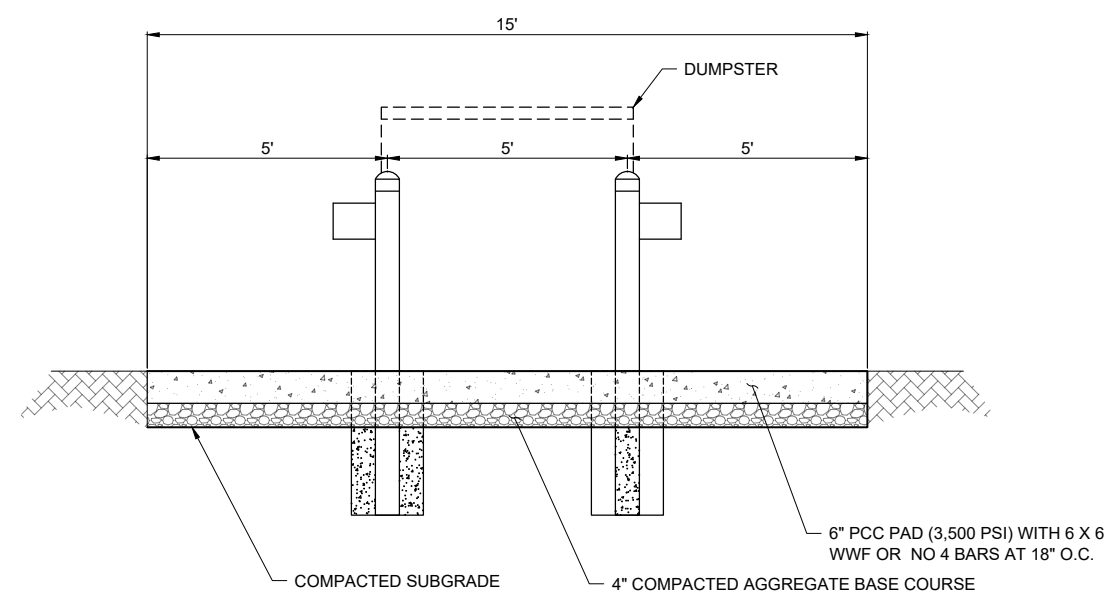

FRONT VIEW

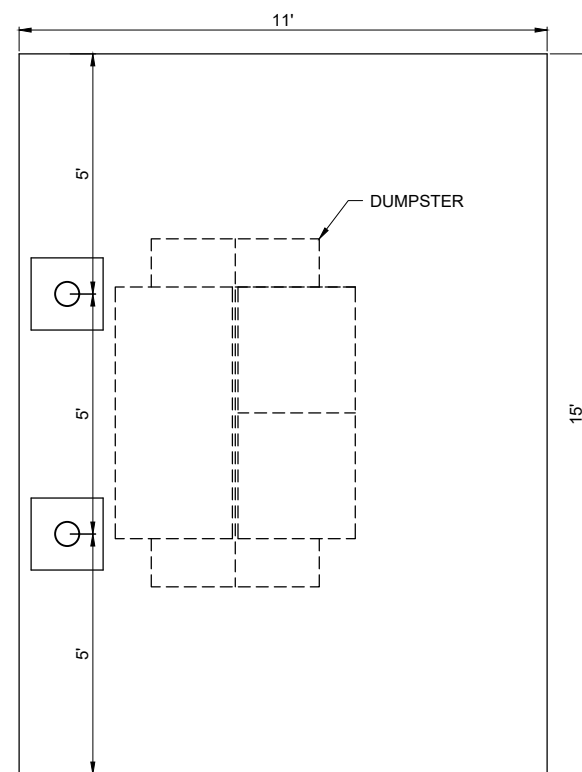

TOP VIEW

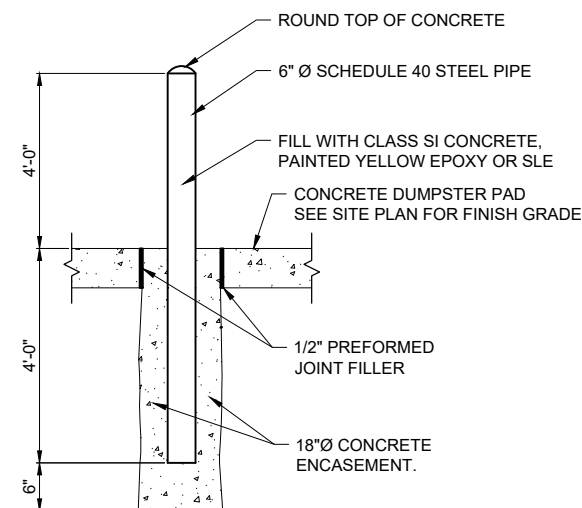

BOLLARD DETAIL
NOT TO SCALE

OCT 17, 2023 5:39 PM HAUSM00682
I:\22\JOBS\22A0007D\CAD\AIRPORT\18SHEETC-302-TYP.DWG

FOR BID

FLORA MUNICIPAL AIRPORT
1 AIRPORT ROAD
FLORA, ILLINOIS 62839



DATE SIGNED: 9/22/2023
LICENSE EXPIRES: 11/30/2023

RECONSTRUCT AUTO PARKING LOT AND AIRCRAFT HANGAR ACCESS PAVEMENT

IDA No: FOA-4986

NO.	DATE	DESCRIPTION		
		DES	DWN	REV

ISSUE: SEPTEMBER 22, 2023

PROJECT NO: 22A0007D
CAD FILE: C-105-MRK.DWG
DESIGN BY: MJD 7/28/2023
DRAWN BY: CWS 7/28/2023
REVIEWED BY: LDH 9/22/2023

SHEET TITLE

PROPOSED MARKING PLAN

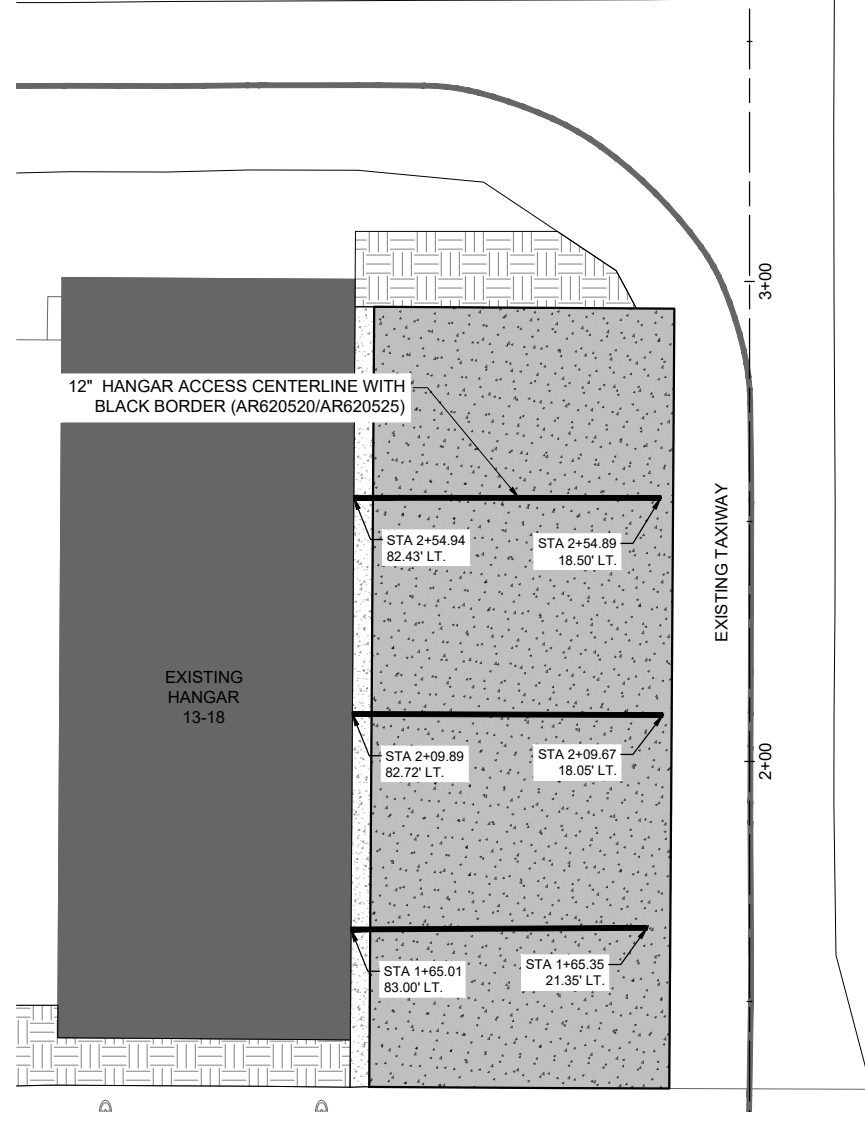
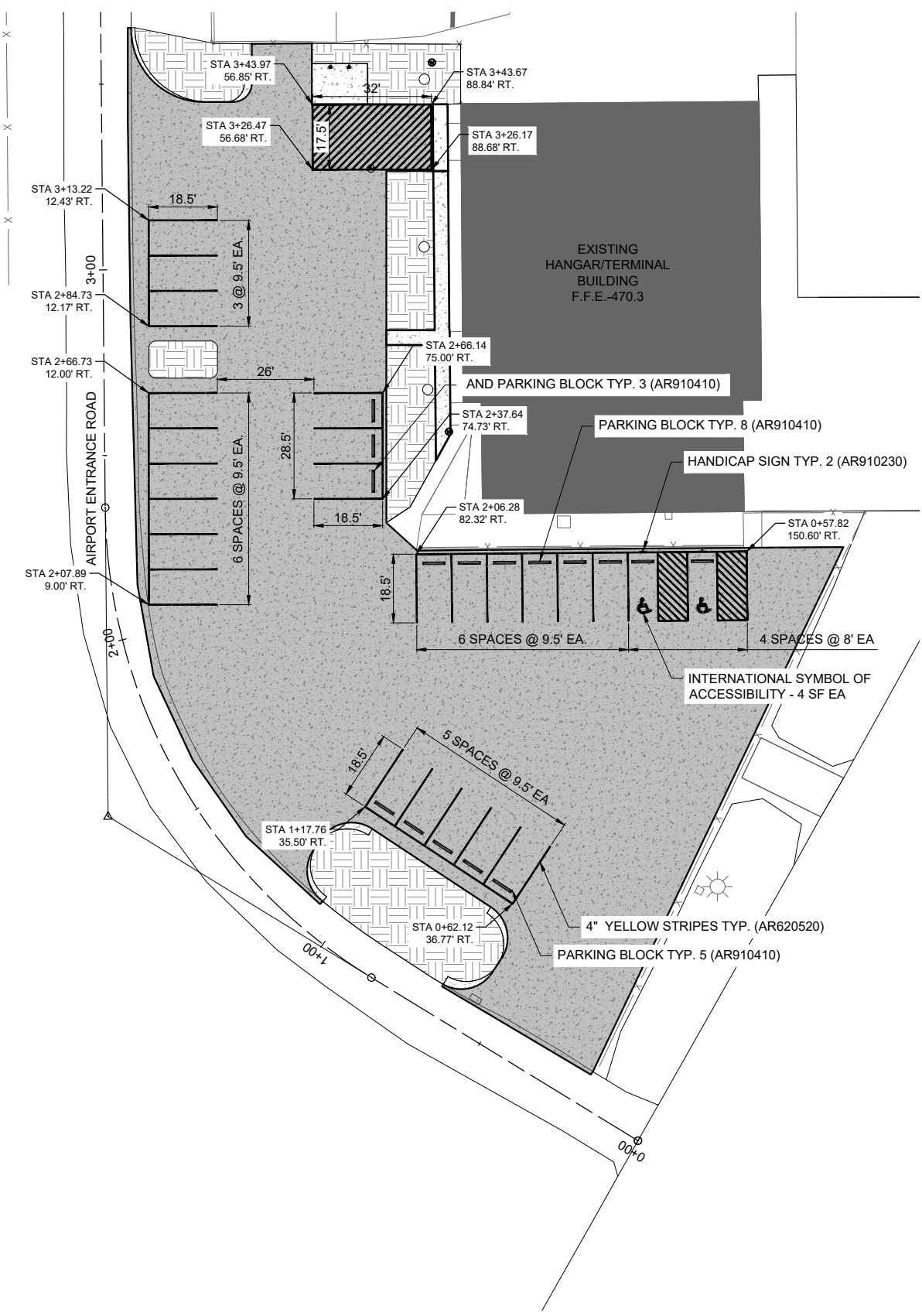

- NOTES:**
1. ALL PARKING LOT MARKING WILL BE YELLOW (AR620520) AND 4" IN WIDTH.
 2. SEE PROPOSED MARKING AND SIGNING DETAIL SHEET FOR ADDITIONAL INFORMATION.

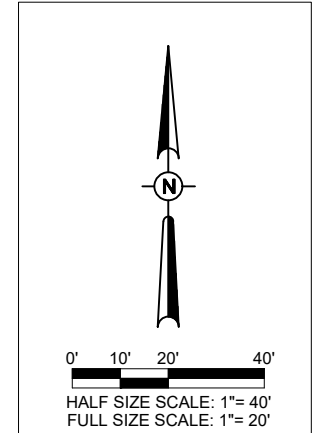

FOR BID



DATE SIGNED: 9/22/2023 LICENSE EXPIRES: 11/30/2023

RECONSTRUCT AUTO PARKING LOT AND AIRCRAFT HANGAR ACCESS PAVEMENT

IDA No: FOA-4986

NO.	DATE	DESCRIPTION		
		DES	DWN	REV

ISSUE: SEPTEMBER 22, 2023

PROJECT NO: 22A0007D

CAD FILE: C-502-DTL.DWG

DESIGN BY: MJD 7/28/2023

DRAWN BY: CWS 7/28/2023

REVIEWED BY: LDH 9/22/2023

SHEET TITLE

PROPOSED MARKING AND SIGN DETAILS

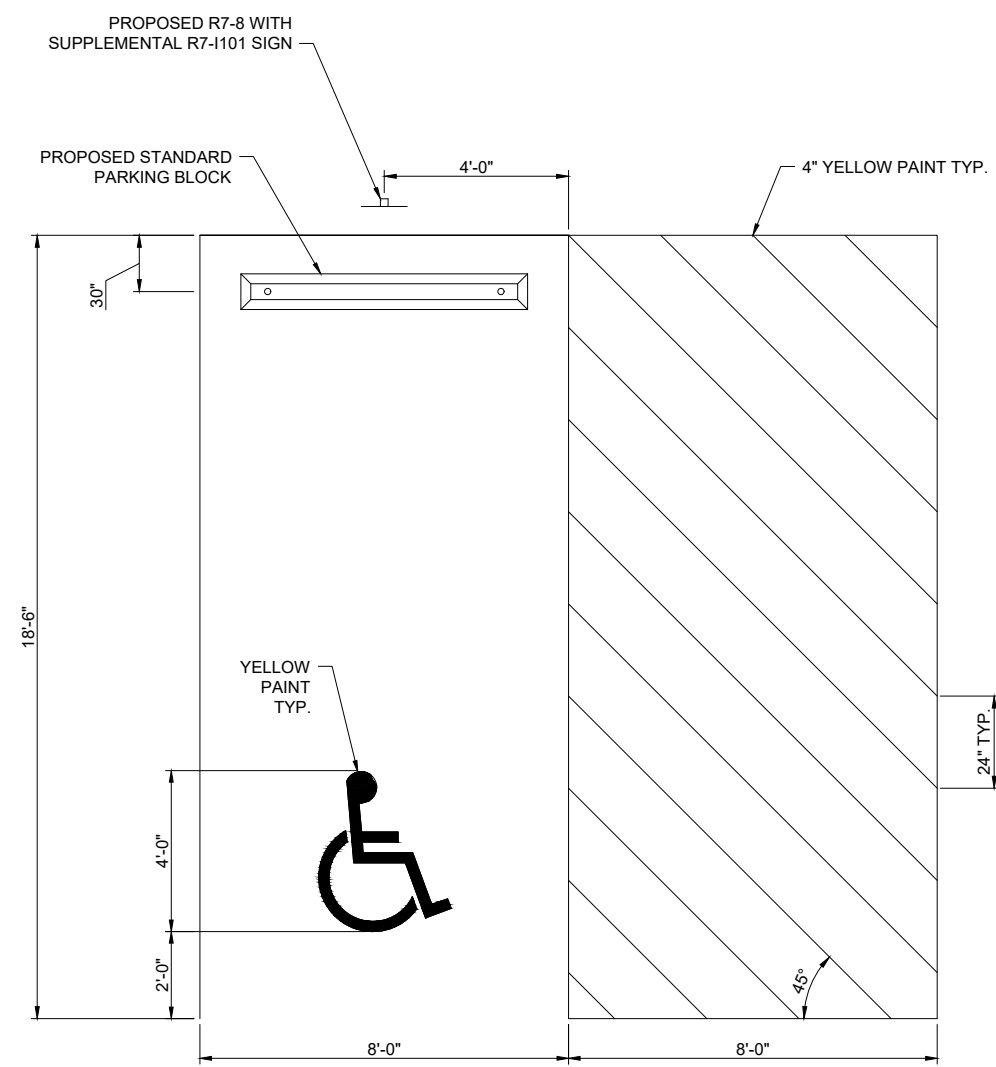

TYPICAL HANDICAPPED PARKING SPACE PAINT STRIPING
NOTE: CENTER SYMBOL AND PARKING BLOCK HORIZONTALLY IN STALL.

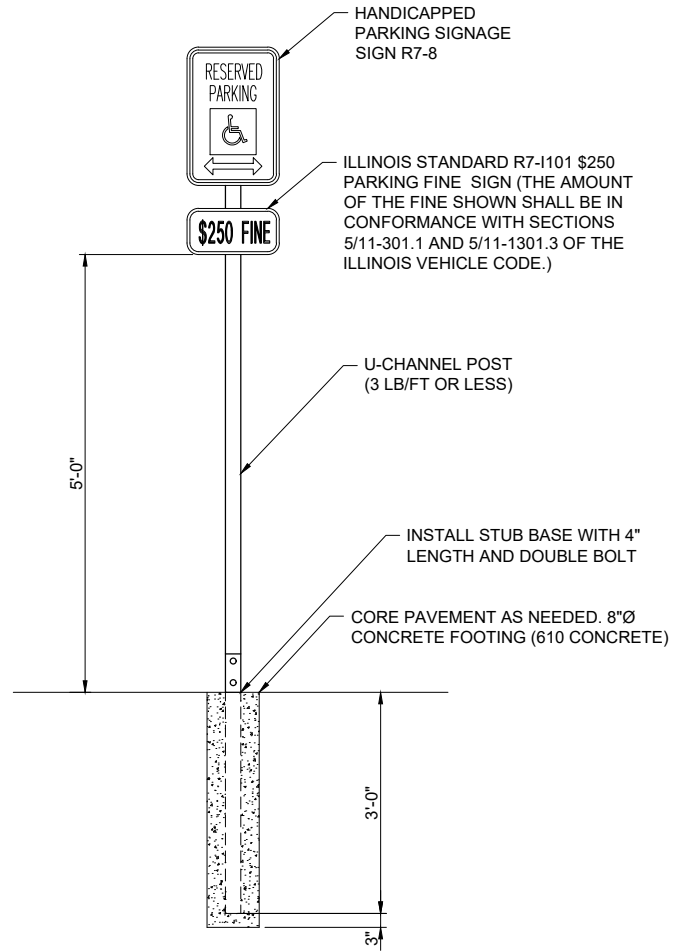

TYPICAL SIGNAGE DETAIL
NOT TO SCALE

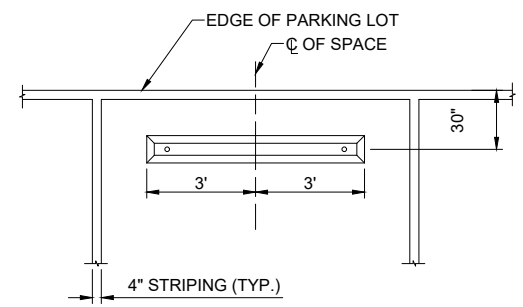

PARKING BLOCK LAYOUT
NOT TO SCALE

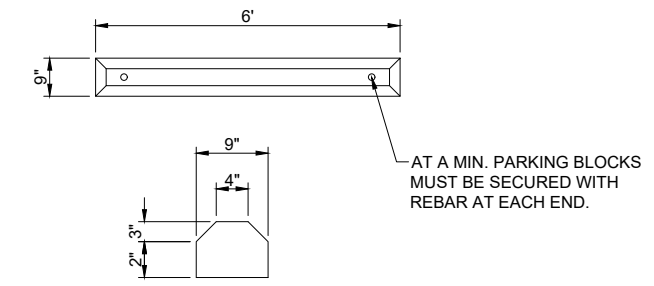

STANDARD PRE-CAST PARKING BLOCK
NOT TO SCALE

NOTES: A FUNCTIONAL EQUIVALENT OF THE STANDARD PARKING BLOCK MAY BE USED IF APPROVED BY THE ENGINEER AND AIRPORT MANAGER PRIOR TO INSTALLATION.

THE PARKING BLOCK SHALL BE INSTALLED WITH A MIN OF TWO PINS AT EACH END WITH A MIN EMBEDMENT OF 15" AND BE PAINTED YELLOW.

OCT 17, 2023 5:39 PM HAUSM00682 1:22:05S22A007D\CAD\AIRPORT\18HEETC-502-DTL.DWG

FOR BID



NO.	DATE	DESCRIPTION		
		DES	DWN	REV

ISSUE: SEPTEMBER 22, 2023

PROJECT NO: 22A0007D
CAD FILE: C-503-DRN.DWG
DESIGN BY: MJD 7/28/2023
DRAWN BY: CWS 7/28/2023
REVIEWED BY: LDH 9/22/2023

SHEET TITLE

TRENCH DRAIN, UNDERDRAIN DETAILS, AND DRAINAGE SCHEDULE

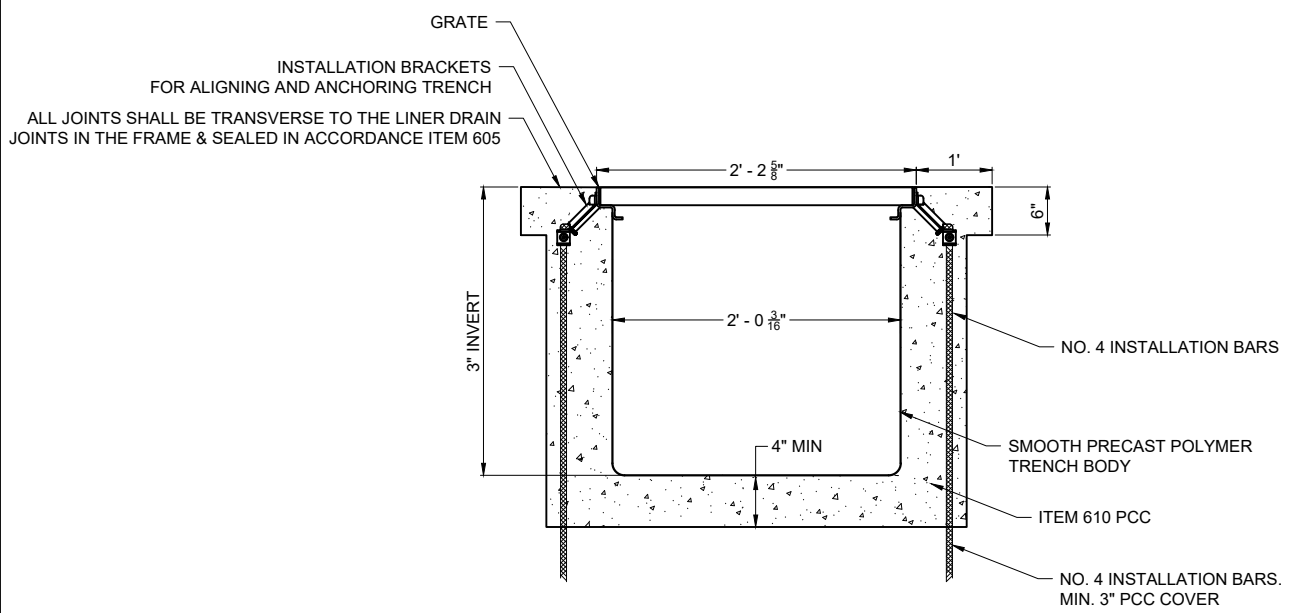

1. TRENCH DRAIN SHALL BE FROM DURA TRENCH, TRENCH DRAIN SYSTEMS (TDS), OR APPROVED EQUAL.
2. SLOPE SHALL BE 0.5%
3. TRENCH DRAIN MUST BE 1/8" BELOW CONCRETE GRADE
4. THE TRENCH DRAIN WILL BE CAPPED ON ONE END AND FITTED WITH A 3" SDR 35 PIPE (INCIDENTAL) ON ONE END TO DRAIN INTO A GRASS SWALE.

TRENCH SECTION
NOT TO SCALE

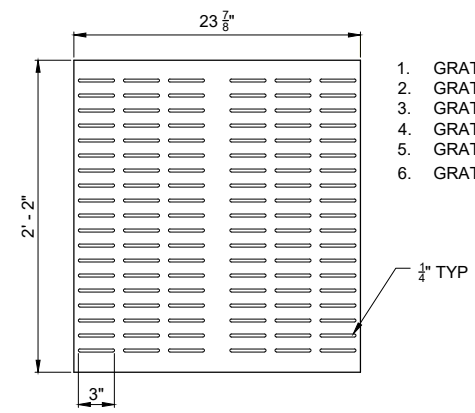

1. GRATE MATERIAL SHALL BE A36 CARBON STEEL
2. GRATES SHALL MEET LOAD CLASS D AND EXCEED H-20 LOADING
3. GRATES SHALL BE ADA COMPLIANT AND HEEL PROOF
4. GRATES SHALL BE POWDER COATED BLACK
5. GRATE AREA OPEN SHALL BE 30.16 IN² / LF
6. GRATES 1 1/2" THICK

CARBON STEEL GRATE
NOT TO SCALE

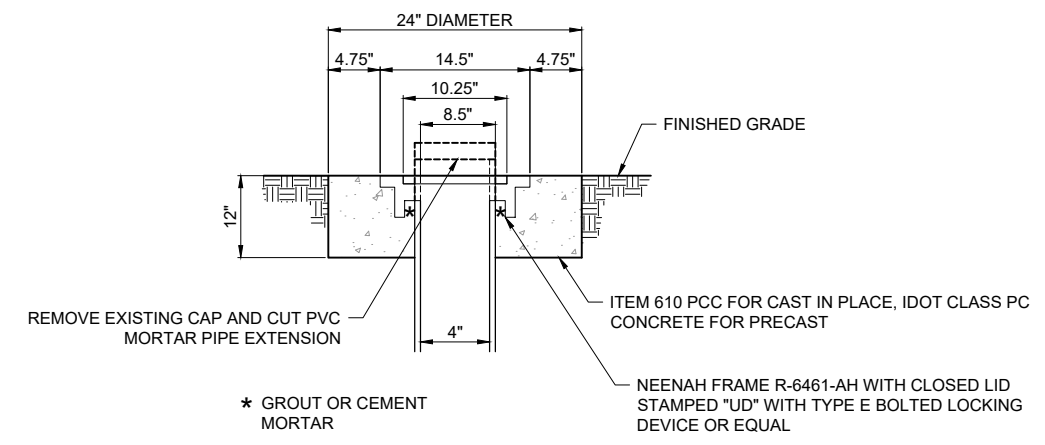
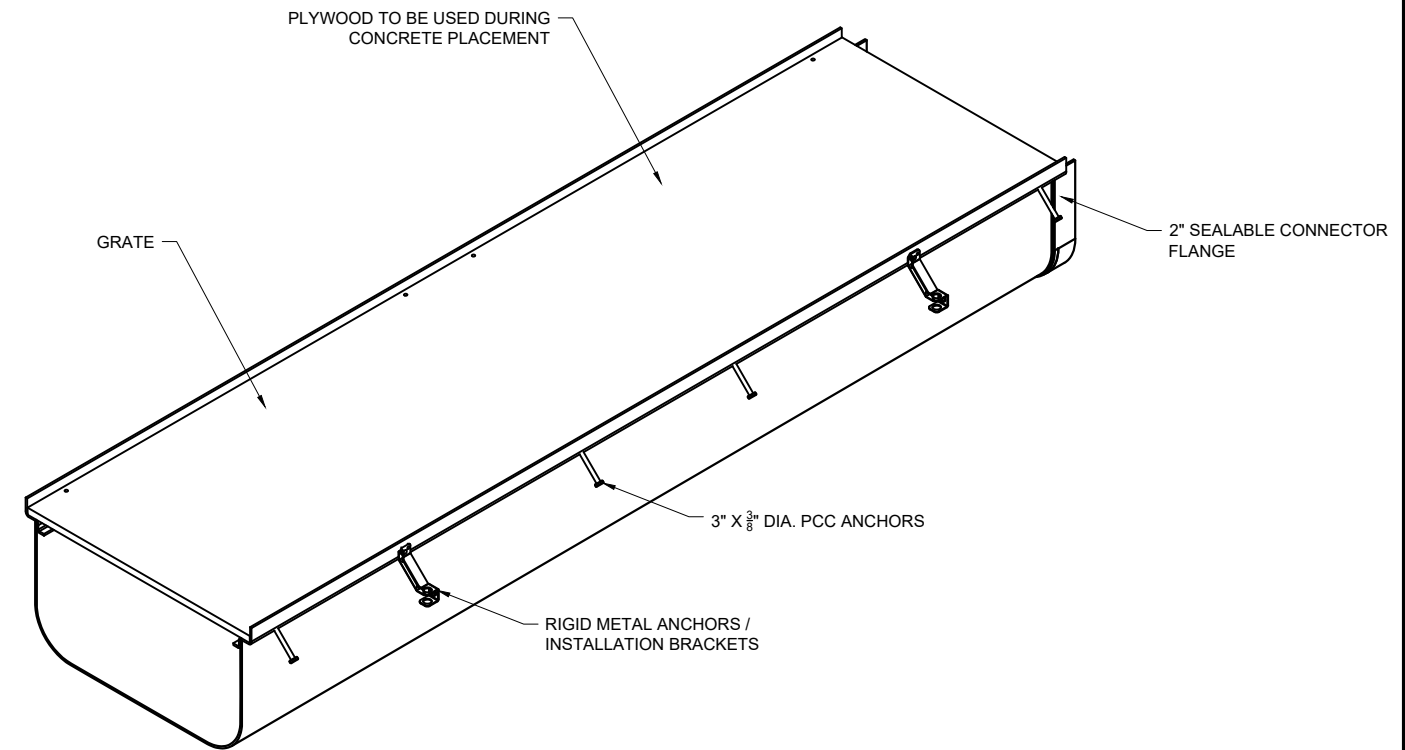

UNDERDRAIN ADJUSTMENT DETAIL
NOT TO SCALE

PIPE SCHEDULE								
STRUCTURE	STA.	OFFSET	TYPE	RIM ELEVATION (FT)	INVERT ELEVATION (FT)	PIPE PAY LENGTH (FT)	SIZE (IN)	SLOPE (%)
TRENCH DRAIN (AR751001)	3+42.84	83.44' RT	TRENCH DRAIN	470.12	469.87	16	24	0.50
	3+26.84	83.29 RT	TRENCH DRAIN	470.12	469.79			
	3+25.34	83.29 RT	PVC		469.76	1.5'	3	2.0
HDPE CULVERT (AR800925)	0+61.30	19.13 RT	HDPE		467.00	50	16	
	0+11.35	21.35 RT	HDPE		465.90			2.2

*PVC PIPE INCIDENTAL TO TRENCH DRAIN

FOR BID